

WHITE BAY POWER STATION

Ground Floor



28 Robert Street, Rozelle
NSW 2039

Monday Closed
Tuesday 11 am-6 pm
Wednesday 11 am-9 pm
Thursday 11 am-6 pm
Friday 11 am-6 pm
Saturday 11 am-6 pm
Sunday 11 am-6 pm

White Bay Power Station was constructed between 1912 and 1917 to power the rail network and is now over 100 years old, having been decommissioned in 1984. The power station is exceptionally significant as the only one retaining machinery and equipment from before the 1950s, demonstrating the process of electricity production and its use throughout Sydney's extensive rail network.

White Bay Power Station is wheelchair accessible. There is no parking available at White Bay Power Station. We encourage visitors to catch public transport. The site is on bus route 441/442.

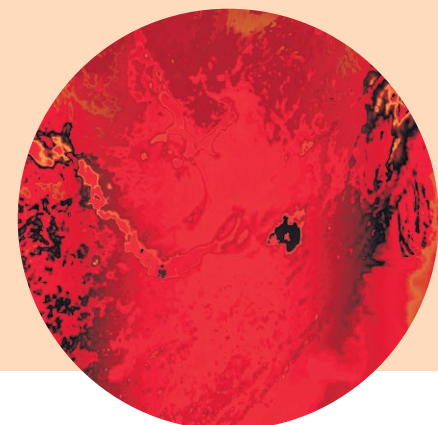
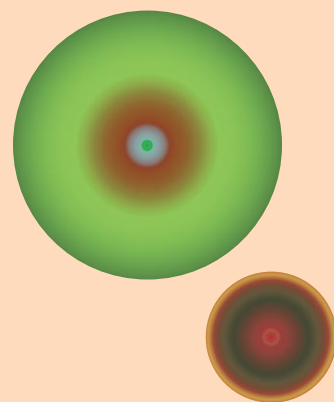

First Floor

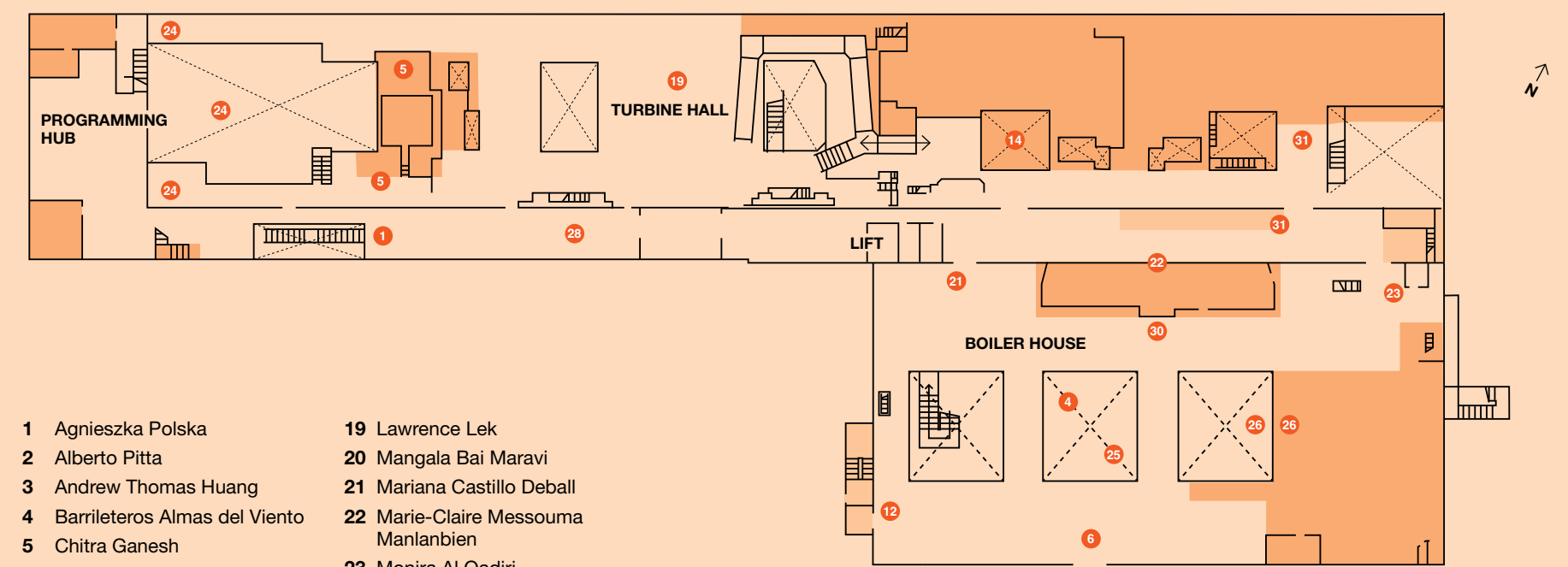

- | | |
|---------------------------------|--|
| 1 Agnieszka Polska | 19 Lawrence Lek |
| 2 Alberto Pitta | 20 Mangala Bai Maravi |
| 3 Andrew Thomas Huang | 21 Mariana Castillo Deball |
| 4 Barrileteros Almas del Viento | 22 Marie-Claire Messouma Manlanbien |
| 5 Chitra Ganesh | 23 Monira Al Qadiri |
| 6 Christopher Myers | 24 Nikau Hindin, Ebonie Fifita-Laufilitoga-Maka, Hina Puamohala Kneubuhl, Hinatea Colombani, Kesaia Biuvanua, Rongomal Grbic-Hoskins |
| 7 Cristina Flores Pescorán | 25 Orquídeas Barrileteras |
| 8 Darrell Sibosado | 26 Özgür Kar |
| 9 Doreen Chapman | 27 Peter Minshall |
| 10 Dr. Destiny Deacon | 28 Petrit Halilaj & Álvaro Urbano |
| 11 Dumb Type | 29 Satch Hoyt |
| 12 Dylan Mooney | 30 Trevor Yeung |
| 13 El Gran Mono | 31 VNS Matrix |
| 14 Eric-Paul Riege | 32 William Yang |
| 15 Felix de Rooy | |
| 16 Joel Sherwood Spring | |
| 17 Josh Kline | |
| 18 Kaylene Whiskey | |

- Restricted access to these areas within the Turbine Hall and Boiler House
- No access to these areas on site

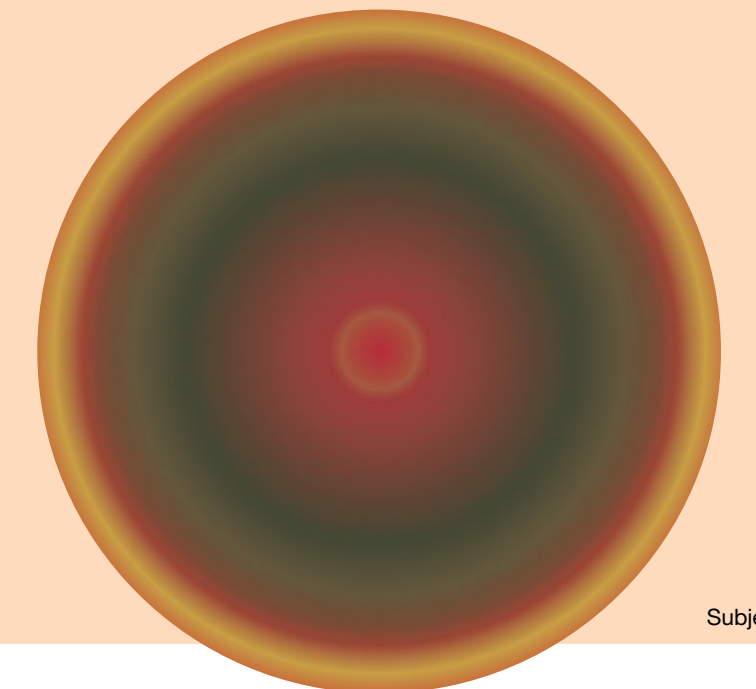

Subject to change