

LEVEL 3

Lot No
30307

LOCATION PLAN
CHARLTON HOUSE

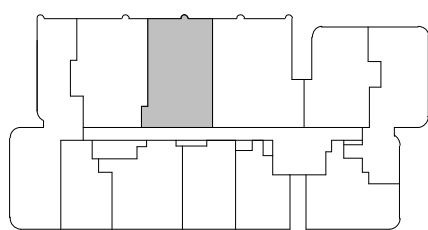

TWO BEDROOM + MEDIA
APARTMENT

Internal Area 101 m²
Balcony Area 35 m²
Total Area 136 m²

Areas subject to change in accordance with the provisions of the contract. Area includes balcony and/or terrace where applicable. It excludes associated parking and external storage areas.

Legend - As Applicable

- ▲ Access
- △ Balcony Access
- ▨ Planting maintained by Body Corporate
- * Fixed Screen
- ** Sliding Screen
- K King Bed
- Q Queen Bed
- F Fridge
- P Pantry
- O Wall Oven
- EC Electrical / Communications
- J Joinery
- L Linen
- St Storage
- #1 Lighting upgrade available
- #2 Lighting upgrade available

Provision of a water point & power point has been made available to balcony.

Important Note: This floor plan was produced prior to construction and while the information contained herein is believed to be correct it is not guaranteed. Changes may be made in accordance with the contract for sale. The plan does not show additional features such as hot water systems, services or Bulkheads necessary for services. Dimensions, areas and scale of floor plans are approximate only and subject to the terms of the Contract. The furniture and furnishings depicted are not included with any sale. Purchasers must refer to the contract for sale for the list of inclusions. Purchaser options may or may not be noted on floor plans and are available at purchaser cost only at time of sale. Furnishings should not be taken to indicate the final position of power points, TV connection points and the like. All graphics, including design and extent of tile/paver/carpet areas, landscaping, balustrades, louvres, sun shading devices, fencing, screens and services equipment are for illustrative purposes only and are not to be relied on as a representative of the final product. Plans do not show additional features within each lot such as letterboxes and side and rear retaining walls. All level changes in the courtyards may not have been shown.

04/02/2022 [A]



CHARLTON HOUSE

AT ASCOT GREEN

