



# HARBOURSIDE

RESIDENCES

VIEWS







# Level 6

North  
West  
View

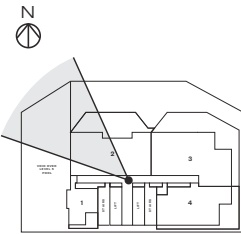

North  
View

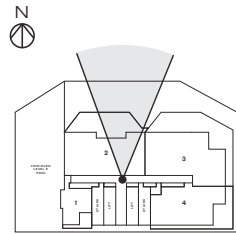

North  
East  
View

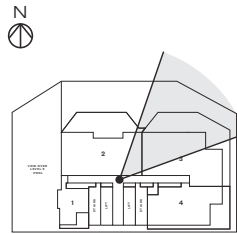

East  
View

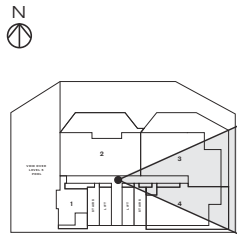

South  
East  
View

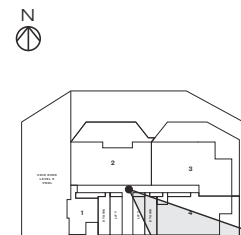

South  
View

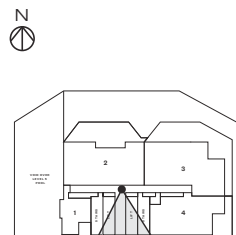

South  
West  
View

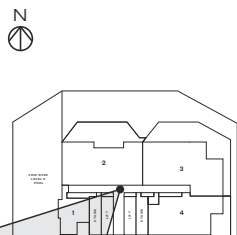

View photography is correct as of July 2024 and was taken approximately from the centre of the building at varying heights. Views depicted are intended as a guide only, representative of the existing general views from the camera position and are subject to change. Floor plans are indicative only and subject to development approval. The views are not to be relied on as representative of the views available from a proposed lot, floor level or the final actual view. Purchasers should make their own enquiries in this regard. Any future development which may impact on views is not within Mirvac's control. Purchasers should make their own enquiries as to the extent and possibility of any future development which may impact on views.

View photography is correct as of July 2024 and was taken approximately from the centre of the building at varying heights. Views depicted are intended as a guide only, representative of the existing general views from the camera position and are subject to change. Floor plans are indicative only and subject to development approval. The views are not to be relied on as representative of the views available from a proposed lot, floor level or the final actual view. Purchasers should make their own enquiries in this regard. Any future development which may impact on views is not within Mirvac's control. Purchasers should make their own enquiries as to the extent and possibility of any future development which may impact on views.



# Level 7

North  
West  
View

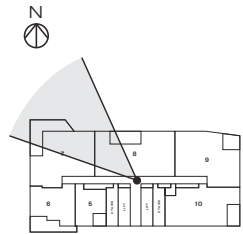

North  
View

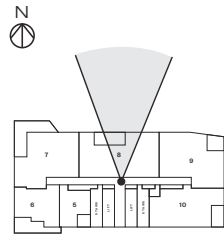

North  
East  
View

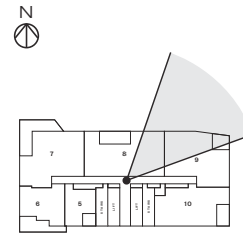

East  
View

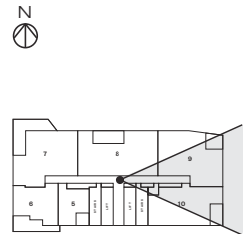

South  
East  
View

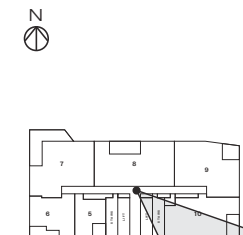

South  
View

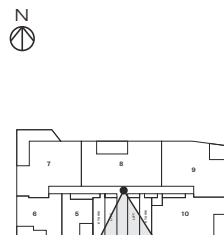

South  
West  
View

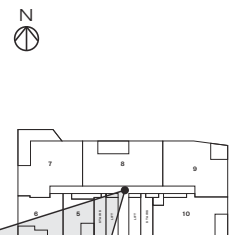

West  
View

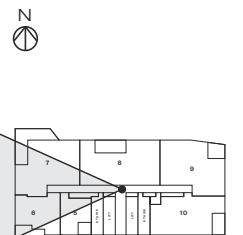

View photography is correct as of July 2024 and was taken approximately from the centre of the building at varying heights. Views depicted are intended as a guide only, representative of the existing general views from the camera position and are subject to change. Floor plans are indicative only and subject to development approval. The views are not to be relied on as representative of the views available from a proposed lot, floor level or the final actual view. Purchasers should make their own enquiries in this regard. Any future development which may impact on views is not within Mirvac's control. Purchasers should make their own enquiries as to the extent and possibility of any future development which may impact on views.

View photography is correct as of July 2024 and was taken approximately from the centre of the building at varying heights. Views depicted are intended as a guide only, representative of the existing general views from the camera position and are subject to change. Floor plans are indicative only and subject to development approval. The views are not to be relied on as representative of the views available from a proposed lot, floor level or the final actual view. Purchasers should make their own enquiries in this regard. Any future development which may impact on views is not within Mirvac's control. Purchasers should make their own enquiries as to the extent and possibility of any future development which may impact on views.



# Level 8

North  
West  
View

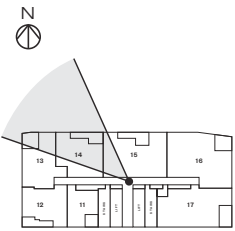

North  
View

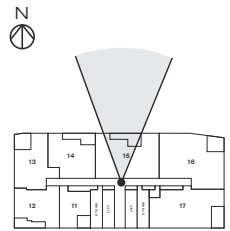

North  
East  
View

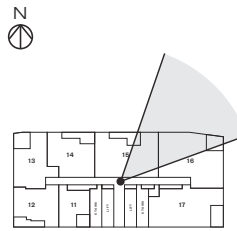

East  
View

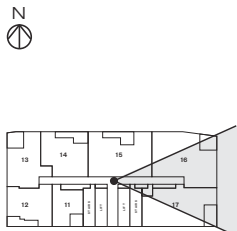

South  
East  
View

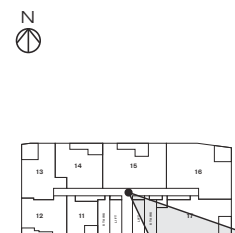

South  
View

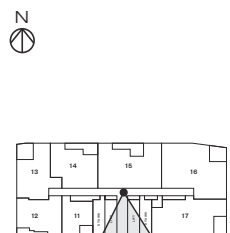

South  
West  
View

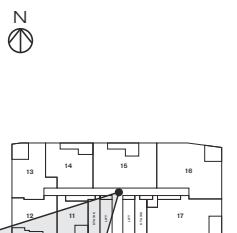

West  
View

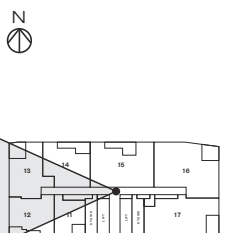

View photography is correct as of July 2024 and was taken approximately from the centre of the building at varying heights. Views depicted are intended as a guide only, representative of the existing general views from the camera position and are subject to change. Floor plans are indicative only and subject to development approval. The views are not to be relied on as representative of the views available from a proposed lot, floor level or the final actual view. Purchasers should make their own enquiries in this regard. Any future development which may impact on views is not within Mirvac's control. Purchasers should make their own enquiries as to the extent and possibility of any future development which may impact on views.

View photography is correct as of July 2024 and was taken approximately from the centre of the building at varying heights. Views depicted are intended as a guide only, representative of the existing general views from the camera position and are subject to change. Floor plans are indicative only and subject to development approval. The views are not to be relied on as representative of the views available from a proposed lot, floor level or the final actual view. Purchasers should make their own enquiries in this regard. Any future development which may impact on views is not within Mirvac's control. Purchasers should make their own enquiries as to the extent and possibility of any future development which may impact on views.



# Level 9

North  
West  
View

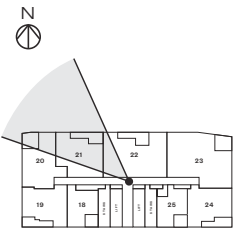

North  
View

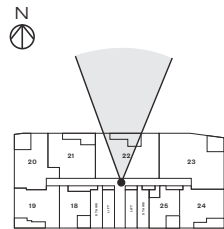

North  
East  
View

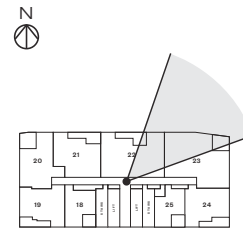

East  
View

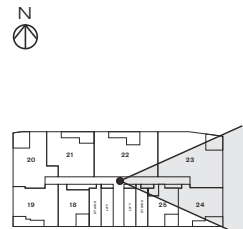

South  
East  
View

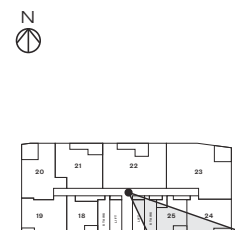

South  
View

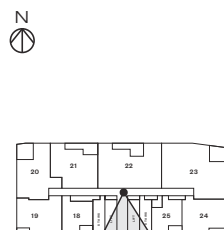

South  
West  
View

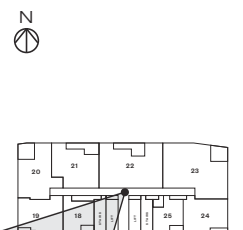

West  
View

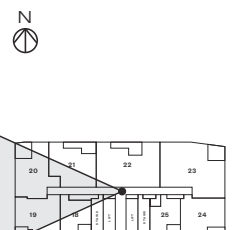

View photography is correct as of July 2024 and was taken approximately from the centre of the building at varying heights. Views depicted are intended as a guide only, representative of the existing general views from the camera position and are subject to change. Floor plans are indicative only and subject to development approval. The views are not to be relied on as representative of the views available from a proposed lot, floor level or the final actual view. Purchasers should make their own enquiries in this regard. Any future development which may impact on views is not within Mirvac's control. Purchasers should make their own enquiries as to the extent and possibility of any future development which may impact on views.

View photography is correct as of July 2024 and was taken approximately from the centre of the building at varying heights. Views depicted are intended as a guide only, representative of the existing general views from the camera position and are subject to change. Floor plans are indicative only and subject to development approval. The views are not to be relied on as representative of the views available from a proposed lot, floor level or the final actual view. Purchasers should make their own enquiries in this regard. Any future development which may impact on views is not within Mirvac's control. Purchasers should make their own enquiries as to the extent and possibility of any future development which may impact on views.



# Level 10

North  
West  
View

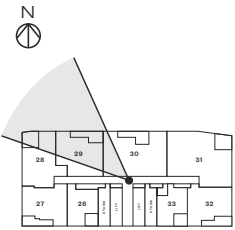

North  
View

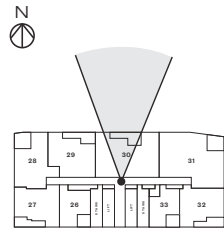

North  
East  
View

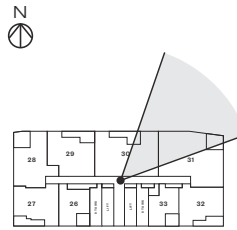

East  
View

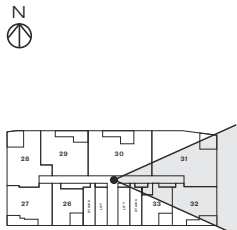

South  
East  
View

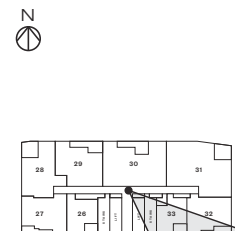

South  
View

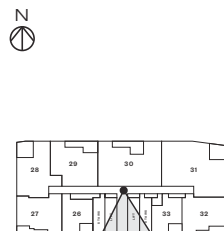

South  
West  
View

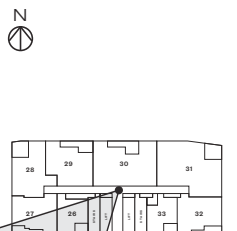

West  
View

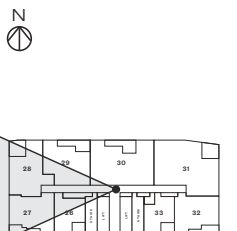

View photography is correct as of July 2024 and was taken approximately from the centre of the building at varying heights. Views depicted are intended as a guide only, representative of the existing general views from the camera position and are subject to change. Floor plans are indicative only and subject to development approval. The views are not to be relied on as representative of the views available from a proposed lot, floor level or the final actual view. Purchasers should make their own enquiries in this regard. Any future development which may impact on views is not within Mirvac's control. Purchasers should make their own enquiries as to the extent and possibility of any future development which may impact on views.

View photography is correct as of July 2024 and was taken approximately from the centre of the building at varying heights. Views depicted are intended as a guide only, representative of the existing general views from the camera position and are subject to change. Floor plans are indicative only and subject to development approval. The views are not to be relied on as representative of the views available from a proposed lot, floor level or the final actual view. Purchasers should make their own enquiries in this regard. Any future development which may impact on views is not within Mirvac's control. Purchasers should make their own enquiries as to the extent and possibility of any future development which may impact on views.



# Level 11

North  
West  
View

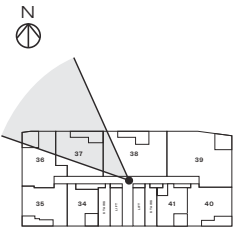

North  
View

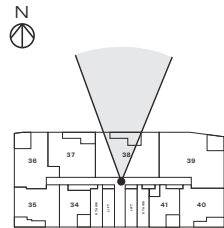

North  
East  
View

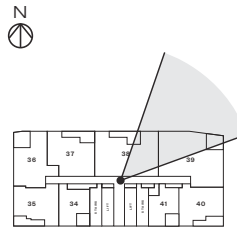

East  
View

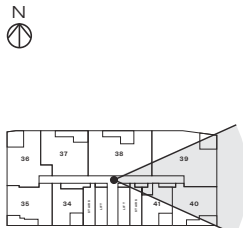

South  
East  
View

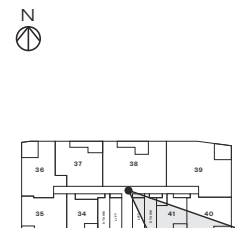

South  
View

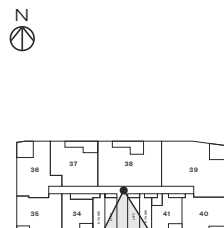

South  
West  
View

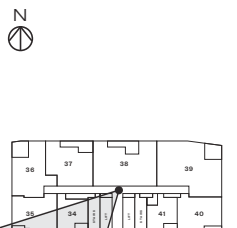

West  
View



View photography is correct as of July 2024 and was taken approximately from the centre of the building at varying heights. Views depicted are intended as a guide only, representative of the existing general views from the camera position and are subject to change. Floor plans are indicative only and subject to development approval. The views are not to be relied on as representative of the views available from a proposed lot, floor level or the final actual view. Purchasers should make their own enquiries in this regard. Any future development which may impact on views is not within Mirvac's control. Purchasers should make their own enquiries as to the extent and possibility of any future development which may impact on views.

View photography is correct as of July 2024 and was taken approximately from the centre of the building at varying heights. Views depicted are intended as a guide only, representative of the existing general views from the camera position and are subject to change. Floor plans are indicative only and subject to development approval. The views are not to be relied on as representative of the views available from a proposed lot, floor level or the final actual view. Purchasers should make their own enquiries in this regard. Any future development which may impact on views is not within Mirvac's control. Purchasers should make their own enquiries as to the extent and possibility of any future development which may impact on views.



# Level 12

North  
West  
View

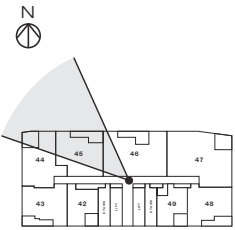

North  
View

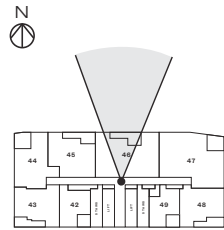

North  
East  
View

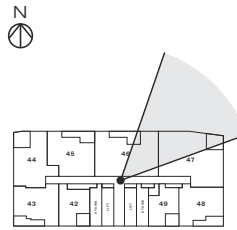

East  
View

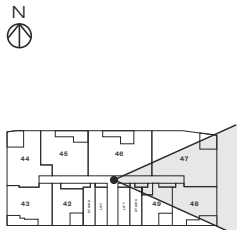

South  
East  
View

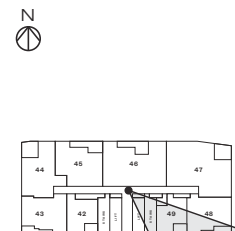

South  
View

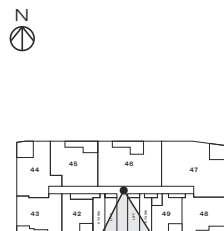

South  
West  
View

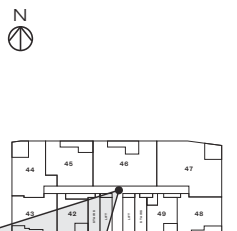

West  
View

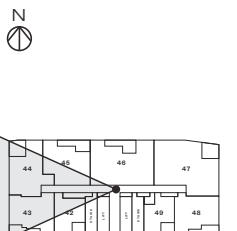

View photography is correct as of July 2024 and was taken approximately from the centre of the building at varying heights. Views depicted are intended as a guide only, representative of the existing general views from the camera position and are subject to change. Floor plans are indicative only and subject to development approval. The views are not to be relied on as representative of the views available from a proposed lot, floor level or the final actual view. Purchasers should make their own enquiries in this regard. Any future development which may impact on views is not within Mirvac's control. Purchasers should make their own enquiries as to the extent and possibility of any future development which may impact on views.

View photography is correct as of July 2024 and was taken approximately from the centre of the building at varying heights. Views depicted are intended as a guide only, representative of the existing general views from the camera position and are subject to change. Floor plans are indicative only and subject to development approval. The views are not to be relied on as representative of the views available from a proposed lot, floor level or the final actual view. Purchasers should make their own enquiries in this regard. Any future development which may impact on views is not within Mirvac's control. Purchasers should make their own enquiries as to the extent and possibility of any future development which may impact on views.



# Level 13

North  
West  
View

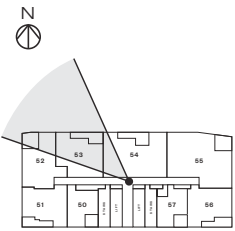

North  
View

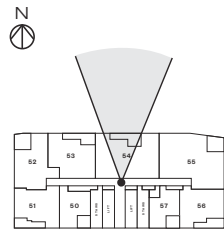

North  
East  
View

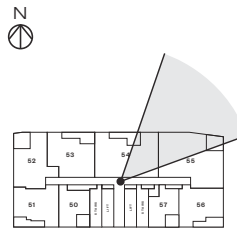

East  
View

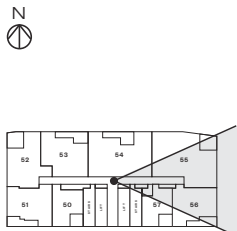

South  
East  
View

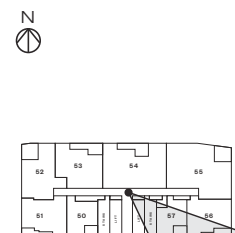

South  
View

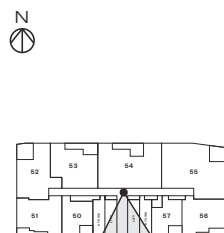

South  
West  
View

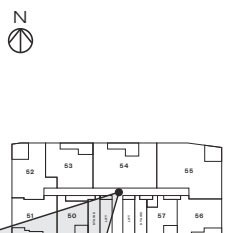

West  
View

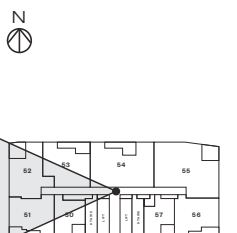

View photography is correct as of July 2024 and was taken approximately from the centre of the building at varying heights. Views depicted are intended as a guide only, representative of the existing general views from the camera position and are subject to change. Floor plans are indicative only and subject to development approval. The views are not to be relied on as representative of the views available from a proposed lot, floor level or the final actual view. Purchasers should make their own enquiries in this regard. Any future development which may impact on views is not within Mirvac's control. Purchasers should make their own enquiries as to the extent and possibility of any future development which may impact on views.

View photography is correct as of July 2024 and was taken approximately from the centre of the building at varying heights. Views depicted are intended as a guide only, representative of the existing general views from the camera position and are subject to change. Floor plans are indicative only and subject to development approval. The views are not to be relied on as representative of the views available from a proposed lot, floor level or the final actual view. Purchasers should make their own enquiries in this regard. Any future development which may impact on views is not within Mirvac's control. Purchasers should make their own enquiries as to the extent and possibility of any future development which may impact on views.



# Level 14

North  
West  
View

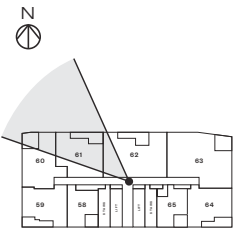

North  
View

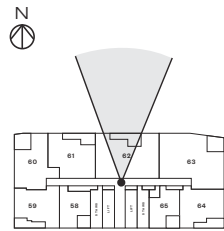

North  
East  
View

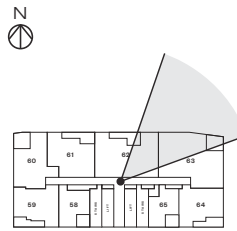

East  
View

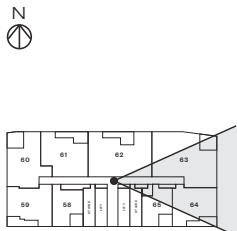

South  
East  
View

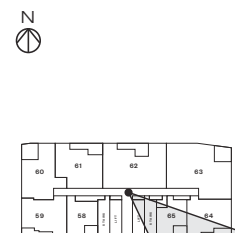

South  
View

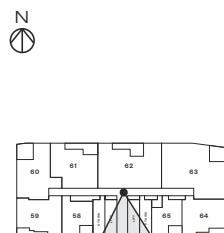

South  
West  
View

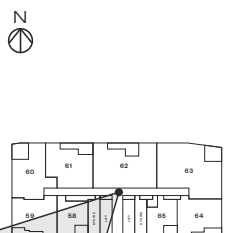

West  
View

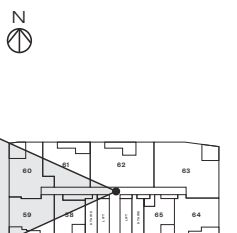

View photography is correct as of July 2024 and was taken approximately from the centre of the building at varying heights. Views depicted are intended as a guide only, representative of the existing general views from the camera position and are subject to change. Floor plans are indicative only and subject to development approval. The views are not to be relied on as representative of the views available from a proposed lot, floor level or the final actual view. Purchasers should make their own enquiries in this regard. Any future development which may impact on views is not within Mirvac's control. Purchasers should make their own enquiries as to the extent and possibility of any future development which may impact on views.

View photography is correct as of July 2024 and was taken approximately from the centre of the building at varying heights. Views depicted are intended as a guide only, representative of the existing general views from the camera position and are subject to change. Floor plans are indicative only and subject to development approval. The views are not to be relied on as representative of the views available from a proposed lot, floor level or the final actual view. Purchasers should make their own enquiries in this regard. Any future development which may impact on views is not within Mirvac's control. Purchasers should make their own enquiries as to the extent and possibility of any future development which may impact on views.



# Level 15

North  
West  
View

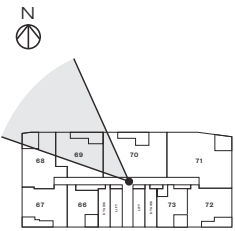

North  
View

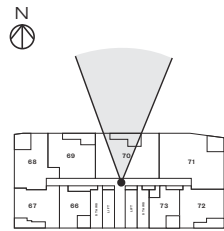

North  
East  
View

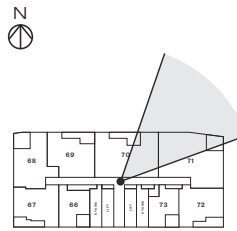

East  
View

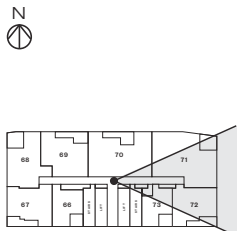

South  
East  
View

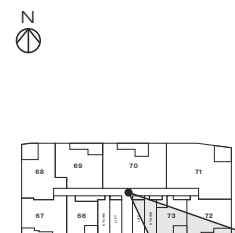

South  
View

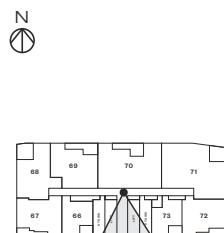

South  
West  
View

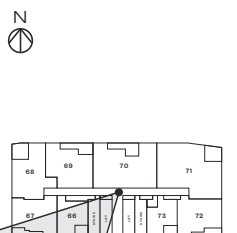

West  
View

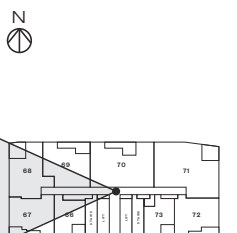

View photography is correct as of July 2024 and was taken approximately from the centre of the building at varying heights. Views depicted are intended as a guide only, representative of the existing general views from the camera position and are subject to change. Floor plans are indicative only and subject to development approval. The views are not to be relied on as representative of the views available from a proposed lot, floor level or the final actual view. Purchasers should make their own enquiries in this regard. Any future development which may impact on views is not within Mirvac's control. Purchasers should make their own enquiries as to the extent and possibility of any future development which may impact on views.

View photography is correct as of July 2024 and was taken approximately from the centre of the building at varying heights. Views depicted are intended as a guide only, representative of the existing general views from the camera position and are subject to change. Floor plans are indicative only and subject to development approval. The views are not to be relied on as representative of the views available from a proposed lot, floor level or the final actual view. Purchasers should make their own enquiries in this regard. Any future development which may impact on views is not within Mirvac's control. Purchasers should make their own enquiries as to the extent and possibility of any future development which may impact on views.



# Level 16

North  
West  
View

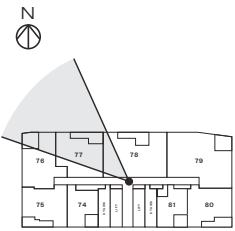

North  
View

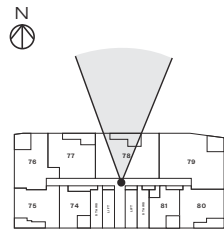

North  
East  
View

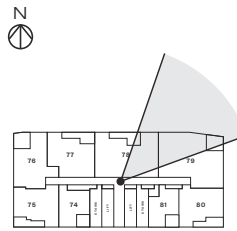

East  
View

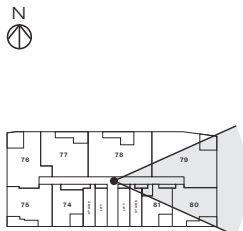

South  
East  
View

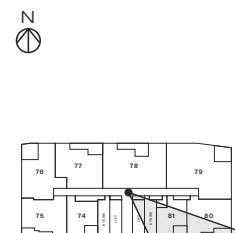

South  
View

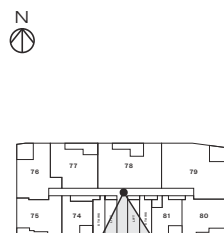

South  
West  
View

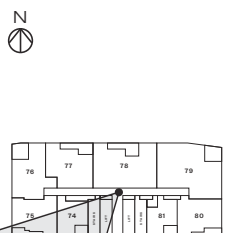

West  
View

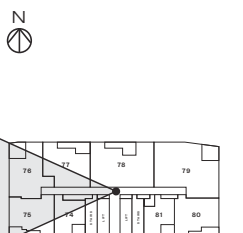

View photography is correct as of July 2024 and was taken approximately from the centre of the building at varying heights. Views depicted are intended as a guide only, representative of the existing general views from the camera position and are subject to change. Floor plans are indicative only and subject to development approval. The views are not to be relied on as representative of the views available from a proposed lot, floor level or the final actual view. Purchasers should make their own enquiries in this regard. Any future development which may impact on views is not within Mirvac's control. Purchasers should make their own enquiries as to the extent and possibility of any future development which may impact on views.

View photography is correct as of July 2024 and was taken approximately from the centre of the building at varying heights. Views depicted are intended as a guide only, representative of the existing general views from the camera position and are subject to change. Floor plans are indicative only and subject to development approval. The views are not to be relied on as representative of the views available from a proposed lot, floor level or the final actual view. Purchasers should make their own enquiries in this regard. Any future development which may impact on views is not within Mirvac's control. Purchasers should make their own enquiries as to the extent and possibility of any future development which may impact on views.



# Level 17

North  
West  
View

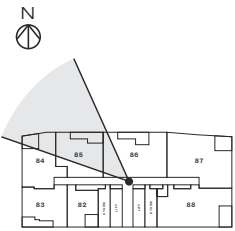

North  
View

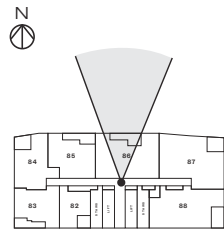

North  
East  
View

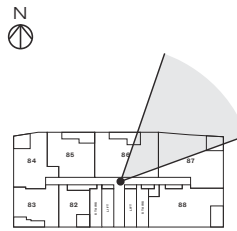

East  
View

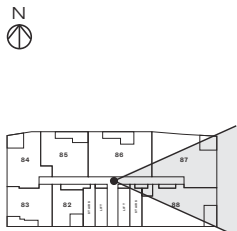

South  
East  
View

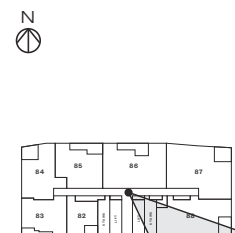

South  
View

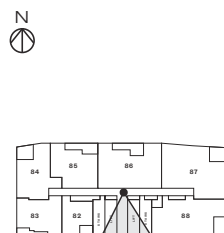

South  
West  
View

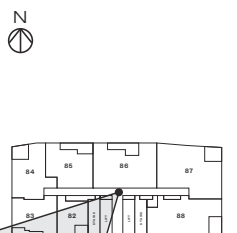

West  
View

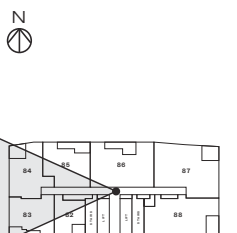

View photography is correct as of July 2024 and was taken approximately from the centre of the building at varying heights. Views depicted are intended as a guide only, representative of the existing general views from the camera position and are subject to change. Floor plans are indicative only and subject to development approval. The views are not to be relied on as representative of the views available from a proposed lot, floor level or the final actual view. Purchasers should make their own enquiries in this regard. Any future development which may impact on views is not within Mirvac's control. Purchasers should make their own enquiries as to the extent and possibility of any future development which may impact on views.

View photography is correct as of July 2024 and was taken approximately from the centre of the building at varying heights. Views depicted are intended as a guide only, representative of the existing general views from the camera position and are subject to change. Floor plans are indicative only and subject to development approval. The views are not to be relied on as representative of the views available from a proposed lot, floor level or the final actual view. Purchasers should make their own enquiries in this regard. Any future development which may impact on views is not within Mirvac's control. Purchasers should make their own enquiries as to the extent and possibility of any future development which may impact on views.



# Level 18

North  
West  
View

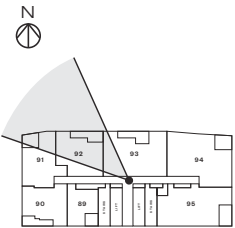

North  
View

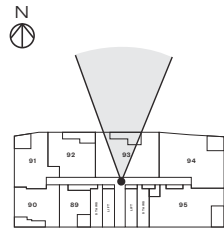

North  
East  
View

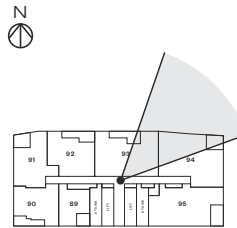

East  
View

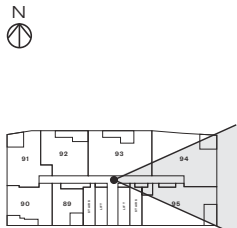

South  
East  
View

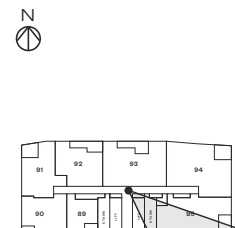

South  
View

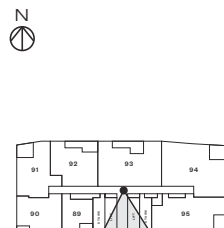

South  
West  
View

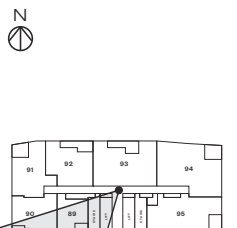

West  
View

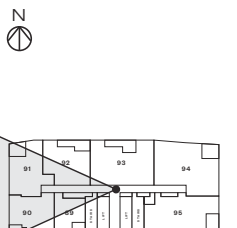

View photography is correct as of July 2024 and was taken approximately from the centre of the building at varying heights. Views depicted are intended as a guide only, representative of the existing general views from the camera position and are subject to change. Floor plans are indicative only and subject to development approval. The views are not to be relied on as representative of the views available from a proposed lot, floor level or the final actual view. Purchasers should make their own enquiries in this regard. Any future development which may impact on views is not within Mirvac's control. Purchasers should make their own enquiries as to the extent and possibility of any future development which may impact on views.

View photography is correct as of July 2024 and was taken approximately from the centre of the building at varying heights. Views depicted are intended as a guide only, representative of the existing general views from the camera position and are subject to change. Floor plans are indicative only and subject to development approval. The views are not to be relied on as representative of the views available from a proposed lot, floor level or the final actual view. Purchasers should make their own enquiries in this regard. Any future development which may impact on views is not within Mirvac's control. Purchasers should make their own enquiries as to the extent and possibility of any future development which may impact on views.



# Level 19

North  
West  
View

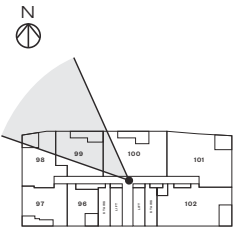

North  
View

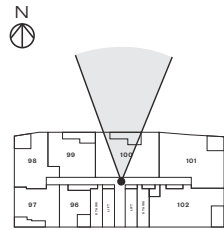

North  
East  
View

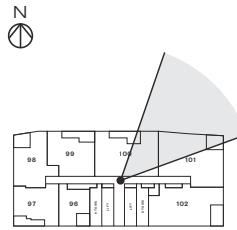

East  
View

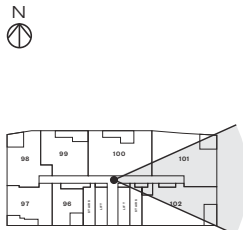

South  
East  
View

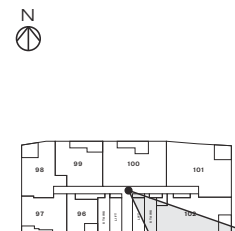

South  
View

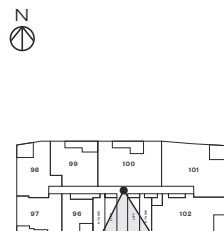

South  
West  
View

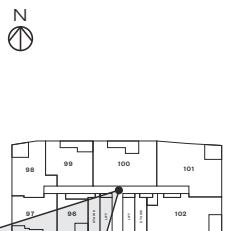

West  
View

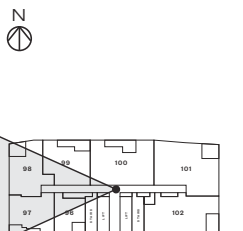

View photography is correct as of July 2024 and was taken approximately from the centre of the building at varying heights. Views depicted are intended as a guide only, representative of the existing general views from the camera position and are subject to change. Floor plans are indicative only and subject to development approval. The views are not to be relied on as representative of the views available from a proposed lot, floor level or the final actual view. Purchasers should make their own enquiries in this regard. Any future development which may impact on views is not within Mirvac's control. Purchasers should make their own enquiries as to the extent and possibility of any future development which may impact on views.

View photography is correct as of July 2024 and was taken approximately from the centre of the building at varying heights. Views depicted are intended as a guide only, representative of the existing general views from the camera position and are subject to change. Floor plans are indicative only and subject to development approval. The views are not to be relied on as representative of the views available from a proposed lot, floor level or the final actual view. Purchasers should make their own enquiries in this regard. Any future development which may impact on views is not within Mirvac's control. Purchasers should make their own enquiries as to the extent and possibility of any future development which may impact on views.



# Level 20

North  
West  
View

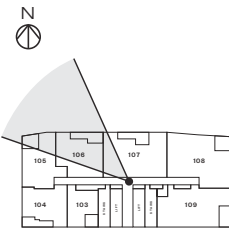

North  
View

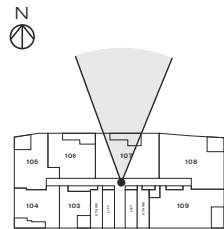

North  
East  
View

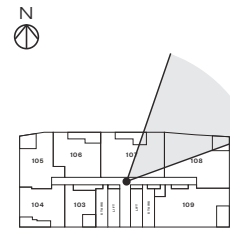

East  
View

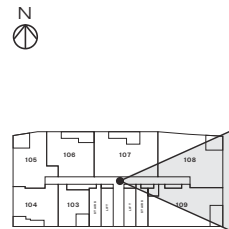

South  
East  
View

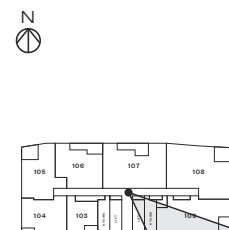

South  
View

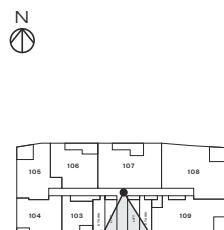

South  
West  
View

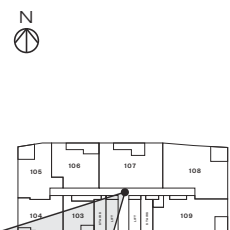

West  
View

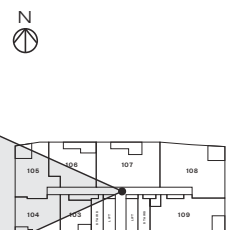

View photography is correct as of July 2024 and was taken approximately from the centre of the building at varying heights. Views depicted are intended as a guide only, representative of the existing general views from the camera position and are subject to change. Floor plans are indicative only and subject to development approval. The views are not to be relied on as representative of the views available from a proposed lot, floor level or the final actual view. Purchasers should make their own enquiries in this regard. Any future development which may impact on views is not within Mirvac's control. Purchasers should make their own enquiries as to the extent and possibility of any future development which may impact on views.

View photography is correct as of July 2024 and was taken approximately from the centre of the building at varying heights. Views depicted are intended as a guide only, representative of the existing general views from the camera position and are subject to change. Floor plans are indicative only and subject to development approval. The views are not to be relied on as representative of the views available from a proposed lot, floor level or the final actual view. Purchasers should make their own enquiries in this regard. Any future development which may impact on views is not within Mirvac's control. Purchasers should make their own enquiries as to the extent and possibility of any future development which may impact on views.



# Level 21

North  
West  
View

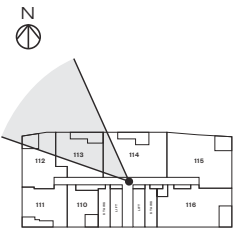

North  
View

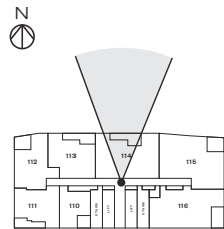

North  
East  
View

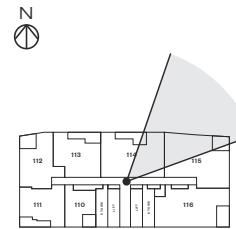

East  
View

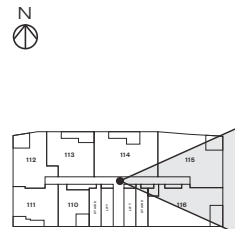

South  
East  
View

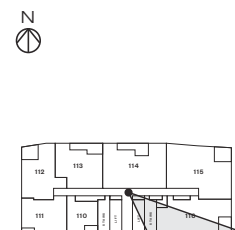

South  
View

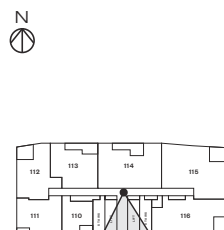

South  
West  
View

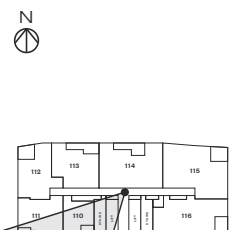

West  
View

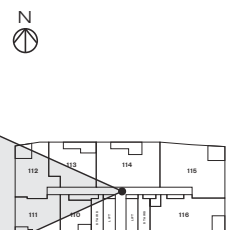

View photography is correct as of July 2024 and was taken approximately from the centre of the building at varying heights. Views depicted are intended as a guide only, representative of the existing general views from the camera position and are subject to change. Floor plans are indicative only and subject to development approval. The views are not to be relied on as representative of the views available from a proposed lot, floor level or the final actual view. Purchasers should make their own enquiries in this regard. Any future development which may impact on views is not within Mirvac's control. Purchasers should make their own enquiries as to the extent and possibility of any future development which may impact on views.

View photography is correct as of July 2024 and was taken approximately from the centre of the building at varying heights. Views depicted are intended as a guide only, representative of the existing general views from the camera position and are subject to change. Floor plans are indicative only and subject to development approval. The views are not to be relied on as representative of the views available from a proposed lot, floor level or the final actual view. Purchasers should make their own enquiries in this regard. Any future development which may impact on views is not within Mirvac's control. Purchasers should make their own enquiries as to the extent and possibility of any future development which may impact on views.



# Level 22

North  
West  
View

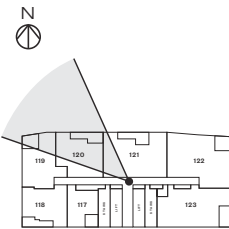

North  
View

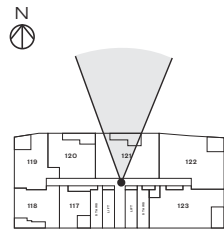

North  
East  
View

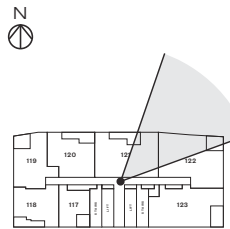

East  
View

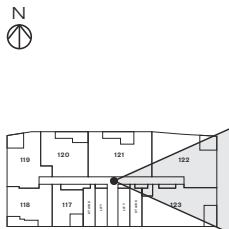

South  
East  
View

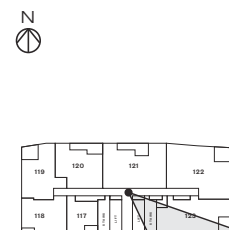

South  
View

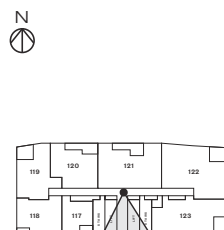

South  
West  
View

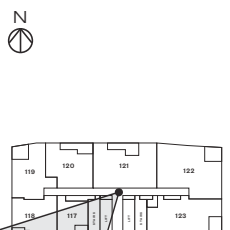

West  
View

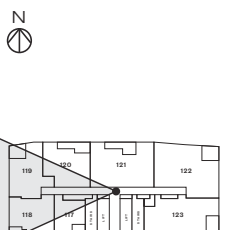

View photography is correct as of July 2024 and was taken approximately from the centre of the building at varying heights. Views depicted are intended as a guide only, representative of the existing general views from the camera position and are subject to change. Floor plans are indicative only and subject to development approval. The views are not to be relied on as representative of the views available from a proposed lot, floor level or the final actual view. Purchasers should make their own enquiries in this regard. Any future development which may impact on views is not within Mirvac's control. Purchasers should make their own enquiries as to the extent and possibility of any future development which may impact on views.

View photography is correct as of July 2024 and was taken approximately from the centre of the building at varying heights. Views depicted are intended as a guide only, representative of the existing general views from the camera position and are subject to change. Floor plans are indicative only and subject to development approval. The views are not to be relied on as representative of the views available from a proposed lot, floor level or the final actual view. Purchasers should make their own enquiries in this regard. Any future development which may impact on views is not within Mirvac's control. Purchasers should make their own enquiries as to the extent and possibility of any future development which may impact on views.



# Level 23

North  
West  
View

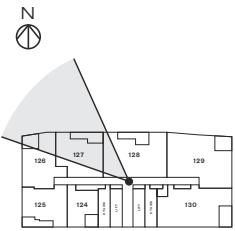

North  
View

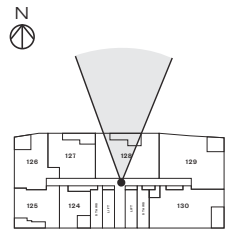

North  
East  
View

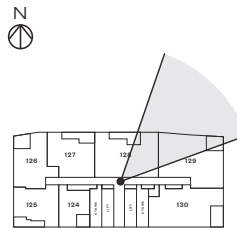

East  
View

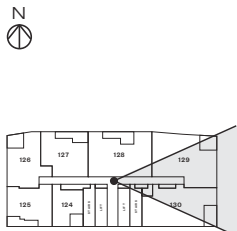

South  
East  
View

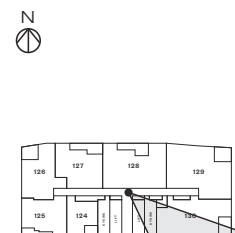

South  
View

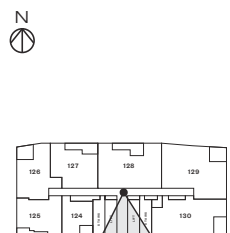

South  
West  
View

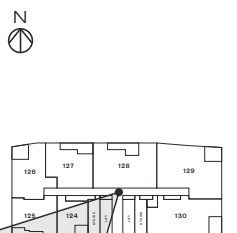

West  
View

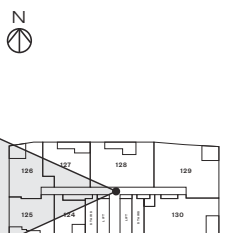

View photography is correct as of July 2024 and was taken approximately from the centre of the building at varying heights. Views depicted are intended as a guide only, representative of the existing general views from the camera position and are subject to change. Floor plans are indicative only and subject to development approval. The views are not to be relied on as representative of the views available from a proposed lot, floor level or the final actual view. Purchasers should make their own enquiries in this regard. Any future development which may impact on views is not within Mirvac's control. Purchasers should make their own enquiries as to the extent and possibility of any future development which may impact on views.

View photography is correct as of July 2024 and was taken approximately from the centre of the building at varying heights. Views depicted are intended as a guide only, representative of the existing general views from the camera position and are subject to change. Floor plans are indicative only and subject to development approval. The views are not to be relied on as representative of the views available from a proposed lot, floor level or the final actual view. Purchasers should make their own enquiries in this regard. Any future development which may impact on views is not within Mirvac's control. Purchasers should make their own enquiries as to the extent and possibility of any future development which may impact on views.



# Level 24

North  
West  
View

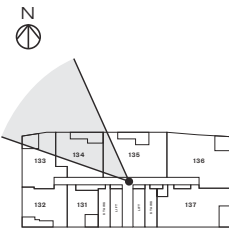

North  
View

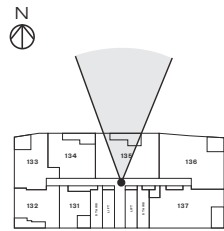

North  
East  
View

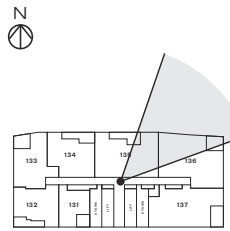

East  
View

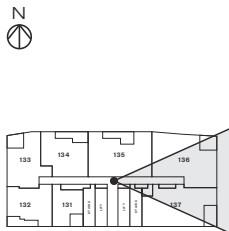

South  
East  
View

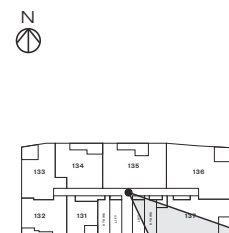

South  
View

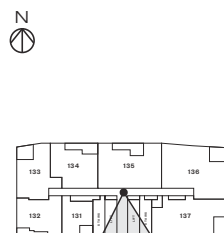

South  
West  
View

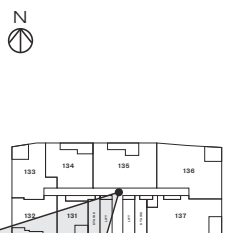

West  
View

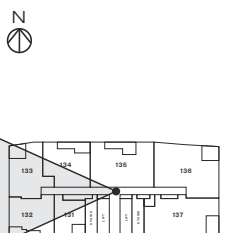

View photography is correct as of July 2024 and was taken approximately from the centre of the building at varying heights. Views depicted are intended as a guide only, representative of the existing general views from the camera position and are subject to change. Floor plans are indicative only and subject to development approval. The views are not to be relied on as representative of the views available from a proposed lot, floor level or the final actual view. Purchasers should make their own enquiries in this regard. Any future development which may impact on views is not within Mirvac's control. Purchasers should make their own enquiries as to the extent and possibility of any future development which may impact on views.

View photography is correct as of July 2024 and was taken approximately from the centre of the building at varying heights. Views depicted are intended as a guide only, representative of the existing general views from the camera position and are subject to change. Floor plans are indicative only and subject to development approval. The views are not to be relied on as representative of the views available from a proposed lot, floor level or the final actual view. Purchasers should make their own enquiries in this regard. Any future development which may impact on views is not within Mirvac's control. Purchasers should make their own enquiries as to the extent and possibility of any future development which may impact on views.



# Level 25

North  
West  
View

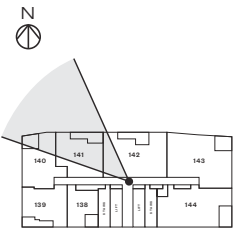

North  
View

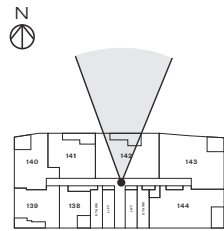

North  
East  
View

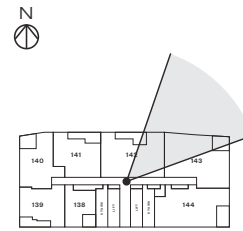

East  
View

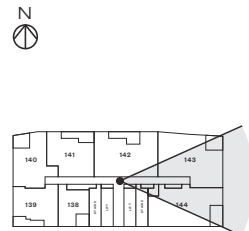

South  
East  
View

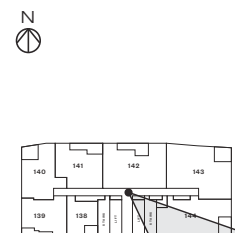

South  
View

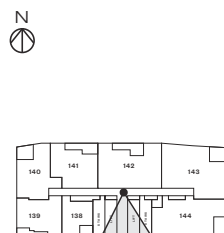

South  
West  
View

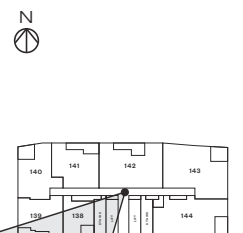

West  
View

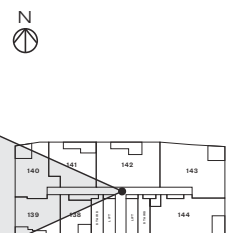

View photography is correct as of July 2024 and was taken approximately from the centre of the building at varying heights. Views depicted are intended as a guide only, representative of the existing general views from the camera position and are subject to change. Floor plans are indicative only and subject to development approval. The views are not to be relied on as representative of the views available from a proposed lot, floor level or the final actual view. Purchasers should make their own enquiries in this regard. Any future development which may impact on views is not within Mirvac's control. Purchasers should make their own enquiries as to the extent and possibility of any future development which may impact on views.

View photography is correct as of July 2024 and was taken approximately from the centre of the building at varying heights. Views depicted are intended as a guide only, representative of the existing general views from the camera position and are subject to change. Floor plans are indicative only and subject to development approval. The views are not to be relied on as representative of the views available from a proposed lot, floor level or the final actual view. Purchasers should make their own enquiries in this regard. Any future development which may impact on views is not within Mirvac's control. Purchasers should make their own enquiries as to the extent and possibility of any future development which may impact on views.



# Level 26

North  
West  
View

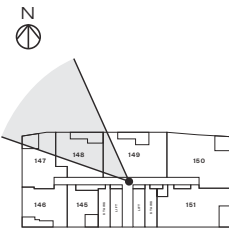

North  
View

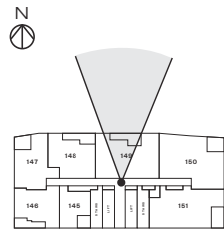

North  
East  
View

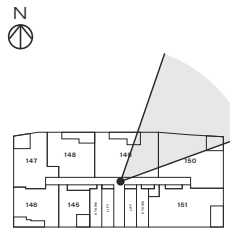

East  
View

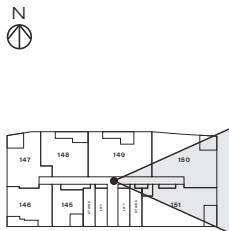

South  
East  
View

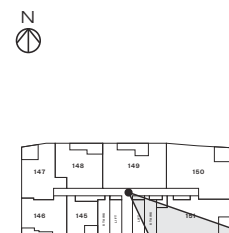

South  
View

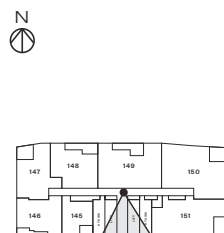

South  
West  
View

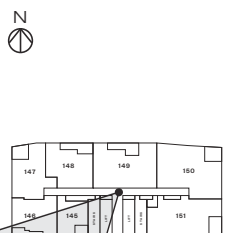

West  
View

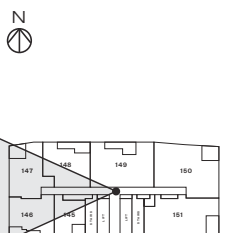

View photography is correct as of July 2024 and was taken approximately from the centre of the building at varying heights. Views depicted are intended as a guide only, representative of the existing general views from the camera position and are subject to change. Floor plans are indicative only and subject to development approval. The views are not to be relied on as representative of the views available from a proposed lot, floor level or the final actual view. Purchasers should make their own enquiries in this regard. Any future development which may impact on views is not within Mirvac's control. Purchasers should make their own enquiries as to the extent and possibility of any future development which may impact on views.

View photography is correct as of July 2024 and was taken approximately from the centre of the building at varying heights. Views depicted are intended as a guide only, representative of the existing general views from the camera position and are subject to change. Floor plans are indicative only and subject to development approval. The views are not to be relied on as representative of the views available from a proposed lot, floor level or the final actual view. Purchasers should make their own enquiries in this regard. Any future development which may impact on views is not within Mirvac's control. Purchasers should make their own enquiries as to the extent and possibility of any future development which may impact on views.



# Level 27

North  
West  
View

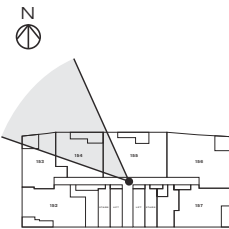

North  
View

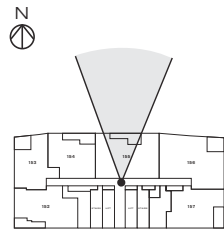

North  
East  
View

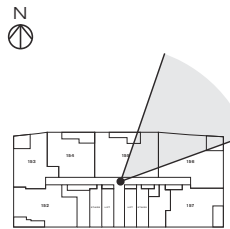

East  
View

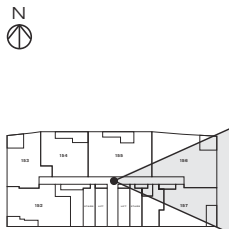

South  
East  
View

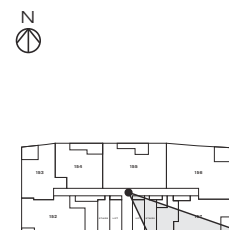

South  
View

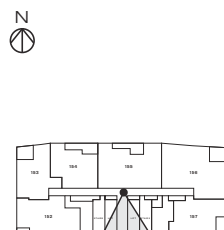

South  
West  
View

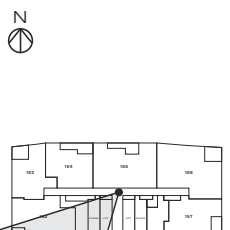

West  
View

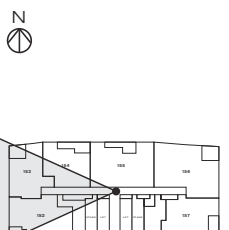

View photography is correct as of July 2024 and was taken approximately from the centre of the building at varying heights. Views depicted are intended as a guide only, representative of the existing general views from the camera position and are subject to change. Floor plans are indicative only and subject to development approval. The views are not to be relied on as representative of the views available from a proposed lot, floor level or the final actual view. Purchasers should make their own enquiries in this regard. Any future development which may impact on views is not within Mirvac's control. Purchasers should make their own enquiries as to the extent and possibility of any future development which may impact on views.

View photography is correct as of July 2024 and was taken approximately from the centre of the building at varying heights. Views depicted are intended as a guide only, representative of the existing general views from the camera position and are subject to change. Floor plans are indicative only and subject to development approval. The views are not to be relied on as representative of the views available from a proposed lot, floor level or the final actual view. Purchasers should make their own enquiries in this regard. Any future development which may impact on views is not within Mirvac's control. Purchasers should make their own enquiries as to the extent and possibility of any future development which may impact on views.



# Level 28

North  
West  
View

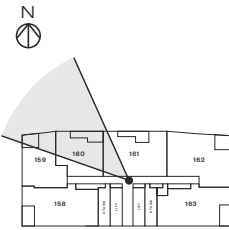

North  
View

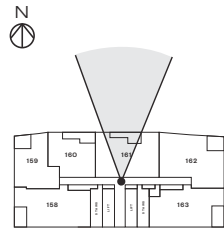

North  
East  
View

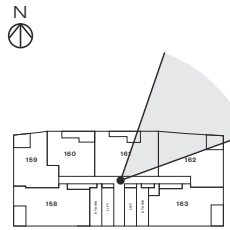

East  
View

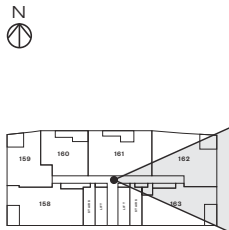

South  
East  
View

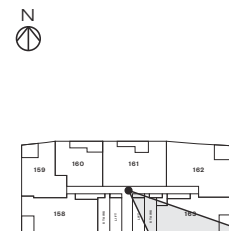

South  
View

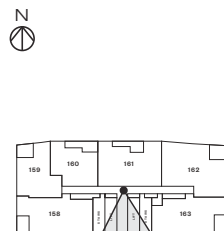

South  
West  
View

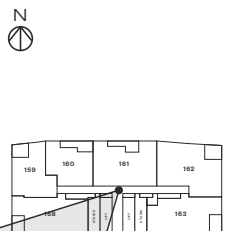

West  
View

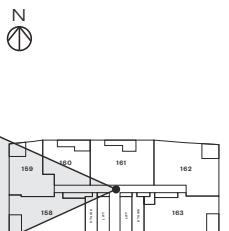

View photography is correct as of July 2024 and was taken approximately from the centre of the building at varying heights. Views depicted are intended as a guide only, representative of the existing general views from the camera position and are subject to change. Floor plans are indicative only and subject to development approval. The views are not to be relied on as representative of the views available from a proposed lot, floor level or the final actual view. Purchasers should make their own enquiries in this regard. Any future development which may impact on views is not within Mirvac's control. Purchasers should make their own enquiries as to the extent and possibility of any future development which may impact on views.

View photography is correct as of July 2024 and was taken approximately from the centre of the building at varying heights. Views depicted are intended as a guide only, representative of the existing general views from the camera position and are subject to change. Floor plans are indicative only and subject to development approval. The views are not to be relied on as representative of the views available from a proposed lot, floor level or the final actual view. Purchasers should make their own enquiries in this regard. Any future development which may impact on views is not within Mirvac's control. Purchasers should make their own enquiries as to the extent and possibility of any future development which may impact on views.



# Level 29

North  
West  
View

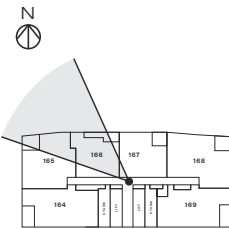

North  
View

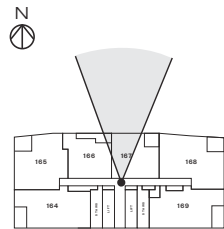

North  
East  
View

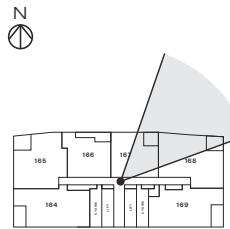

East  
View

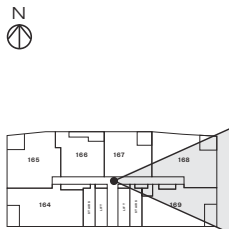

South  
East  
View

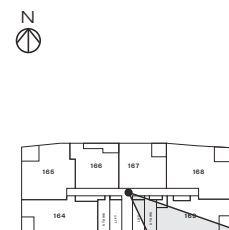

South  
View

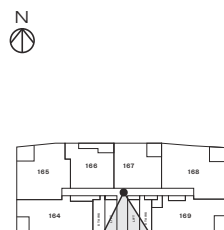

South  
West  
View

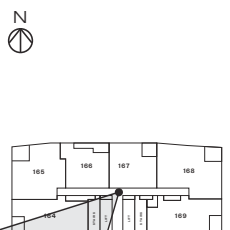

West  
View

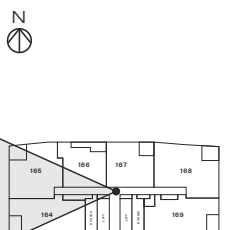

View photography is correct as of July 2024 and was taken approximately from the centre of the building at varying heights. Views depicted are intended as a guide only, representative of the existing general views from the camera position and are subject to change. Floor plans are indicative only and subject to development approval. The views are not to be relied on as representative of the views available from a proposed lot, floor level or the final actual view. Purchasers should make their own enquiries in this regard. Any future development which may impact on views is not within Mirvac's control. Purchasers should make their own enquiries as to the extent and possibility of any future development which may impact on views.

View photography is correct as of July 2024 and was taken approximately from the centre of the building at varying heights. Views depicted are intended as a guide only, representative of the existing general views from the camera position and are subject to change. Floor plans are indicative only and subject to development approval. The views are not to be relied on as representative of the views available from a proposed lot, floor level or the final actual view. Purchasers should make their own enquiries in this regard. Any future development which may impact on views is not within Mirvac's control. Purchasers should make their own enquiries as to the extent and possibility of any future development which may impact on views.



# Level 30

North  
West  
View

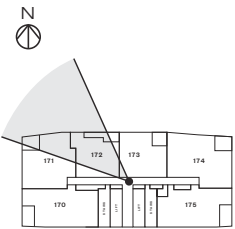

North  
View

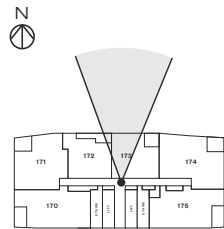

North  
East  
View

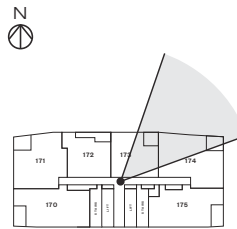

East  
View

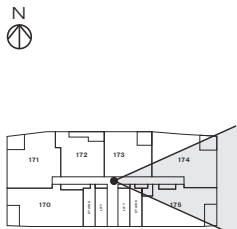

South  
East  
View

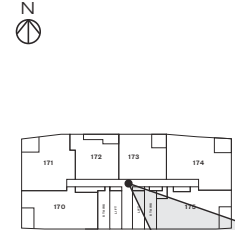

South  
View

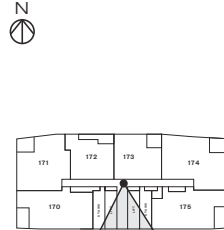

South  
West  
View

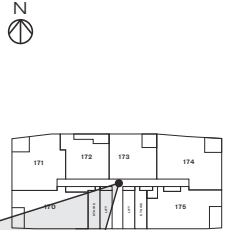

West  
View

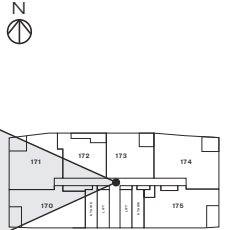

View photography is correct as of July 2024 and was taken approximately from the centre of the building at varying heights. Views depicted are intended as a guide only, representative of the existing general views from the camera position and are subject to change. Floor plans are indicative only and subject to development approval. The views are not to be relied on as representative of the views available from a proposed lot, floor level or the final actual view. Purchasers should make their own enquiries in this regard. Any future development which may impact on views is not within Mirvac's control. Purchasers should make their own enquiries as to the extent and possibility of any future development which may impact on views.

View photography is correct as of July 2024 and was taken approximately from the centre of the building at varying heights. Views depicted are intended as a guide only, representative of the existing general views from the camera position and are subject to change. Floor plans are indicative only and subject to development approval. The views are not to be relied on as representative of the views available from a proposed lot, floor level or the final actual view. Purchasers should make their own enquiries in this regard. Any future development which may impact on views is not within Mirvac's control. Purchasers should make their own enquiries as to the extent and possibility of any future development which may impact on views.



# Level 31

North  
West  
View

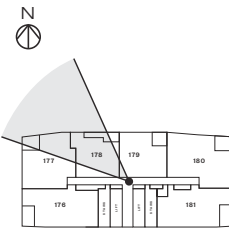

North  
View

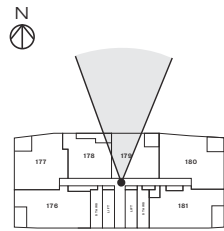

North  
East  
View

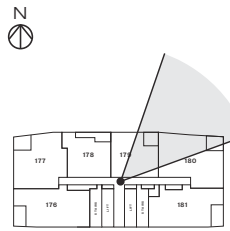

East  
View

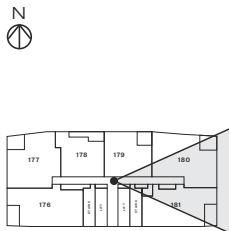

South  
East  
View

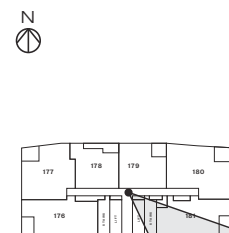

South  
View

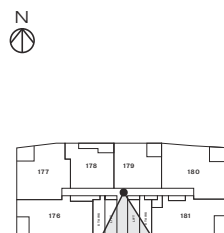

South  
West  
View

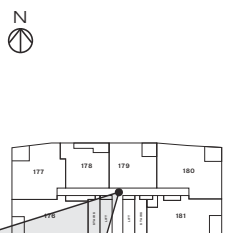

West  
View

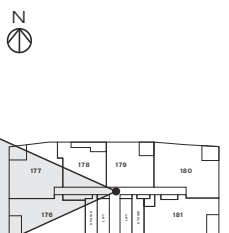

View photography is correct as of July 2024 and was taken approximately from the centre of the building at varying heights. Views depicted are intended as a guide only, representative of the existing general views from the camera position and are subject to change. Floor plans are indicative only and subject to development approval. The views are not to be relied on as representative of the views available from a proposed lot, floor level or the final actual view. Purchasers should make their own enquiries in this regard. Any future development which may impact on views is not within Mirvac's control. Purchasers should make their own enquiries as to the extent and possibility of any future development which may impact on views.

View photography is correct as of July 2024 and was taken approximately from the centre of the building at varying heights. Views depicted are intended as a guide only, representative of the existing general views from the camera position and are subject to change. Floor plans are indicative only and subject to development approval. The views are not to be relied on as representative of the views available from a proposed lot, floor level or the final actual view. Purchasers should make their own enquiries in this regard. Any future development which may impact on views is not within Mirvac's control. Purchasers should make their own enquiries as to the extent and possibility of any future development which may impact on views.



# Level 32

North  
West  
View

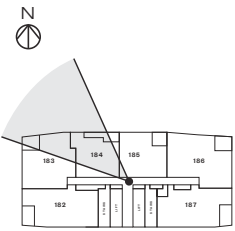

North  
View

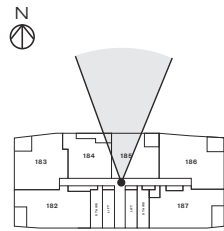

North  
East  
View

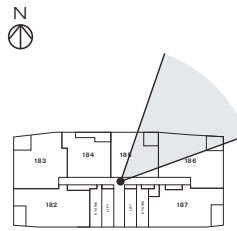

East  
View

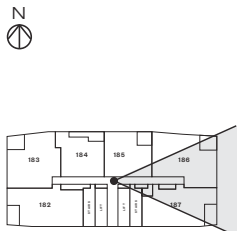

South  
East  
View

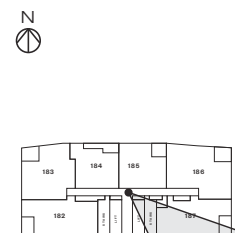

South  
View

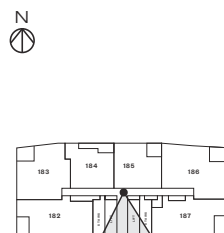

South  
West  
View

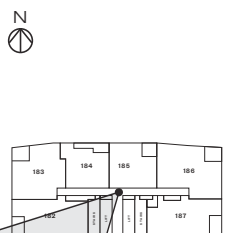

West  
View

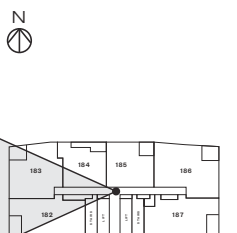

View photography is correct as of July 2024 and was taken approximately from the centre of the building at varying heights. Views depicted are intended as a guide only, representative of the existing general views from the camera position and are subject to change. Floor plans are indicative only and subject to development approval. The views are not to be relied on as representative of the views available from a proposed lot, floor level or the final actual view. Purchasers should make their own enquiries in this regard. Any future development which may impact on views is not within Mirvac's control. Purchasers should make their own enquiries as to the extent and possibility of any future development which may impact on views.

View photography is correct as of July 2024 and was taken approximately from the centre of the building at varying heights. Views depicted are intended as a guide only, representative of the existing general views from the camera position and are subject to change. Floor plans are indicative only and subject to development approval. The views are not to be relied on as representative of the views available from a proposed lot, floor level or the final actual view. Purchasers should make their own enquiries in this regard. Any future development which may impact on views is not within Mirvac's control. Purchasers should make their own enquiries as to the extent and possibility of any future development which may impact on views.



# Level 33

North  
West  
View

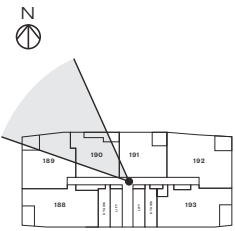

North  
View

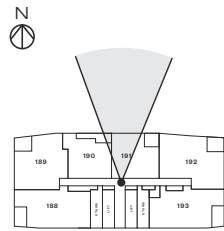

North  
East  
View

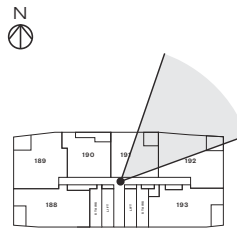

East  
View

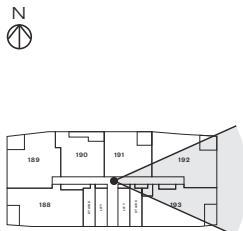

South  
East  
View

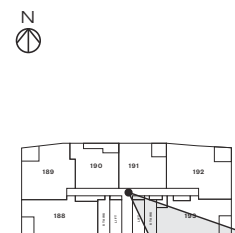

South  
View

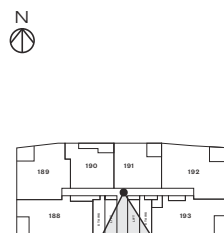

South  
West  
View

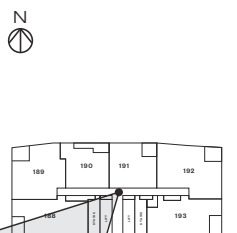

West  
View

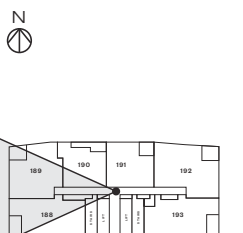

View photography is correct as of July 2024 and was taken approximately from the centre of the building at varying heights. Views depicted are intended as a guide only, representative of the existing general views from the camera position and are subject to change. Floor plans are indicative only and subject to development approval. The views are not to be relied on as representative of the views available from a proposed lot, floor level or the final actual view. Purchasers should make their own enquiries in this regard. Any future development which may impact on views is not within Mirvac's control. Purchasers should make their own enquiries as to the extent and possibility of any future development which may impact on views.

View photography is correct as of July 2024 and was taken approximately from the centre of the building at varying heights. Views depicted are intended as a guide only, representative of the existing general views from the camera position and are subject to change. Floor plans are indicative only and subject to development approval. The views are not to be relied on as representative of the views available from a proposed lot, floor level or the final actual view. Purchasers should make their own enquiries in this regard. Any future development which may impact on views is not within Mirvac's control. Purchasers should make their own enquiries as to the extent and possibility of any future development which may impact on views.



# Level 34

North  
West  
View

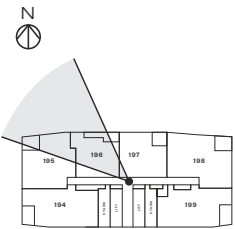

North  
View

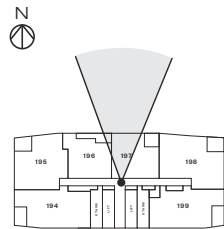

North  
East  
View

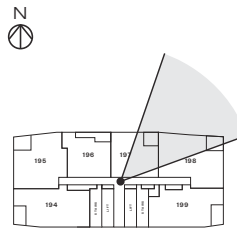

East  
View

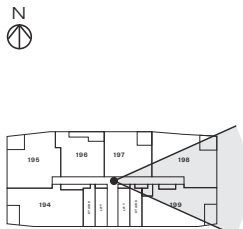

South  
East  
View

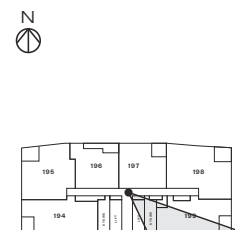

South  
View

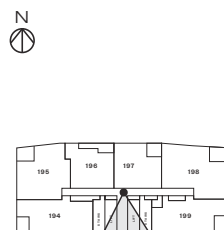

South  
West  
View

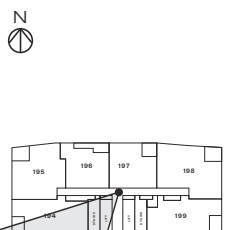

West  
View

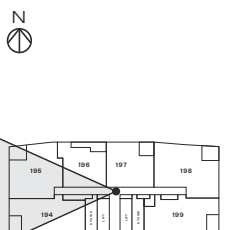

View photography is correct as of July 2024 and was taken approximately from the centre of the building at varying heights. Views depicted are intended as a guide only, representative of the existing general views from the camera position and are subject to change. Floor plans are indicative only and subject to development approval. The views are not to be relied on as representative of the views available from a proposed lot, floor level or the final actual view. Purchasers should make their own enquiries in this regard. Any future development which may impact on views is not within Mirvac's control. Purchasers should make their own enquiries as to the extent and possibility of any future development which may impact on views.

View photography is correct as of July 2024 and was taken approximately from the centre of the building at varying heights. Views depicted are intended as a guide only, representative of the existing general views from the camera position and are subject to change. Floor plans are indicative only and subject to development approval. The views are not to be relied on as representative of the views available from a proposed lot, floor level or the final actual view. Purchasers should make their own enquiries in this regard. Any future development which may impact on views is not within Mirvac's control. Purchasers should make their own enquiries as to the extent and possibility of any future development which may impact on views.



# Level 35

North  
West  
View

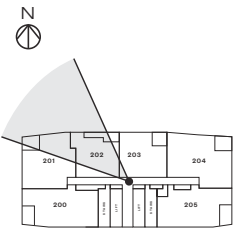

North  
View

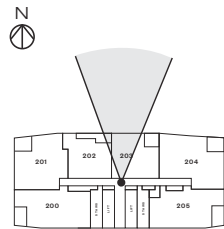

North  
East  
View

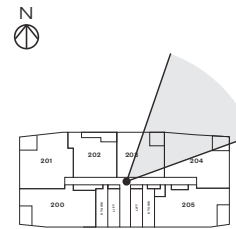

East  
View

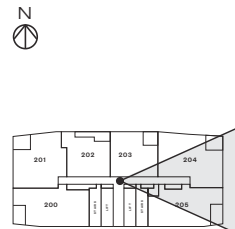

South  
East  
View

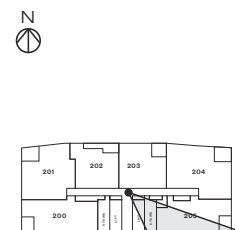

South  
View

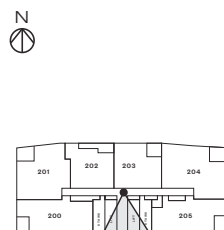

South  
West  
View

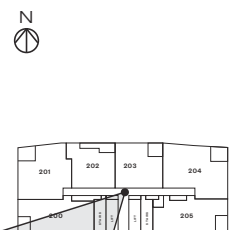

West  
View

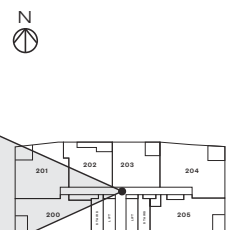

View photography is correct as of July 2024 and was taken approximately from the centre of the building at varying heights. Views depicted are intended as a guide only, representative of the existing general views from the camera position and are subject to change. Floor plans are indicative only and subject to development approval. The views are not to be relied on as representative of the views available from a proposed lot, floor level or the final actual view. Purchasers should make their own enquiries in this regard. Any future development which may impact on views is not within Mirvac's control. Purchasers should make their own enquiries as to the extent and possibility of any future development which may impact on views.

View photography is correct as of July 2024 and was taken approximately from the centre of the building at varying heights. Views depicted are intended as a guide only, representative of the existing general views from the camera position and are subject to change. Floor plans are indicative only and subject to development approval. The views are not to be relied on as representative of the views available from a proposed lot, floor level or the final actual view. Purchasers should make their own enquiries in this regard. Any future development which may impact on views is not within Mirvac's control. Purchasers should make their own enquiries as to the extent and possibility of any future development which may impact on views.



# Level 36

North  
West  
View

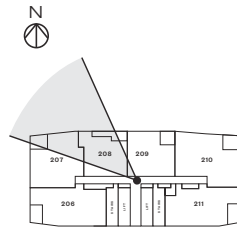

North  
View

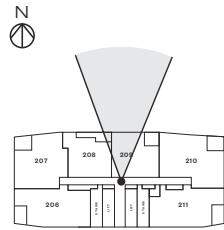

North  
East  
View

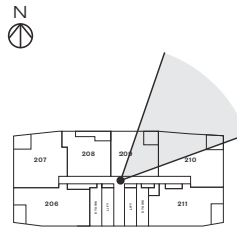

East  
View

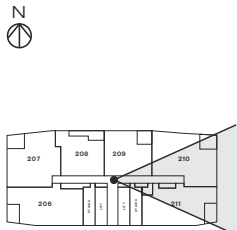

South  
East  
View

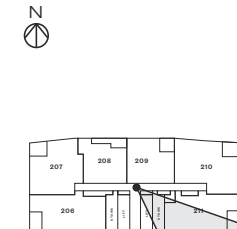

South  
View

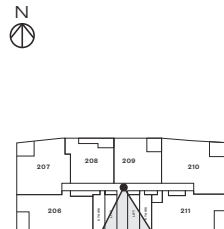

South  
West  
View

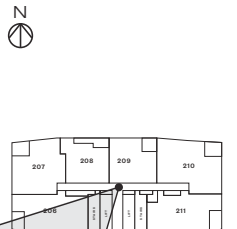

West  
View

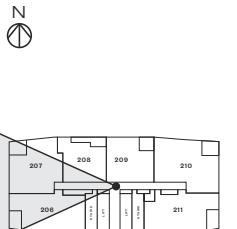

View photography is correct as of July 2024 and was taken approximately from the centre of the building at varying heights. Views depicted are intended as a guide only, representative of the existing general views from the camera position and are subject to change. Floor plans are indicative only and subject to development approval. The views are not to be relied on as representative of the views available from a proposed lot, floor level or the final actual view. Purchasers should make their own enquiries in this regard. Any future development which may impact on views is not within Mirvac's control. Purchasers should make their own enquiries as to the extent and possibility of any future development which may impact on views.

View photography is correct as of July 2024 and was taken approximately from the centre of the building at varying heights. Views depicted are intended as a guide only, representative of the existing general views from the camera position and are subject to change. Floor plans are indicative only and subject to development approval. The views are not to be relied on as representative of the views available from a proposed lot, floor level or the final actual view. Purchasers should make their own enquiries in this regard. Any future development which may impact on views is not within Mirvac's control. Purchasers should make their own enquiries as to the extent and possibility of any future development which may impact on views.



# Level 37

North  
West  
View

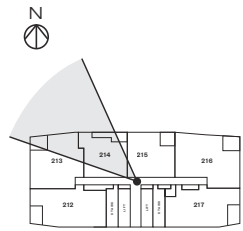

North  
View

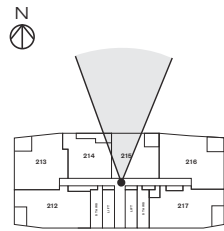

North  
East  
View

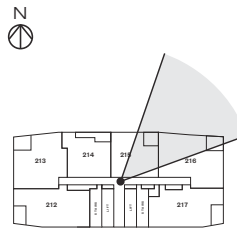

East  
View

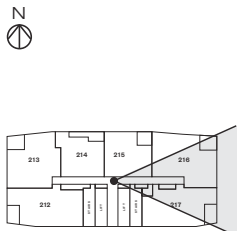

South  
East  
View

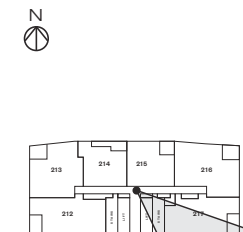

South  
View

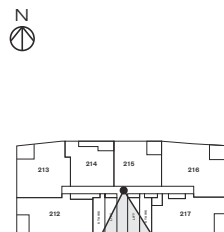

South  
West  
View

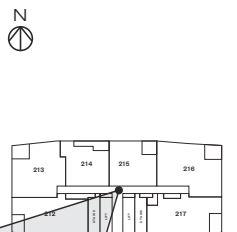

West  
View

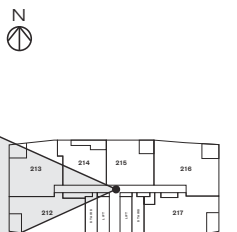

View photography is correct as of July 2024 and was taken approximately from the centre of the building at varying heights. Views depicted are intended as a guide only, representative of the existing general views from the camera position and are subject to change. Floor plans are indicative only and subject to development approval. The views are not to be relied on as representative of the views available from a proposed lot, floor level or the final actual view. Purchasers should make their own enquiries in this regard. Any future development which may impact on views is not within Mirvac's control. Purchasers should make their own enquiries as to the extent and possibility of any future development which may impact on views.

View photography is correct as of July 2024 and was taken approximately from the centre of the building at varying heights. Views depicted are intended as a guide only, representative of the existing general views from the camera position and are subject to change. Floor plans are indicative only and subject to development approval. The views are not to be relied on as representative of the views available from a proposed lot, floor level or the final actual view. Purchasers should make their own enquiries in this regard. Any future development which may impact on views is not within Mirvac's control. Purchasers should make their own enquiries as to the extent and possibility of any future development which may impact on views.



# Level 38

North  
West  
View

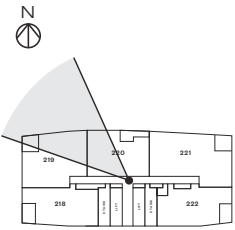

North  
View

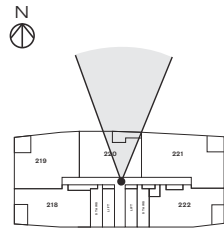

North  
East  
View

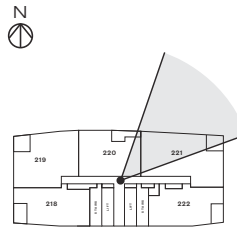

East  
View

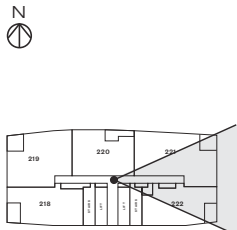

South  
East  
View

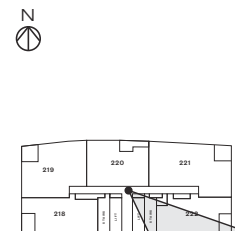

South  
View

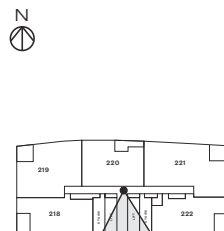

South  
West  
View

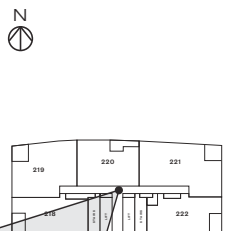

West  
View

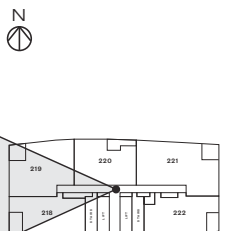

View photography is correct as of July 2024 and was taken approximately from the centre of the building at varying heights. Views depicted are intended as a guide only, representative of the existing general views from the camera position and are subject to change. Floor plans are indicative only and subject to development approval. The views are not to be relied on as representative of the views available from a proposed lot, floor level or the final actual view. Purchasers should make their own enquiries in this regard. Any future development which may impact on views is not within Mirvac's control. Purchasers should make their own enquiries as to the extent and possibility of any future development which may impact on views.

View photography is correct as of July 2024 and was taken approximately from the centre of the building at varying heights. Views depicted are intended as a guide only, representative of the existing general views from the camera position and are subject to change. Floor plans are indicative only and subject to development approval. The views are not to be relied on as representative of the views available from a proposed lot, floor level or the final actual view. Purchasers should make their own enquiries in this regard. Any future development which may impact on views is not within Mirvac's control. Purchasers should make their own enquiries as to the extent and possibility of any future development which may impact on views.



# Level 39

North  
West  
View

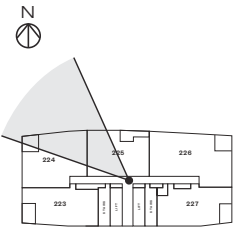

North  
View

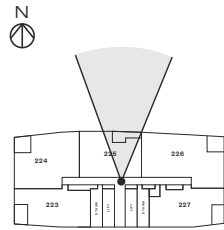

North  
East  
View

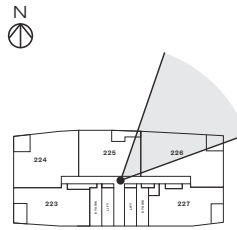

East  
View

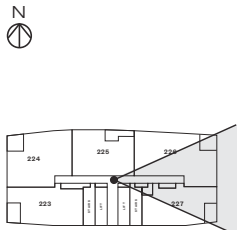

South  
East  
View

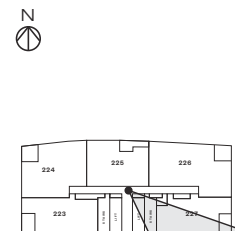

South  
View

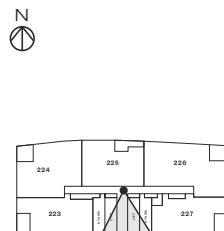

South  
West  
View

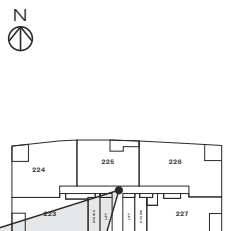

West  
View

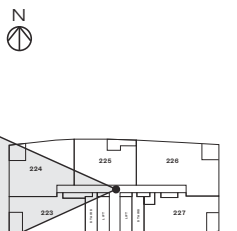

View photography is correct as of July 2024 and was taken approximately from the centre of the building at varying heights. Views depicted are intended as a guide only, representative of the existing general views from the camera position and are subject to change. Floor plans are indicative only and subject to development approval. The views are not to be relied on as representative of the views available from a proposed lot, floor level or the final actual view. Purchasers should make their own enquiries in this regard. Any future development which may impact on views is not within Mirvac's control. Purchasers should make their own enquiries as to the extent and possibility of any future development which may impact on views.

View photography is correct as of July 2024 and was taken approximately from the centre of the building at varying heights. Views depicted are intended as a guide only, representative of the existing general views from the camera position and are subject to change. Floor plans are indicative only and subject to development approval. The views are not to be relied on as representative of the views available from a proposed lot, floor level or the final actual view. Purchasers should make their own enquiries in this regard. Any future development which may impact on views is not within Mirvac's control. Purchasers should make their own enquiries as to the extent and possibility of any future development which may impact on views.



# Level 40

North  
West  
View

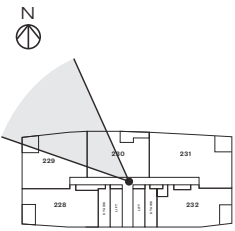

North  
View

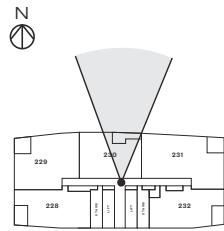

North  
East  
View

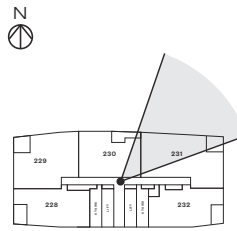

East  
View

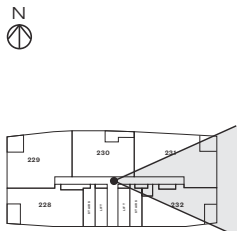

South  
East  
View

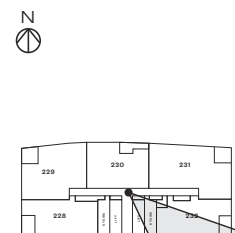

South  
View

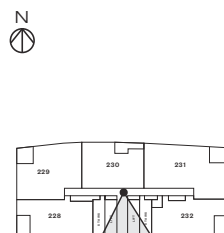

South  
West  
View

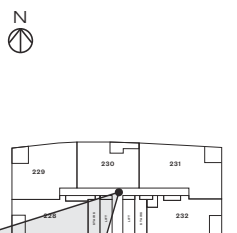

West  
View

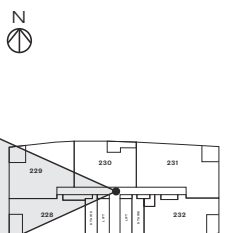

View photography is correct as of July 2024 and was taken approximately from the centre of the building at varying heights. Views depicted are intended as a guide only, representative of the existing general views from the camera position and are subject to change. Floor plans are indicative only and subject to development approval. The views are not to be relied on as representative of the views available from a proposed lot, floor level or the final actual view. Purchasers should make their own enquiries in this regard. Any future development which may impact on views is not within Mirvac's control. Purchasers should make their own enquiries as to the extent and possibility of any future development which may impact on views.

View photography is correct as of July 2024 and was taken approximately from the centre of the building at varying heights. Views depicted are intended as a guide only, representative of the existing general views from the camera position and are subject to change. Floor plans are indicative only and subject to development approval. The views are not to be relied on as representative of the views available from a proposed lot, floor level or the final actual view. Purchasers should make their own enquiries in this regard. Any future development which may impact on views is not within Mirvac's control. Purchasers should make their own enquiries as to the extent and possibility of any future development which may impact on views.



# Level 41

North  
West  
View

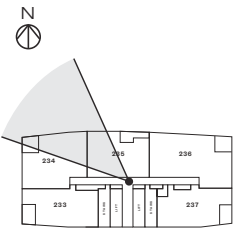

North  
View

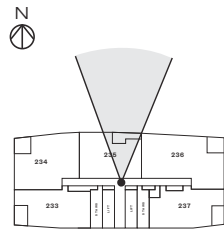

North  
East  
View

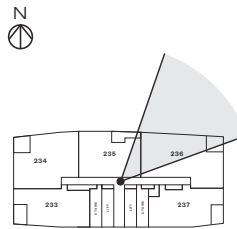

East  
View

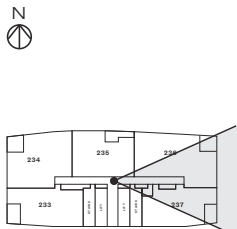

South  
East  
View

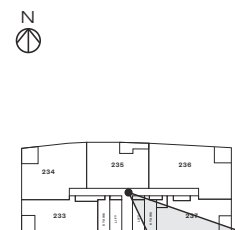

South  
View

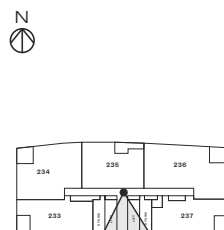

South  
West  
View

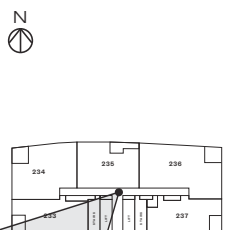

West  
View

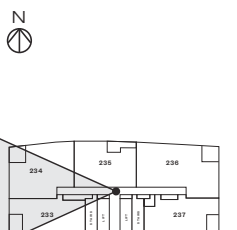

View photography is correct as of July 2024 and was taken approximately from the centre of the building at varying heights. Views depicted are intended as a guide only, representative of the existing general views from the camera position and are subject to change. Floor plans are indicative only and subject to development approval. The views are not to be relied on as representative of the views available from a proposed lot, floor level or the final actual view. Purchasers should make their own enquiries in this regard. Any future development which may impact on views is not within Mirvac's control. Purchasers should make their own enquiries as to the extent and possibility of any future development which may impact on views.

View photography is correct as of July 2024 and was taken approximately from the centre of the building at varying heights. Views depicted are intended as a guide only, representative of the existing general views from the camera position and are subject to change. Floor plans are indicative only and subject to development approval. The views are not to be relied on as representative of the views available from a proposed lot, floor level or the final actual view. Purchasers should make their own enquiries in this regard. Any future development which may impact on views is not within Mirvac's control. Purchasers should make their own enquiries as to the extent and possibility of any future development which may impact on views.



# Level 42

North  
West  
View

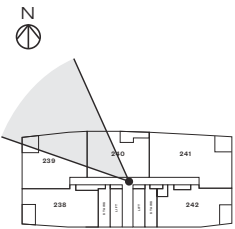

North  
View

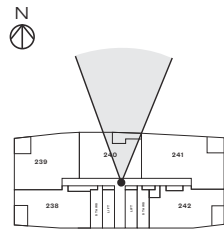

North  
East  
View

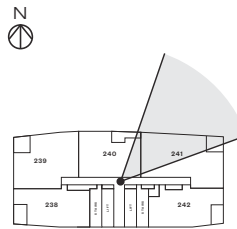

East  
View

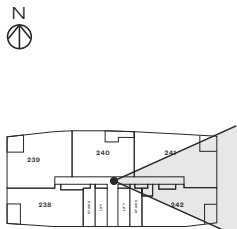

South  
East  
View

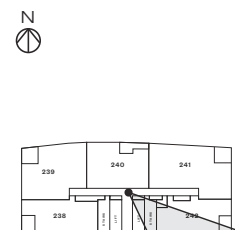

South  
View

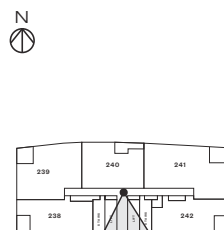

South  
West  
View

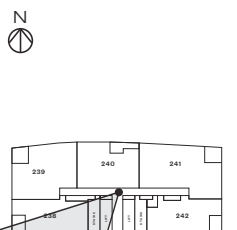

West  
View

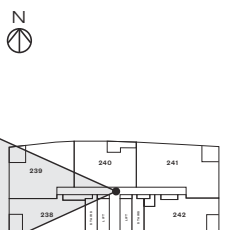

View photography is correct as of July 2024 and was taken approximately from the centre of the building at varying heights. Views depicted are intended as a guide only, representative of the existing general views from the camera position and are subject to change. Floor plans are indicative only and subject to development approval. The views are not to be relied on as representative of the views available from a proposed lot, floor level or the final actual view. Purchasers should make their own enquiries in this regard. Any future development which may impact on views is not within Mirvac's control. Purchasers should make their own enquiries as to the extent and possibility of any future development which may impact on views.

View photography is correct as of July 2024 and was taken approximately from the centre of the building at varying heights. Views depicted are intended as a guide only, representative of the existing general views from the camera position and are subject to change. Floor plans are indicative only and subject to development approval. The views are not to be relied on as representative of the views available from a proposed lot, floor level or the final actual view. Purchasers should make their own enquiries in this regard. Any future development which may impact on views is not within Mirvac's control. Purchasers should make their own enquiries as to the extent and possibility of any future development which may impact on views.



# Level 43

North  
West  
View

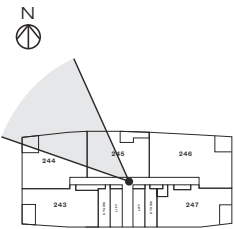

North  
View

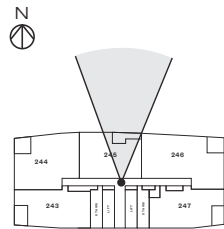

North  
East  
View

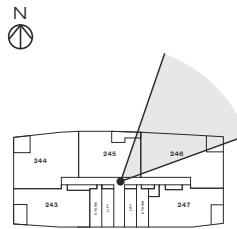

East  
View

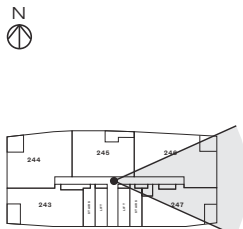

South  
East  
View

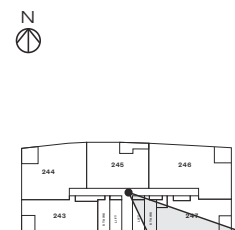

South  
View

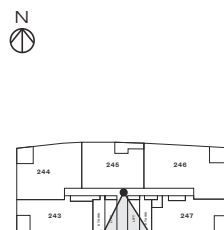

South  
West  
View

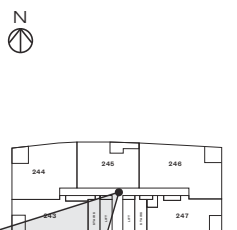

West  
View

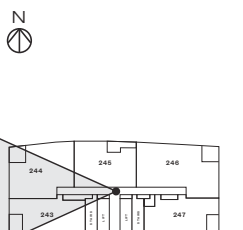

View photography is correct as of July 2024 and was taken approximately from the centre of the building at varying heights. Views depicted are intended as a guide only, representative of the existing general views from the camera position and are subject to change. Floor plans are indicative only and subject to development approval. The views are not to be relied on as representative of the views available from a proposed lot, floor level or the final actual view. Purchasers should make their own enquiries in this regard. Any future development which may impact on views is not within Mirvac's control. Purchasers should make their own enquiries as to the extent and possibility of any future development which may impact on views.

View photography is correct as of July 2024 and was taken approximately from the centre of the building at varying heights. Views depicted are intended as a guide only, representative of the existing general views from the camera position and are subject to change. Floor plans are indicative only and subject to development approval. The views are not to be relied on as representative of the views available from a proposed lot, floor level or the final actual view. Purchasers should make their own enquiries in this regard. Any future development which may impact on views is not within Mirvac's control. Purchasers should make their own enquiries as to the extent and possibility of any future development which may impact on views.



# Level 44

North  
West  
View

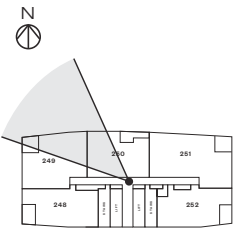

North  
View

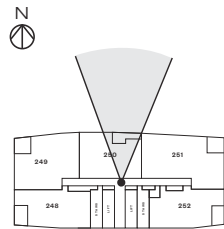

North  
East  
View

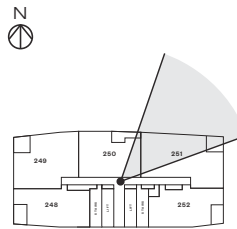

East  
View

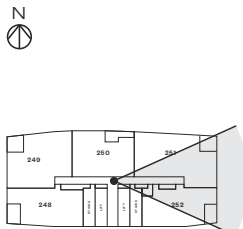

South  
East  
View

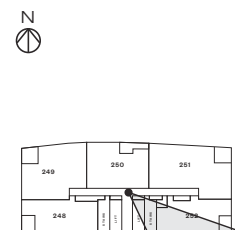

South  
View

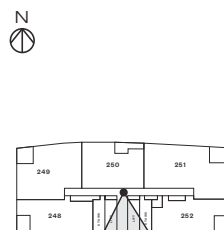

South  
West  
View

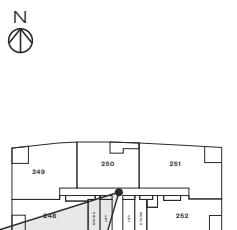

West  
View

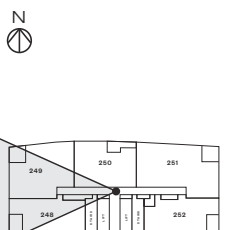

View photography is correct as of July 2024 and was taken approximately from the centre of the building at varying heights. Views depicted are intended as a guide only, representative of the existing general views from the camera position and are subject to change. Floor plans are indicative only and subject to development approval. The views are not to be relied on as representative of the views available from a proposed lot, floor level or the final actual view. Purchasers should make their own enquiries in this regard. Any future development which may impact on views is not within Mirvac's control. Purchasers should make their own enquiries as to the extent and possibility of any future development which may impact on views.

View photography is correct as of July 2024 and was taken approximately from the centre of the building at varying heights. Views depicted are intended as a guide only, representative of the existing general views from the camera position and are subject to change. Floor plans are indicative only and subject to development approval. The views are not to be relied on as representative of the views available from a proposed lot, floor level or the final actual view. Purchasers should make their own enquiries in this regard. Any future development which may impact on views is not within Mirvac's control. Purchasers should make their own enquiries as to the extent and possibility of any future development which may impact on views.



# Level 45

North  
West  
View

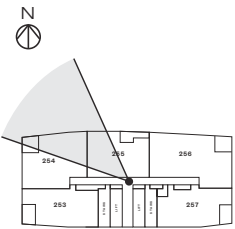

North  
View

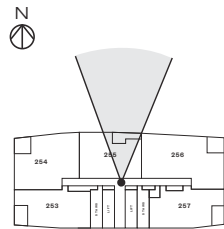

North  
East  
View

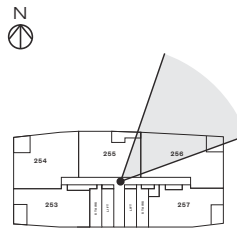

East  
View

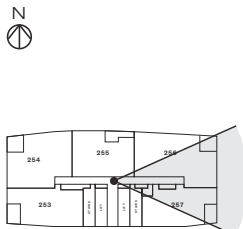

South  
East  
View

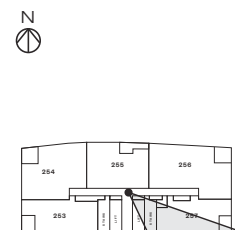

South  
View

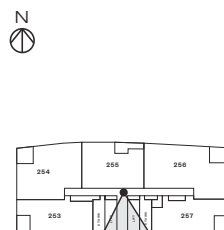

South  
West  
View

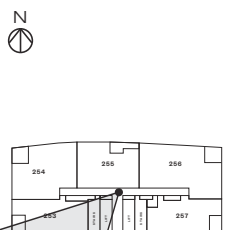

West  
View

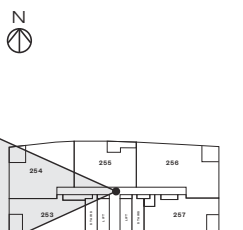

View photography is correct as of July 2024 and was taken approximately from the centre of the building at varying heights. Views depicted are intended as a guide only, representative of the existing general views from the camera position and are subject to change. Floor plans are indicative only and subject to development approval. The views are not to be relied on as representative of the views available from a proposed lot, floor level or the final actual view. Purchasers should make their own enquiries in this regard. Any future development which may impact on views is not within Mirvac's control. Purchasers should make their own enquiries as to the extent and possibility of any future development which may impact on views.

View photography is correct as of July 2024 and was taken approximately from the centre of the building at varying heights. Views depicted are intended as a guide only, representative of the existing general views from the camera position and are subject to change. Floor plans are indicative only and subject to development approval. The views are not to be relied on as representative of the views available from a proposed lot, floor level or the final actual view. Purchasers should make their own enquiries in this regard. Any future development which may impact on views is not within Mirvac's control. Purchasers should make their own enquiries as to the extent and possibility of any future development which may impact on views.



# Level 46

North  
West  
View

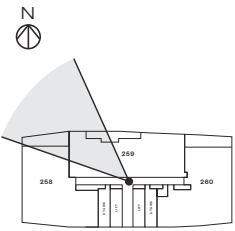

North  
View

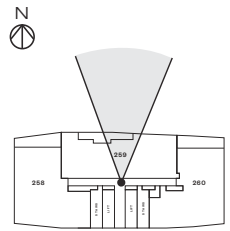

North  
East  
View

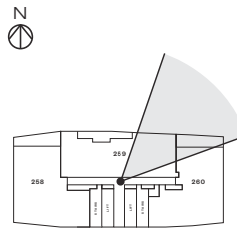

East  
View

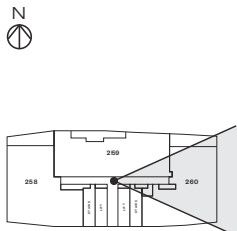

South  
East  
View

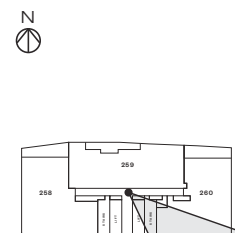

South  
View

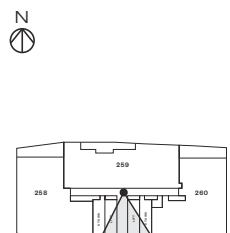

South  
West  
View

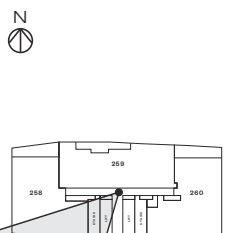

West  
View

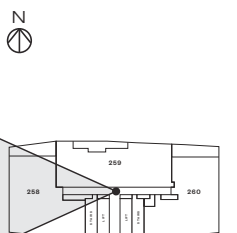

View photography is correct as of July 2024 and was taken approximately from the centre of the building at varying heights. Views depicted are intended as a guide only, representative of the existing general views from the camera position and are subject to change. Floor plans are indicative only and subject to development approval. The views are not to be relied on as representative of the views available from a proposed lot, floor level or the final actual view. Purchasers should make their own enquiries in this regard. Any future development which may impact on views is not within Mirvac's control. Purchasers should make their own enquiries as to the extent and possibility of any future development which may impact on views.

View photography is correct as of July 2024 and was taken approximately from the centre of the building at varying heights. Views depicted are intended as a guide only, representative of the existing general views from the camera position and are subject to change. Floor plans are indicative only and subject to development approval. The views are not to be relied on as representative of the views available from a proposed lot, floor level or the final actual view. Purchasers should make their own enquiries in this regard. Any future development which may impact on views is not within Mirvac's control. Purchasers should make their own enquiries as to the extent and possibility of any future development which may impact on views.



# Level 47

North  
West  
View

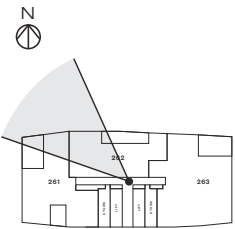

North  
View

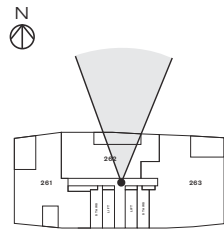

North  
East  
View

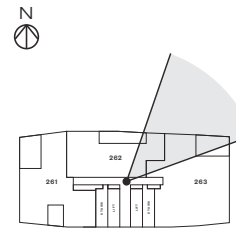

East  
View

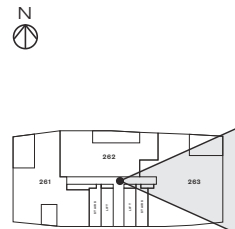

South  
East  
View

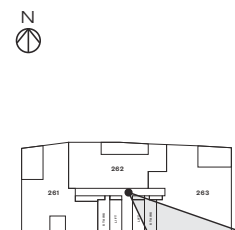

South  
View

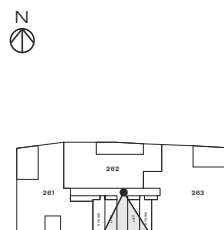

South  
West  
View

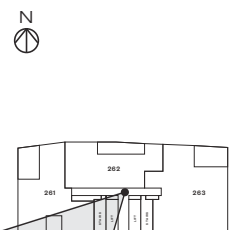

West  
View

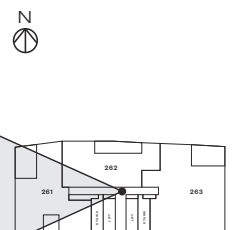

View photography is correct as of July 2024 and was taken approximately from the centre of the building at varying heights. Views depicted are intended as a guide only, representative of the existing general views from the camera position and are subject to change. Floor plans are indicative only and subject to development approval. The views are not to be relied on as representative of the views available from a proposed lot, floor level or the final actual view. Purchasers should make their own enquiries in this regard. Any future development which may impact on views is not within Mirvac's control. Purchasers should make their own enquiries as to the extent and possibility of any future development which may impact on views.

View photography is correct as of July 2024 and was taken approximately from the centre of the building at varying heights. Views depicted are intended as a guide only, representative of the existing general views from the camera position and are subject to change. Floor plans are indicative only and subject to development approval. The views are not to be relied on as representative of the views available from a proposed lot, floor level or the final actual view. Purchasers should make their own enquiries in this regard. Any future development which may impact on views is not within Mirvac's control. Purchasers should make their own enquiries as to the extent and possibility of any future development which may impact on views.



# Level 48

North  
West  
View

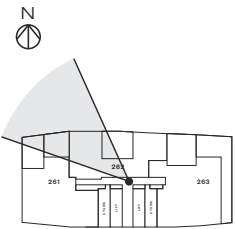

North  
View

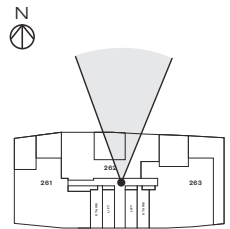

North  
East  
View

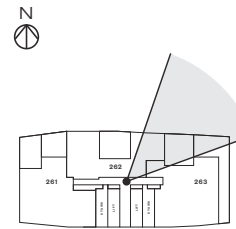

East  
View

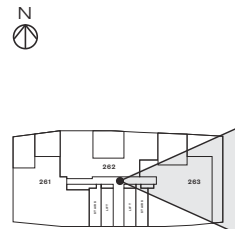

South  
East  
View

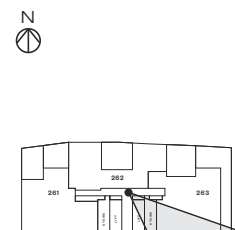

South  
View

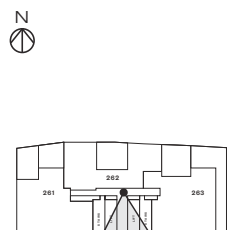

South  
West  
View

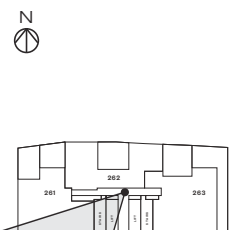

West  
View

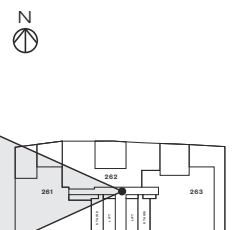

View photography is correct as of July 2024 and was taken approximately from the centre of the building at varying heights. Views depicted are intended as a guide only, representative of the existing general views from the camera position and are subject to change. Floor plans are indicative only and subject to development approval. The views are not to be relied on as representative of the views available from a proposed lot, floor level or the final actual view. Purchasers should make their own enquiries in this regard. Any future development which may impact on views is not within Mirvac's control. Purchasers should make their own enquiries as to the extent and possibility of any future development which may impact on views.

View photography is correct as of July 2024 and was taken approximately from the centre of the building at varying heights. Views depicted are intended as a guide only, representative of the existing general views from the camera position and are subject to change. Floor plans are indicative only and subject to development approval. The views are not to be relied on as representative of the views available from a proposed lot, floor level or the final actual view. Purchasers should make their own enquiries in this regard. Any future development which may impact on views is not within Mirvac's control. Purchasers should make their own enquiries as to the extent and possibility of any future development which may impact on views.



