

"Final areas are subject to design changes, Council approval and field survey and may differ from those shown on this Identification Plan.

Final presentation of areas will comply with requirements of the Registrar of Titles and may vary from the format shown on this Identification Plan.

The Seller, under the Contract Terms, is entitled to make Variations to the Lot, including to its location, area, size, dimensions and elevation. Without limitation, if the area of the Lot on the Plan is not more than 5% different to the total area of the Lot as shown on this Identification Plan, the Variation is deemed to be a Permitted Variation and the Buyer cannot Object."

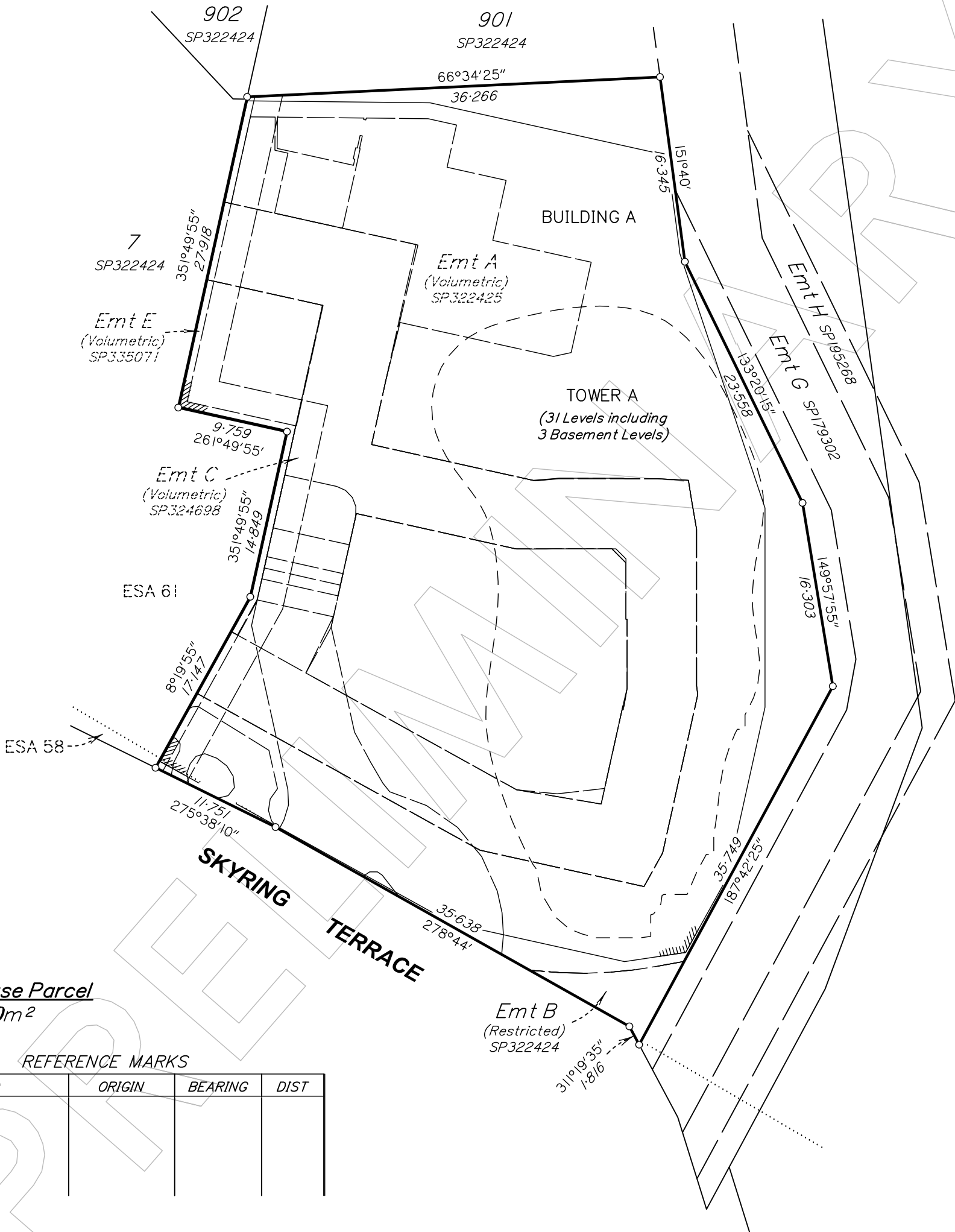
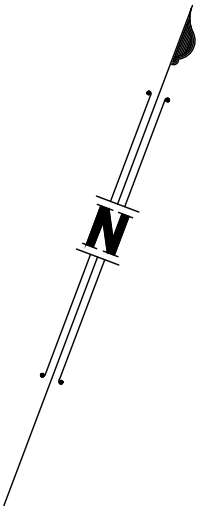

Area of Base Parcel  
3410m<sup>2</sup>

REFERENCE MARKS

STN	TO	ORIGIN	BEARING	DIST

PRELIMINARY STATUS

ALL DIMENSIONS AND AREAS ON THIS PLAN ARE SUBJECT TO SURVEY AND REQUIREMENTS FOR LODGEMENT OF SURVEY PLANS IN THE DEPARTMENT OF NATURAL RESOURCES, MINES AND ENERGY.



0m0

20m50mm

40m100mm

60m150mm

State copyright reserved.

**Plan of Lots 1011, 1012, 1021-1025, 1027, 1031-1037, 1041-1047, 1051-1057, 1061-1067, 1071-1077, 1081-1087, 1091-1097, 1101-1103, 1105-1107, 1111, 1112, 1114-1117, 1121-1123, 1125-1127, 1131-1137, 1141-1143, 1145-1147, 1151-1157, 1161, 1163-1167, 1171-1173, 1175-1177, 1181-1183, 1185-1187, 1191-1197, 1201-1203, 1211-1213, 1221-1223, 1231-1233, 1241-1243, 1251, 1252 & Common Property**

*Cancelling Lot 1 on SP322424*

LOCAL GOVERNMENT: BRISBANE C.C.      LOCALITY: NEWSTEAD

Meridian: *Vide SP322424*

Scale: 1:400

Format: BUILDING

SP322426

Survey Records: No

BRMM2372\_CUN\_75\_8 SP322426

WARNING : Folded or Mutilated Plans will not be accepted.  
Plans may be rolled.  
Information may not be placed in the outer margins.

(Dealing No.)

4. Lodged by

(Include address, phone number, email, reference, and Lodger Code)

I. Existing		Created		
Title Reference	Description	New Lots	Road	Secondary Interests
	Lot I on SP322424	1011, 1012, 1021-1025, 1027, 1031-1037, 1041-1047, 1051-1057, 1061-1067, 1071-1077, 1081-1087, 1091-1097, 1101-1103, 1105-1107, 1111, 1112, 1114-1117, 1121-1123, 1125-1127, 1131-1137, 1141-1143, 1145-1147, 1151-1157, 1161, 1163-1167, 1171-1173, 1175-1177, 1181-1183, 1185-1187, 1191-1197, 1201-1203, 1211-1213, 1221-1223, 1231-1233, 1241-1243, 1251, 1252	-	-

ENCUMBRANCE EASEMENT ALLOCATION

Easement		Lots To Be Encumbered	
(Easement A on SP322425)		CP	
(Easement B on SP322424)		CP	
(Easement C on SP324698)		CP	
(Easement D on SP324699)		CP	
(Easement E on SP335071)		CP	
(Easement F )		CP	
1011, 1012, 1021-1025, 1027, 1031-1037, 1041-1047, 1051-1057, 1061-1067, 1071-1077, 1081-1087, 1091-1097, 1101-1103, 1105-1107, 1111, 1112, 1114-1117, 1121-1123, 1125-1127, 1131-1137, 1141-1143, 1145-1147, 1151-1157, 1161, 1163-1167, 1171-1173, 1175-1177, 1181-1183, 1185-1187, 1191-1197, 1201-1203, 1211-1213, 1221-1223, 1231-1233, 1241-1243, 1251, 1252		ESA 61	
CP	ESA 58 & ESA 61		
Lots	Orig		

2.Orig Grant Allocation :

3.References :

Dept File :  
Local Govt :  
Surveyor : BRMM2372.CUN

5. Passed & Endorsed :

By: LandPartners Pty Ltd  
Date :  
Signed :  
Designation : Liaison Officer

Development Approval Date: .....

6. Building Format Plans only.

I certify that :  
\* As far as it is practical to determine, no part of the building shown on this plan encroaches onto adjoining lots or road;  
~~\* Part of the building shown on this plan encroaches onto adjoining lots and road~~

.....Cadastral Surveyor/Director\* Date  
\*delete words not required

7. Lodgement Fees :

Survey Deposit	\$\$	.....
Lodgement	\$\$	.....
.....New Titles	\$\$	.....
Photocopy	\$\$	.....
Postage	\$\$	.....
TOTAL	\$	.....

8. Insert  
Plan  
Number

SP322426

**LEVEL B**  
(BASEMENT 2)

"Final areas are subject to design changes, Council approval and field survey and may differ from those shown on this Identification Plan.

Final presentation of areas will comply with requirements of the Registrar of Titles and may vary from the format shown on this Identification Plan.

The Seller, under the Contract Terms, is entitled to make Variations to the Lot, including to its location, area, size, dimensions and elevation. Without limitation, if the area of the Lot on the Plan is not more than 5% different to the total area of the Lot as shown on this Identification Plan, the Variation is deemed to be a Permitted Variation and the Buyer cannot Object."

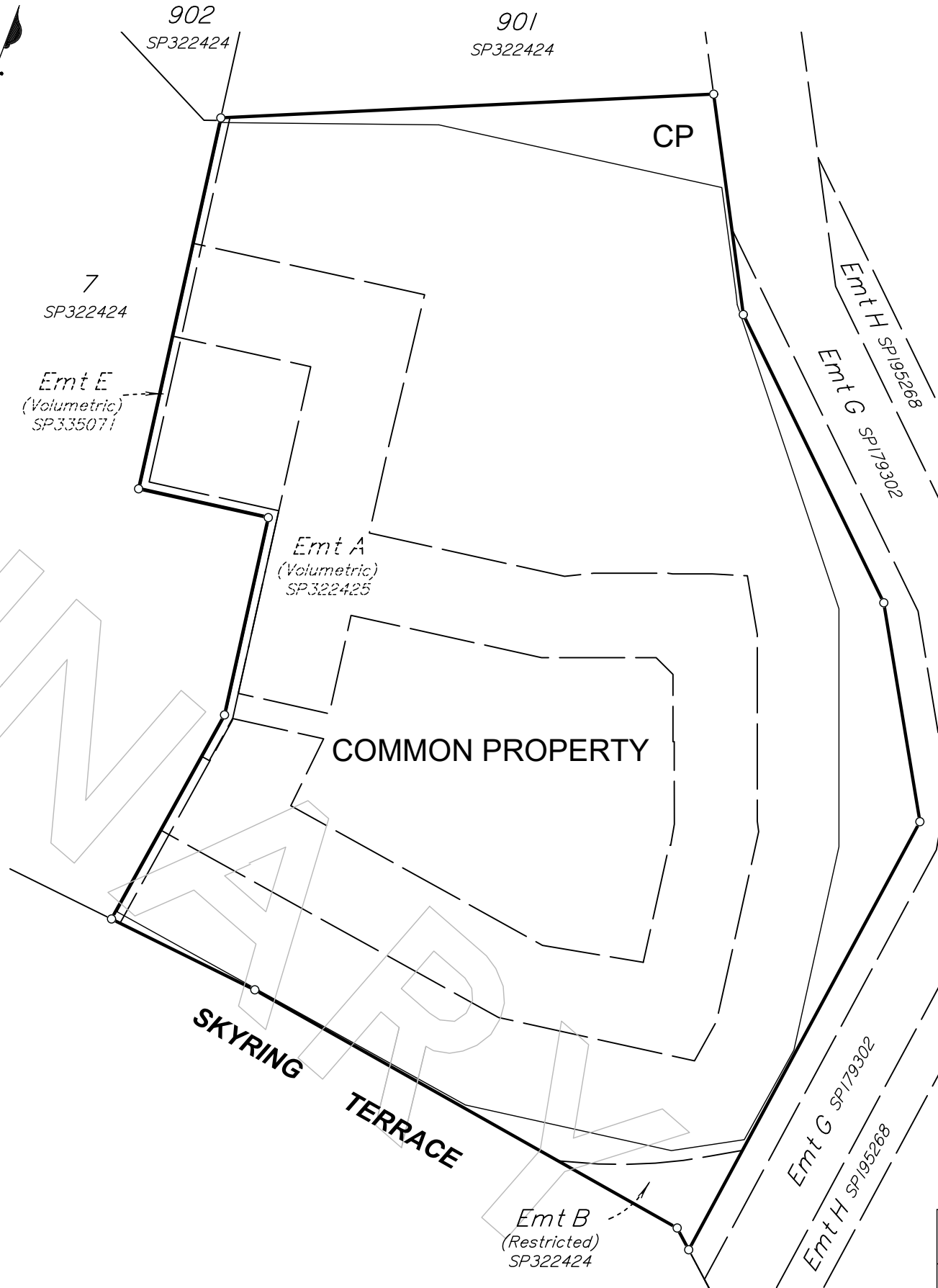

**LEVEL A**  
(BASEMENT 3)

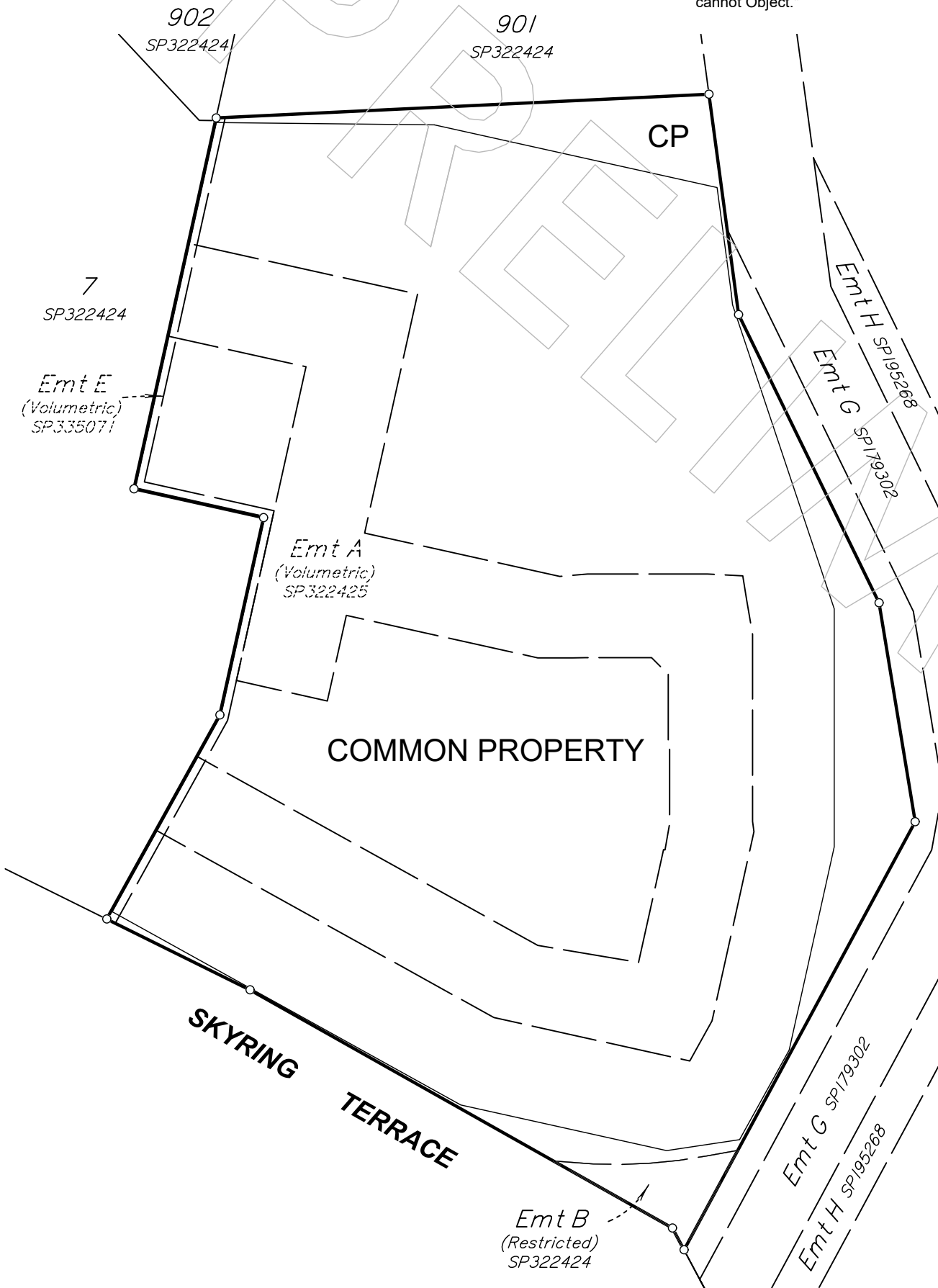

0m  
20m  
50mm  
40m  
100mm  
60m  
150mm

SCALE 1:400

Insert  
Plan  
Number  
**SP322426**

State copyright reserved

**LEVEL D**  
(LEVEL 1)

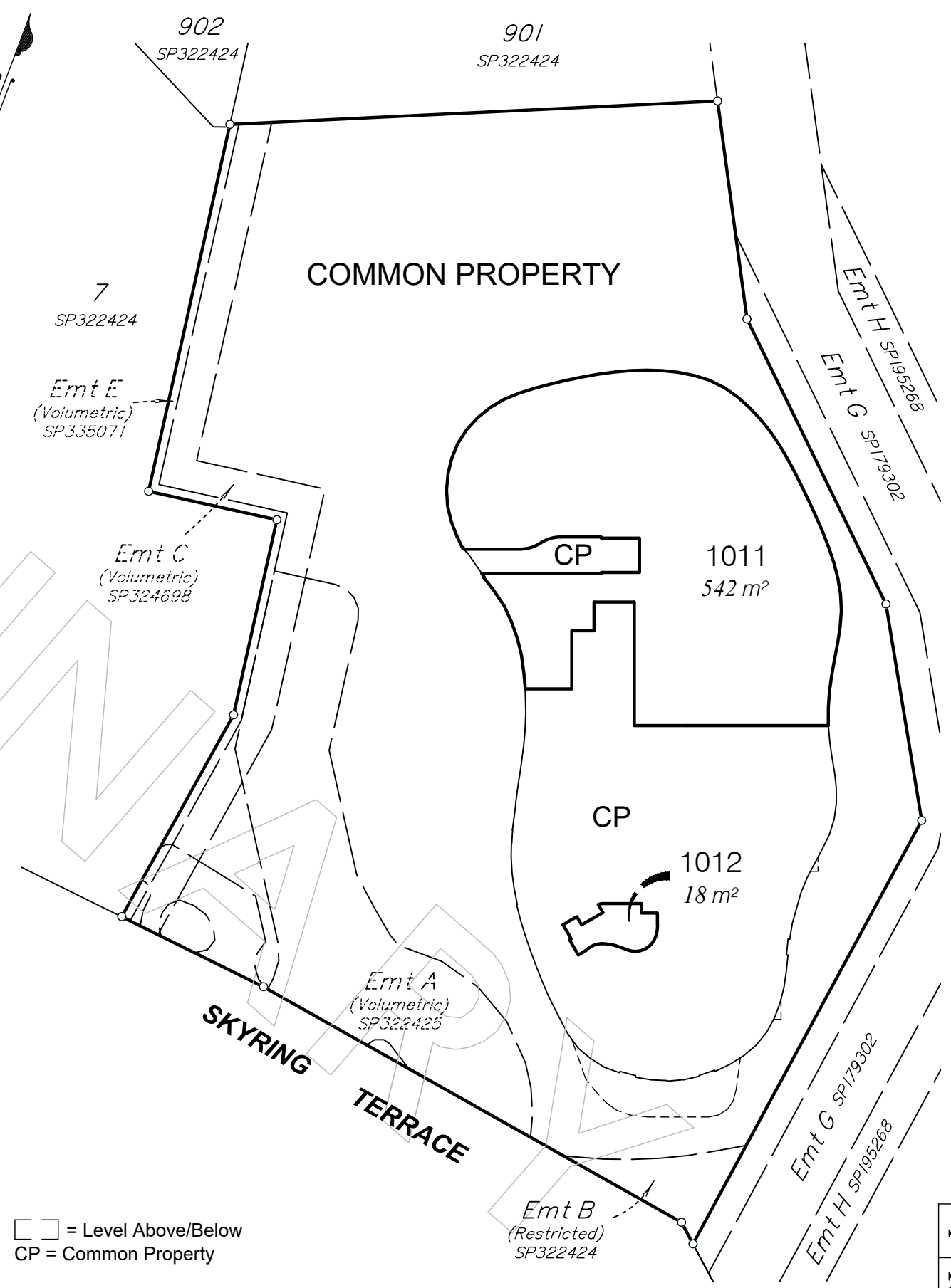

□ = Level Above/Below  
CP = Common Property

"Final areas are subject to design changes, Council approval and field survey and may differ from those shown on this Identification Plan.

Final presentation of areas will comply with requirements of the Registrar of Titles and may vary from the format shown on this Identification Plan.

The Seller, under the Contract Terms, is entitled to make Variations to the Lot, including to its location, area, size, dimensions and elevation. Without limitation, if the area of the Lot on the Plan is not more than 5% different to the total area of the Lot as shown on this Identification Plan, the Variation is deemed to be a Permitted Variation and the Buyer cannot Object."

**LEVEL C**  
(BASEMENT 1)

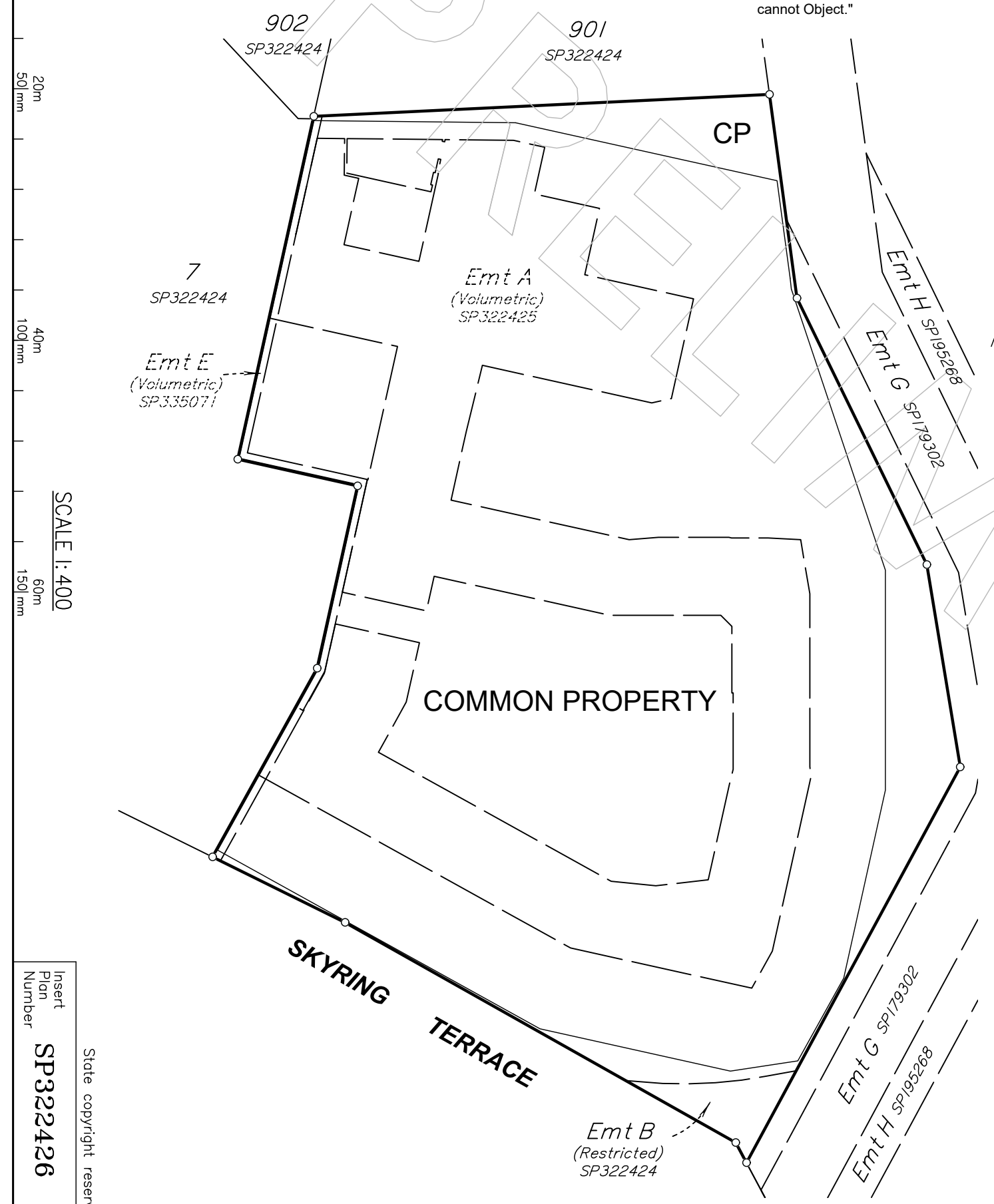

0m  
20m  
50m  
100m  
40m  
60m  
150m

SCALE 1:400

Insert  
Plan  
Number  
**SP322426**  
State copyright reserved

**LEVEL F**

(LEVEL 3)  
SCALE - 1:200

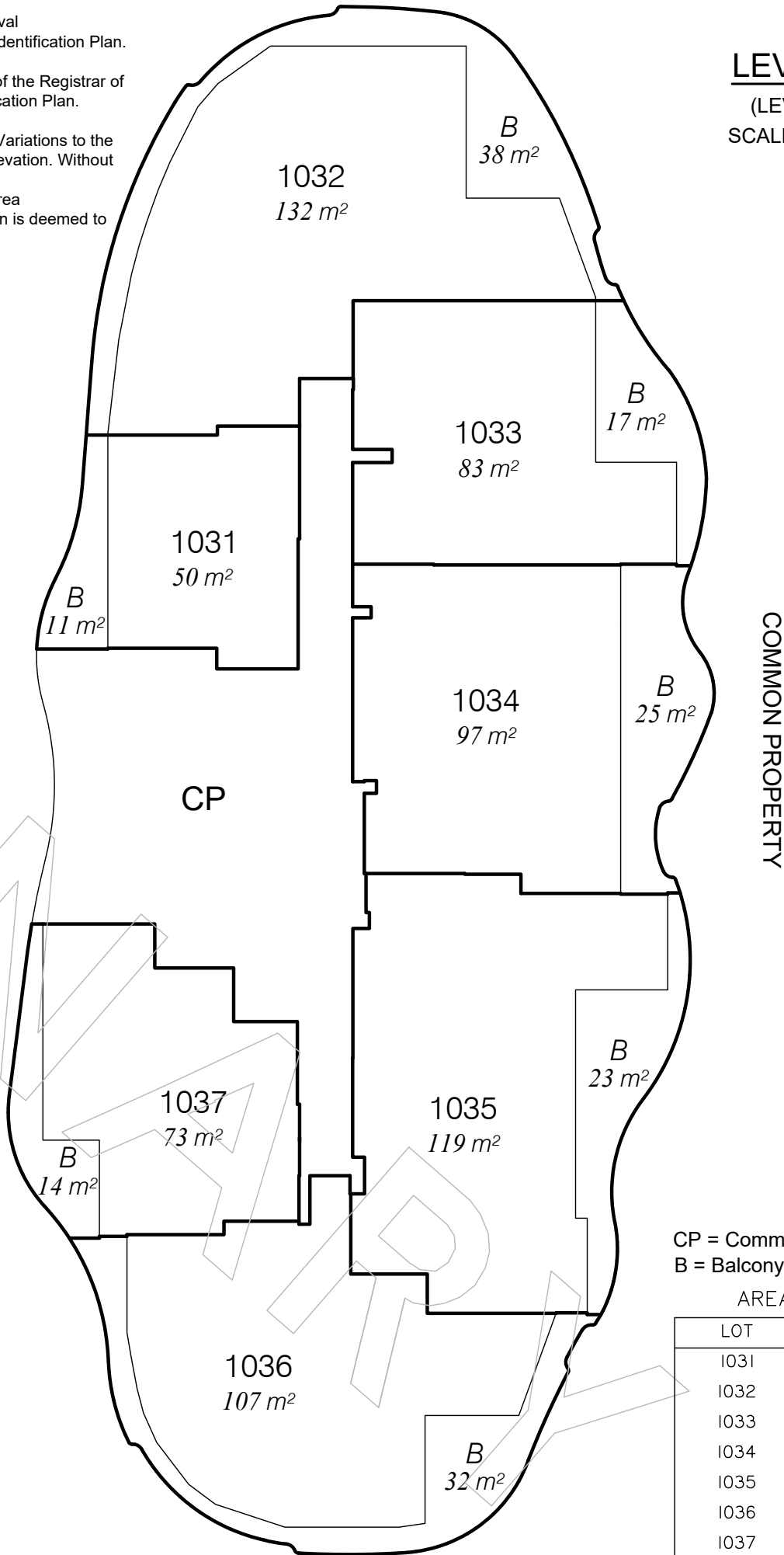

CP = Common Property  
B = Balcony

AREA TABLE

LOT	TOTAL AREA
1031	61m <sup>2</sup>
1032	170m <sup>2</sup>
1033	100m <sup>2</sup>
1034	122m <sup>2</sup>
1035	142m <sup>2</sup>
1036	139m <sup>2</sup>
1037	87m <sup>2</sup>

"Final areas are subject to design changes, Council approval and field survey and may differ from those shown on this Identification Plan.

Final presentation of areas will comply with requirements of the Registrar of Titles and may vary from the format shown on this Identification Plan.

The Seller, under the Contract Terms, is entitled to make Variations to the Lot, including to its location, area, size, dimensions and elevation. Without limitation, if the area of the Lot on the Plan is not more than 5% different to the total area of the Lot as shown on this Identification Plan, the Variation is deemed to be a Permitted Variation and the Buyer cannot Object."

COMMON PROPERTY

□ = Level Above/Below  
CP = Common Property  
B = Balcony

AREA TABLE

LOT	TOTAL AREA
1021	61m <sup>2</sup>
1022	175m <sup>2</sup>
1023	100m <sup>2</sup>
1024	123m <sup>2</sup>
1025	146m <sup>2</sup>
1027	69m <sup>2</sup>

**LEVEL E**

(LEVEL 2)  
SCALE - 1:250

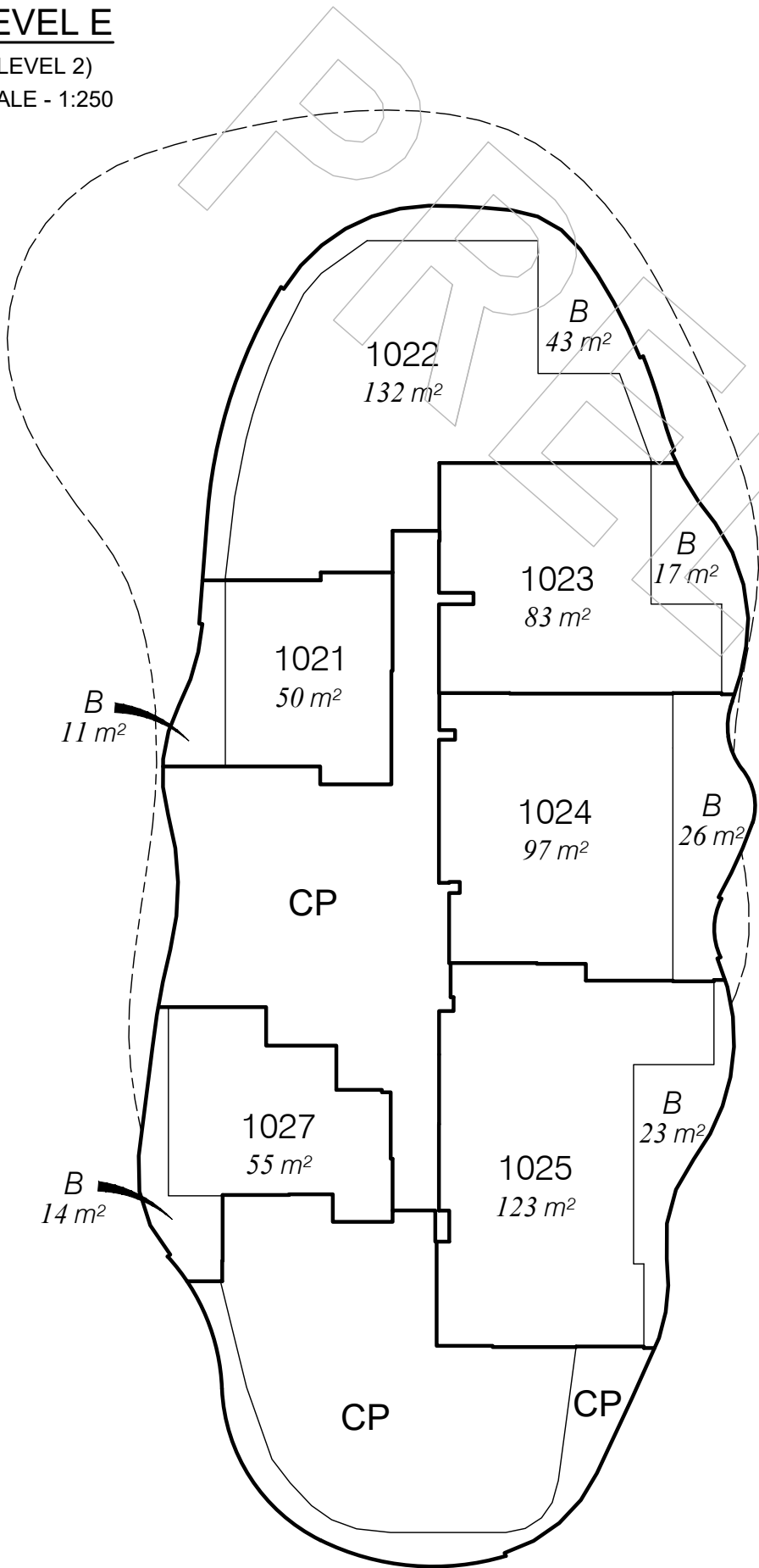

0  
50| mm  
100| mm  
150| mm

Insert  
Plan  
Number  
**SP322426**

State copyright reserved

**LEVEL H**  
(LEVEL 5)

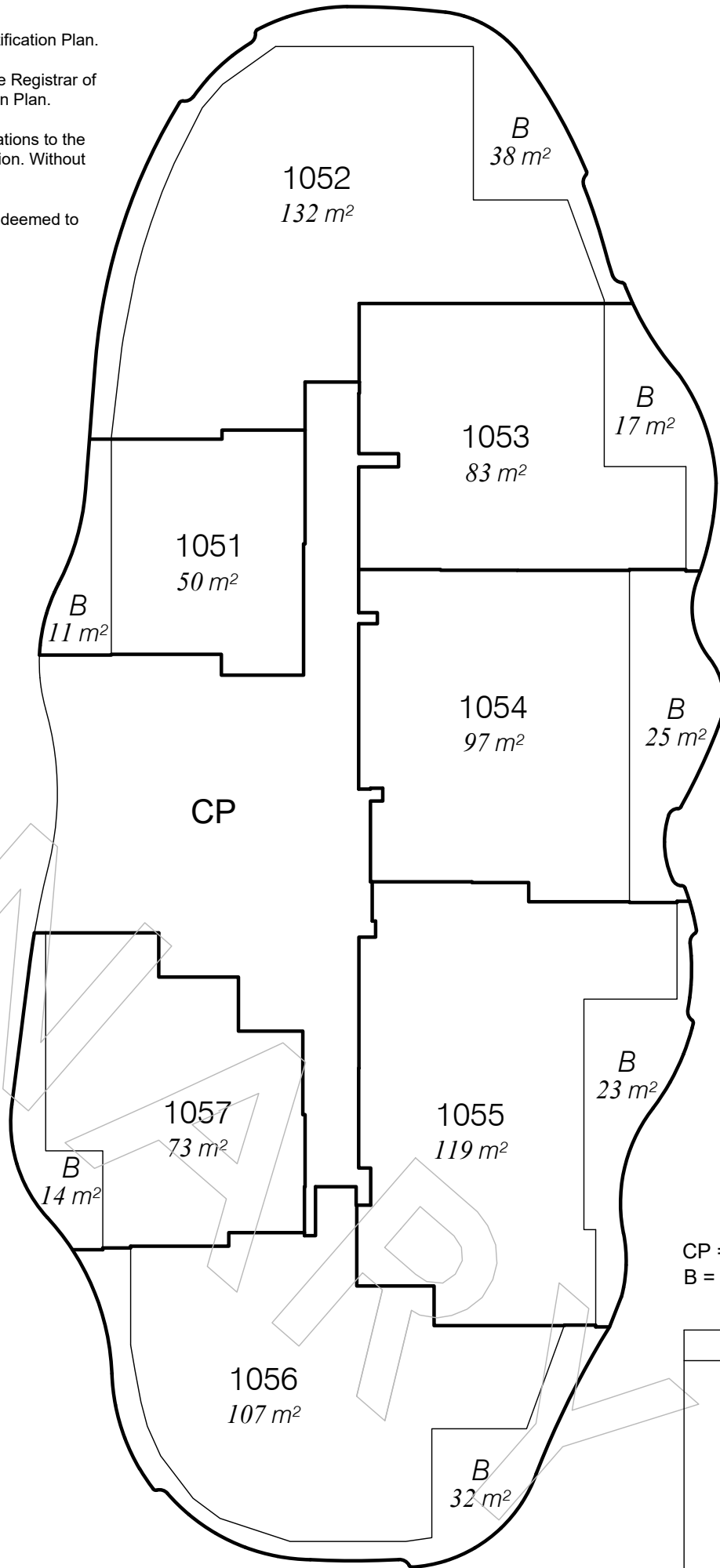

CP = Common Property  
B = Balcony

AREA TABLE

LOT	TOTAL AREA
1051	61m <sup>2</sup>
1052	170m <sup>2</sup>
1053	100m <sup>2</sup>
1054	122m <sup>2</sup>
1055	142m <sup>2</sup>
1056	139m <sup>2</sup>
1057	87m <sup>2</sup>

"Final areas are subject to design changes, Council approval and field survey and may differ from those shown on this Identification Plan.

Final presentation of areas will comply with requirements of the Registrar of Titles and may vary from the format shown on this Identification Plan.

The Seller, under the Contract Terms, is entitled to make Variations to the Lot, including to its location, area, size, dimensions and elevation. Without limitation, if the area of the Lot on the Plan is not more than 5% different to the total area of the Lot as shown on this Identification Plan, the Variation is deemed to be a Permitted Variation and the Buyer cannot Object."

COMMON PROPERTY

CP = Common Property  
B = Balcony

AREA TABLE

LOT	TOTAL AREA
1041	61m <sup>2</sup>
1042	169m <sup>2</sup>
1043	99m <sup>2</sup>
1044	123m <sup>2</sup>
1045	142m <sup>2</sup>
1046	139m <sup>2</sup>
1047	87m <sup>2</sup>

**LEVEL G**  
(LEVEL 4)

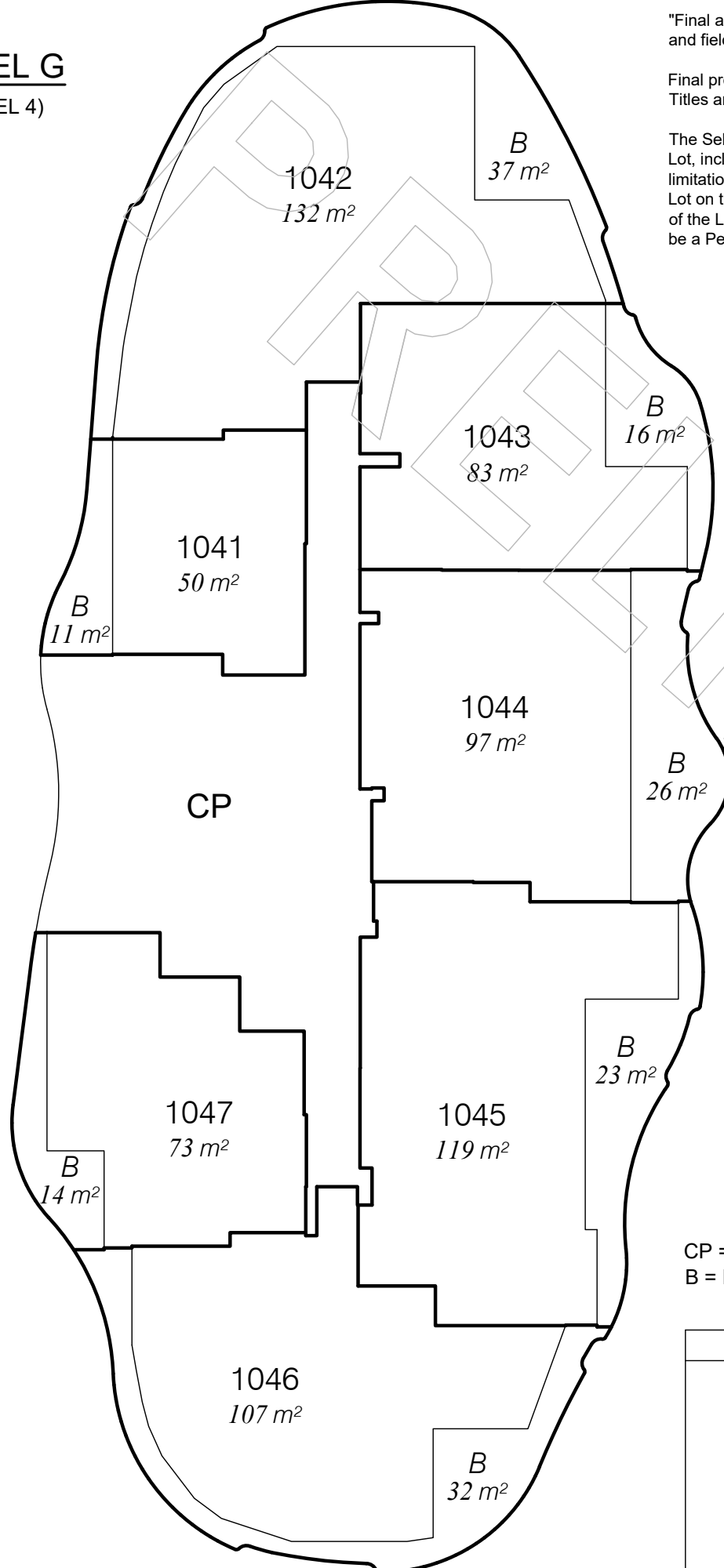

CP

COMMON PROPERTY

CP = Common Property  
B = Balcony

AREA TABLE

LOT	TOTAL AREA
1041	61m <sup>2</sup>
1042	169m <sup>2</sup>
1043	99m <sup>2</sup>
1044	123m <sup>2</sup>
1045	142m <sup>2</sup>
1046	139m <sup>2</sup>
1047	87m <sup>2</sup>

SCALE 1:200

Insert  
Plan  
Number  
**SP322426**

State copyright reserved

0m  
10m  
20m  
30m  
50m  
100m  
150m



**LEVEL J**  
(LEVEL 7)

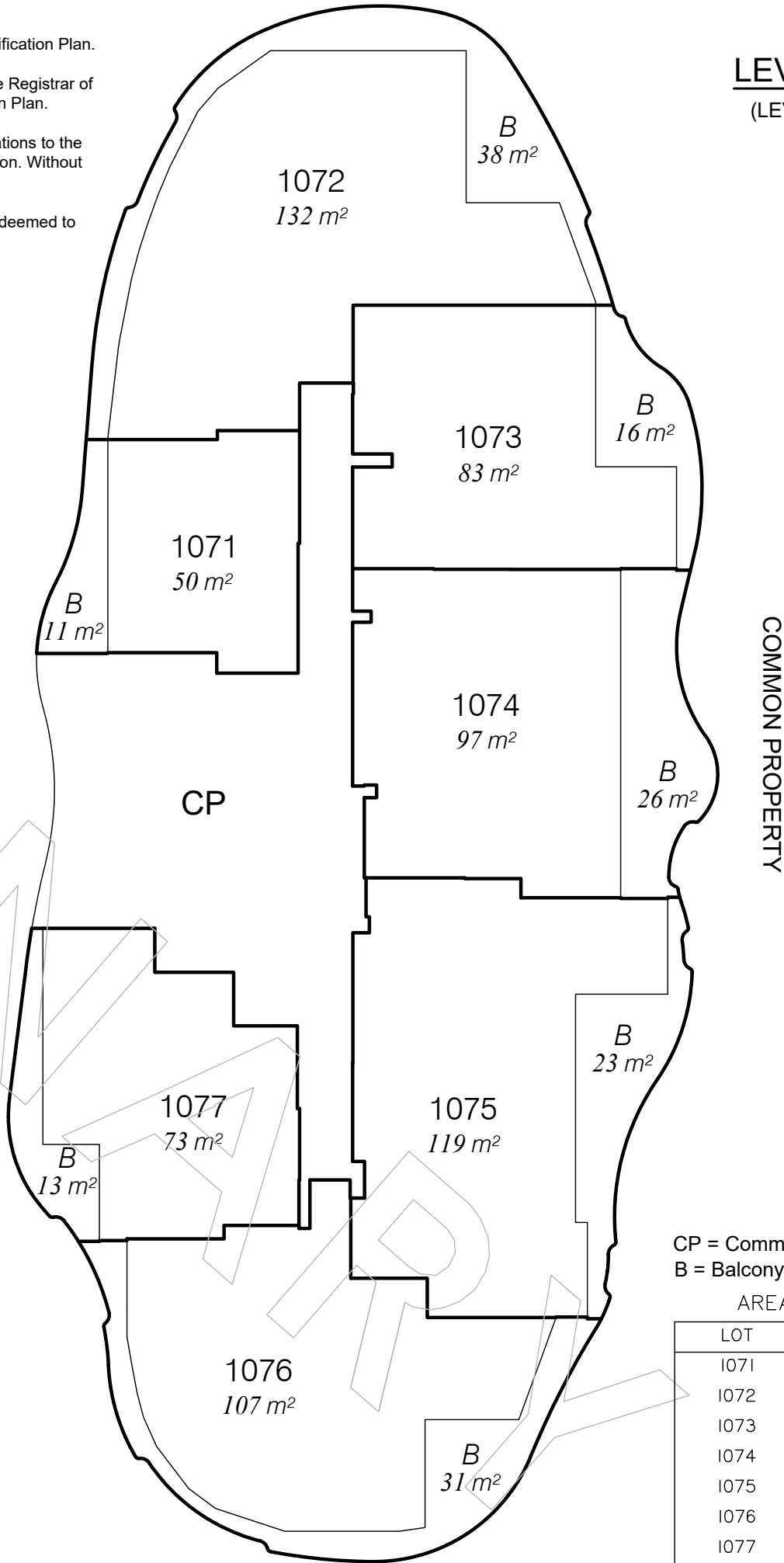

CP = Common Property  
B = Balcony

AREA TABLE

LOT	TOTAL AREA
1071	61m <sup>2</sup>
1072	170m <sup>2</sup>
1073	99m <sup>2</sup>
1074	123m <sup>2</sup>
1075	142m <sup>2</sup>
1076	138m <sup>2</sup>
1077	86m <sup>2</sup>

"Final areas are subject to design changes, Council approval and field survey and may differ from those shown on this Identification Plan.

Final presentation of areas will comply with requirements of the Registrar of Titles and may vary from the format shown on this Identification Plan.

The Seller, under the Contract Terms, is entitled to make Variations to the Lot, including to its location, area, size, dimensions and elevation. Without limitation, if the area of the Lot on the Plan is not more than 5% different to the total area of the Lot as shown on this Identification Plan, the Variation is deemed to be a Permitted Variation and the Buyer cannot Object."

COMMON PROPERTY

CP = Common Property  
B = Balcony

AREA TABLE

LOT	TOTAL AREA
1061	61m <sup>2</sup>
1062	171m <sup>2</sup>
1063	100m <sup>2</sup>
1064	125m <sup>2</sup>
1065	146m <sup>2</sup>
1066	141m <sup>2</sup>
1067	87m <sup>2</sup>

**LEVEL I**  
(LEVEL 6)

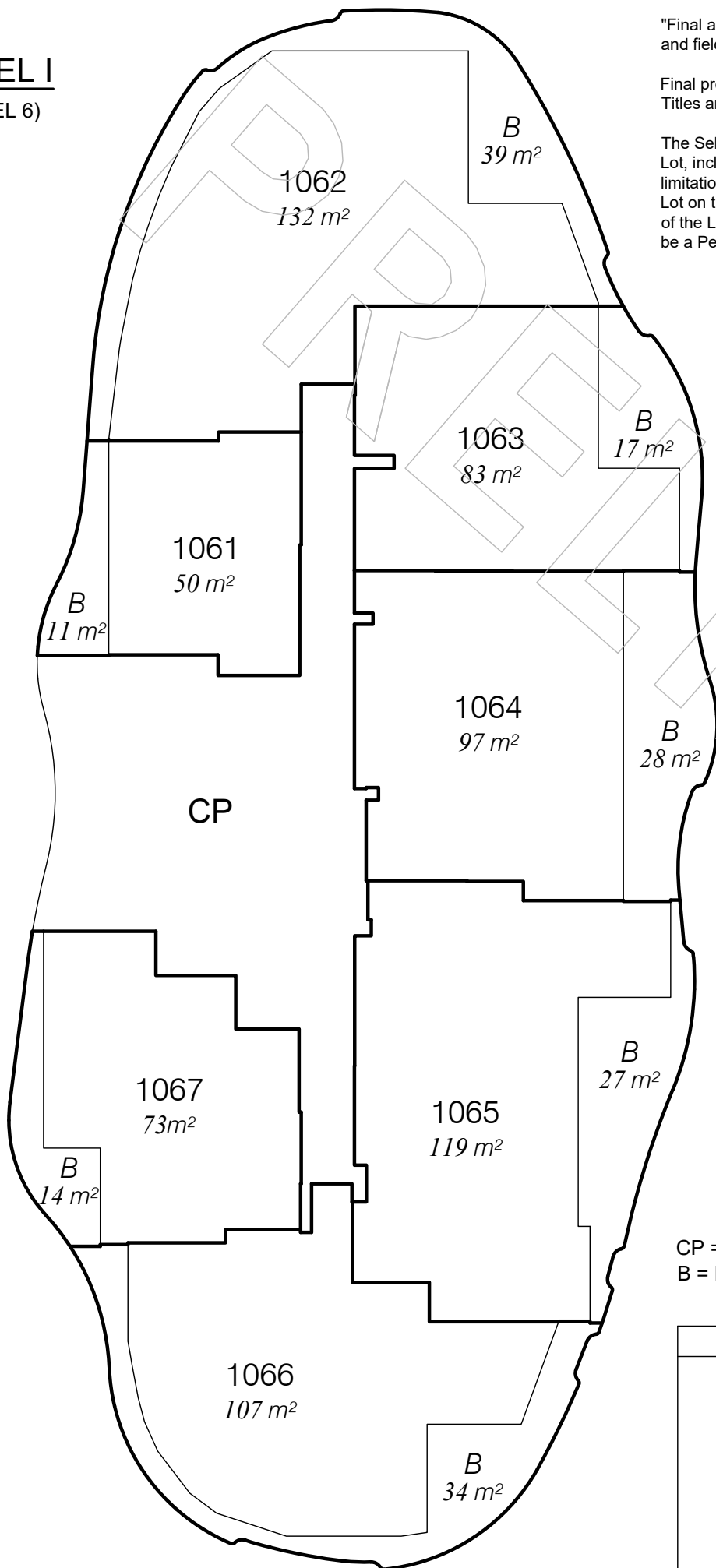

COMMON PROPERTY

CP = Common Property  
B = Balcony

AREA TABLE

LOT	TOTAL AREA
1061	61m <sup>2</sup>
1062	171m <sup>2</sup>
1063	100m <sup>2</sup>
1064	125m <sup>2</sup>
1065	146m <sup>2</sup>
1066	141m <sup>2</sup>
1067	87m <sup>2</sup>

0m  
10m  
20m  
30m  
100mm  
150mm

SCALE 1:200

Insert  
Plan  
Number  
**SP322426**

State copyright reserved

**LEVEL L**  
(LEVEL 9)

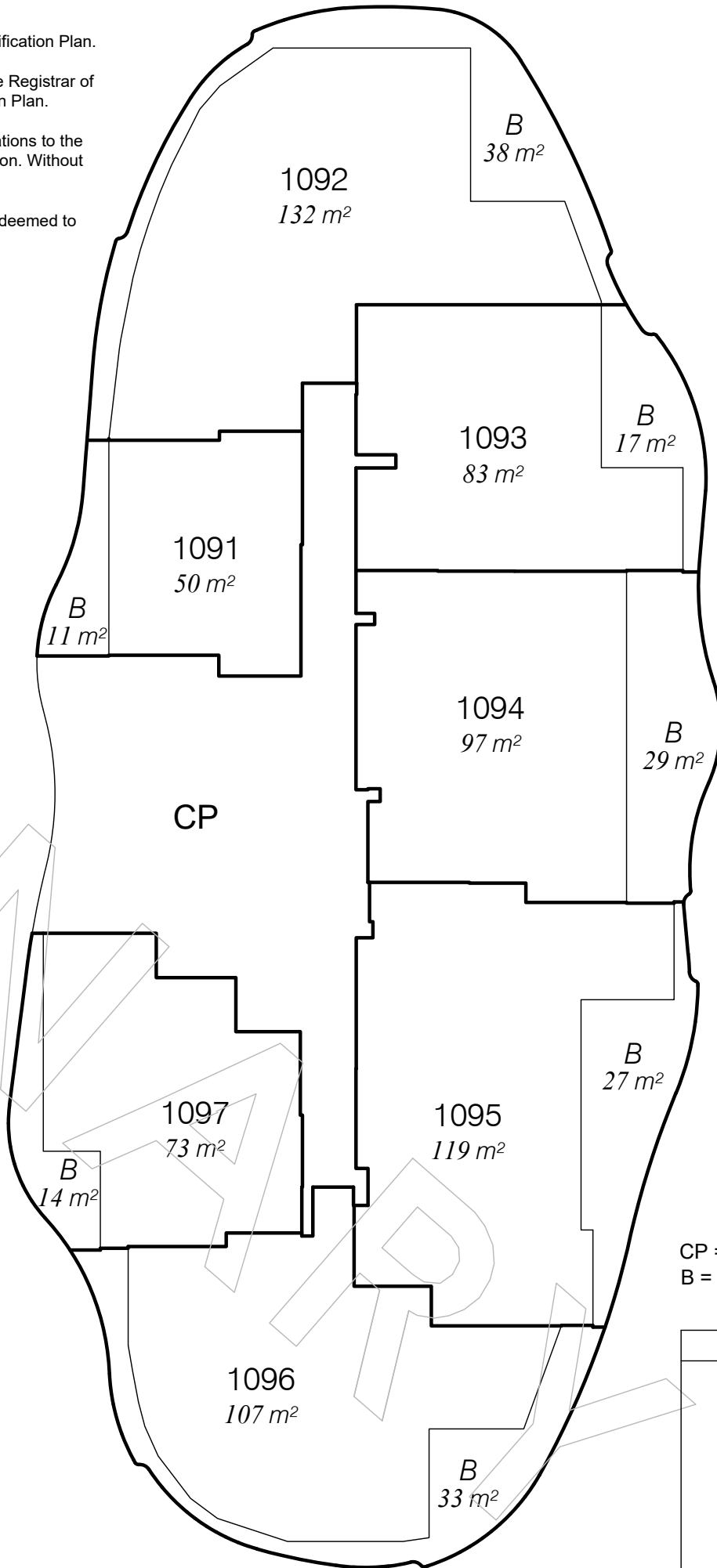

CP = Common Property  
B = Balcony

AREA TABLE

LOT	TOTAL AREA
1091	61m <sup>2</sup>
1092	170m <sup>2</sup>
1093	100m <sup>2</sup>
1094	126m <sup>2</sup>
1095	146m <sup>2</sup>
1096	140m <sup>2</sup>
1097	87m <sup>2</sup>

"Final areas are subject to design changes, Council approval and field survey and may differ from those shown on this Identification Plan.

Final presentation of areas will comply with requirements of the Registrar of Titles and may vary from the format shown on this Identification Plan.

The Seller, under the Contract Terms, is entitled to make Variations to the Lot, including to its location, area, size, dimensions and elevation. Without limitation, if the area of the Lot on the Plan is not more than 5% different to the total area of the Lot as shown on this Identification Plan, the Variation is deemed to be a Permitted Variation and the Buyer cannot Object."

COMMON PROPERTY

CP = Common Property  
B = Balcony

AREA TABLE

LOT	TOTAL AREA
1081	61m <sup>2</sup>
1082	170m <sup>2</sup>
1083	100m <sup>2</sup>
1084	122m <sup>2</sup>
1085	142m <sup>2</sup>
1086	138m <sup>2</sup>
1087	87m <sup>2</sup>

**LEVEL K**  
(LEVEL 8)

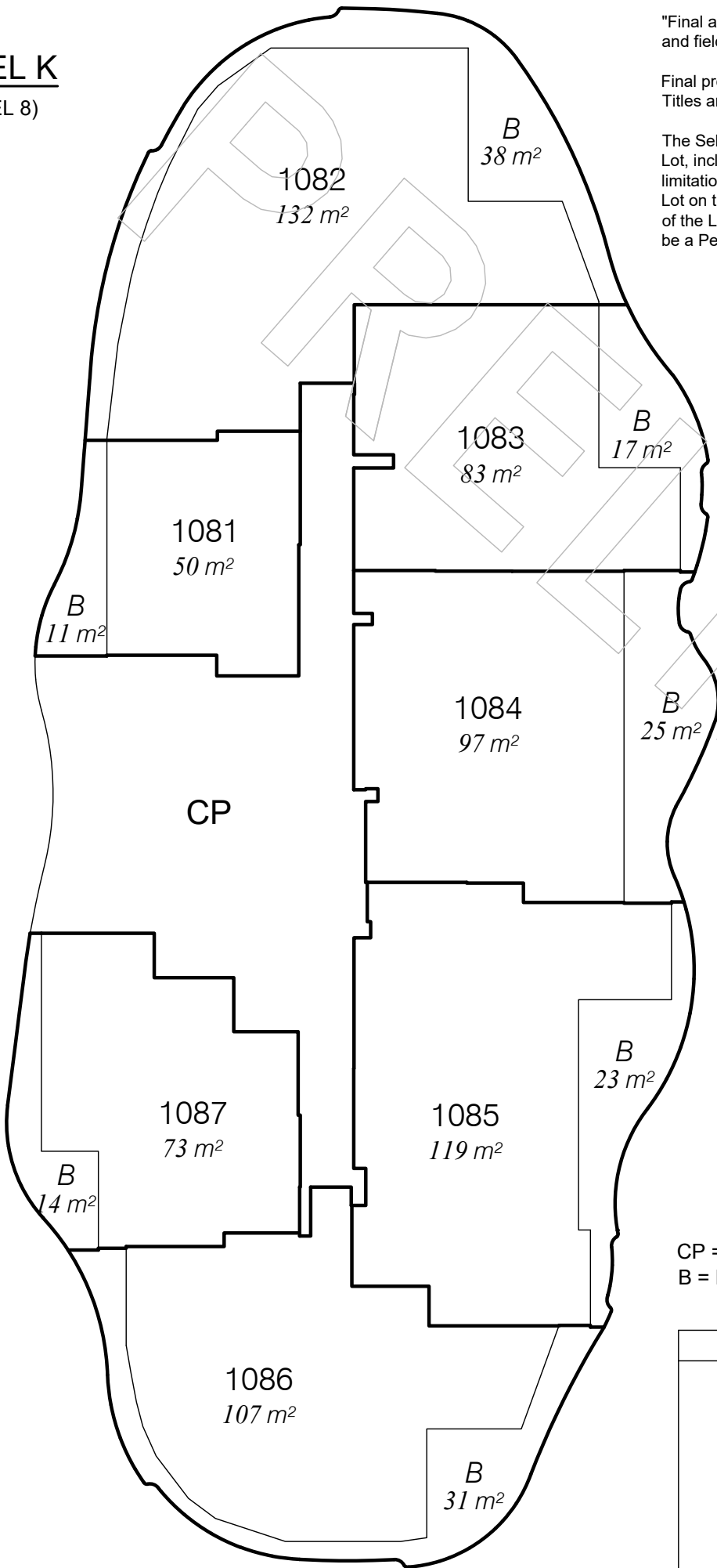

SCALE 1:200

Insert  
Plan  
Number  
**SP322426**

State copyright reserved



**LEVEL N**  
(LEVEL 11)

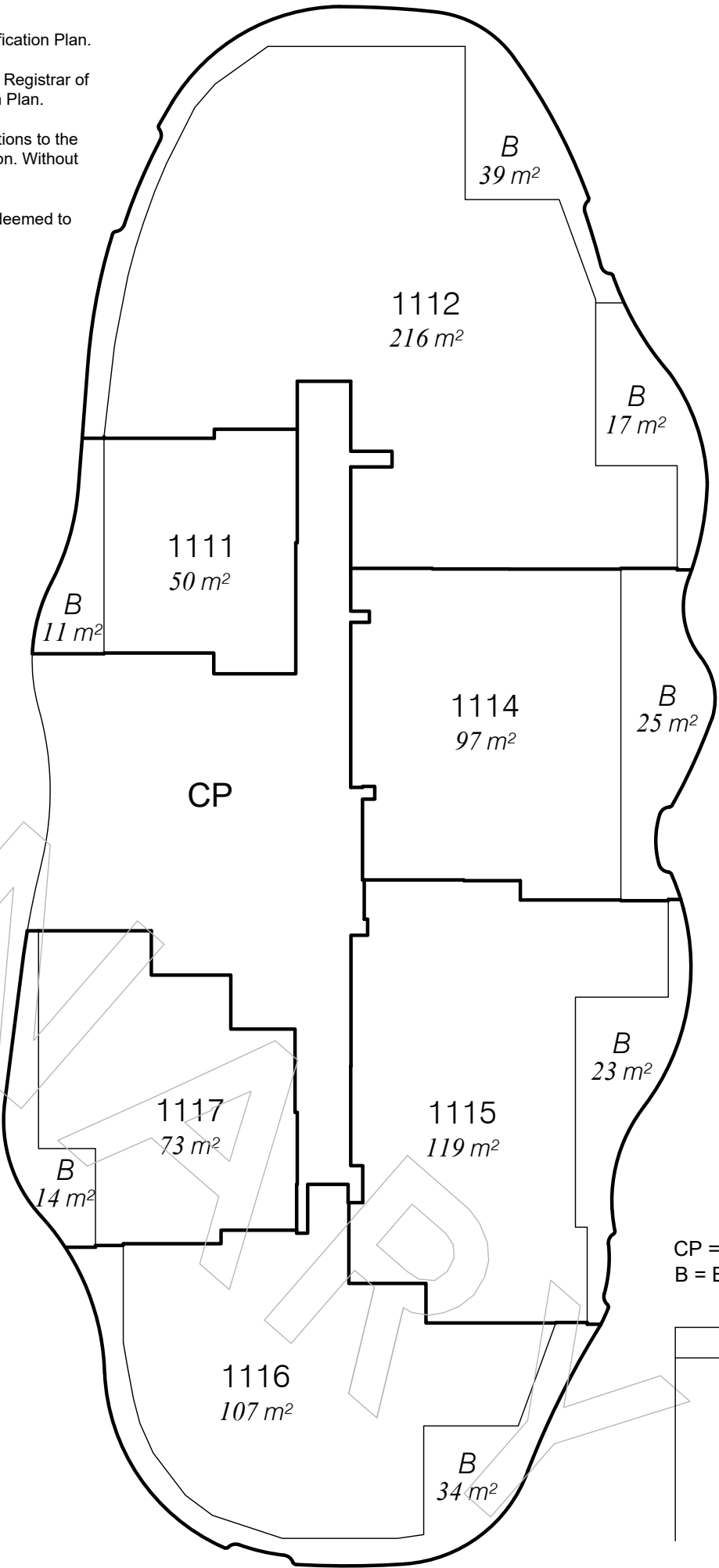

CP = Common Property  
B = Balcony

AREA TABLE

LOT	TOTAL AREA
1111	61m <sup>2</sup>
1112	272m <sup>2</sup>
1114	122m <sup>2</sup>
1115	142m <sup>2</sup>
1116	141m <sup>2</sup>
1117	87m <sup>2</sup>

"Final areas are subject to design changes, Council approval and field survey and may differ from those shown on this Identification Plan.  
Final presentation of areas will comply with requirements of the Registrar of Titles and may vary from the format shown on this Identification Plan.

The Seller, under the Contract Terms, is entitled to make Variations to the Lot, including to its location, area, size, dimensions and elevation. Without limitation, if the area of the Lot on the Plan is not more than 5% different to the total area of the Lot as shown on this Identification Plan, the Variation is deemed to be a Permitted Variation and the Buyer cannot Object."

COMMON PROPERTY

CP = Common Property  
B = Balcony

AREA TABLE

LOT	TOTAL AREA
1101	61m <sup>2</sup>
1102	169m <sup>2</sup>
1103	222m <sup>2</sup>
1105	143m <sup>2</sup>
1106	139m <sup>2</sup>
1107	87m <sup>2</sup>

**LEVEL M**  
(LEVEL 10)

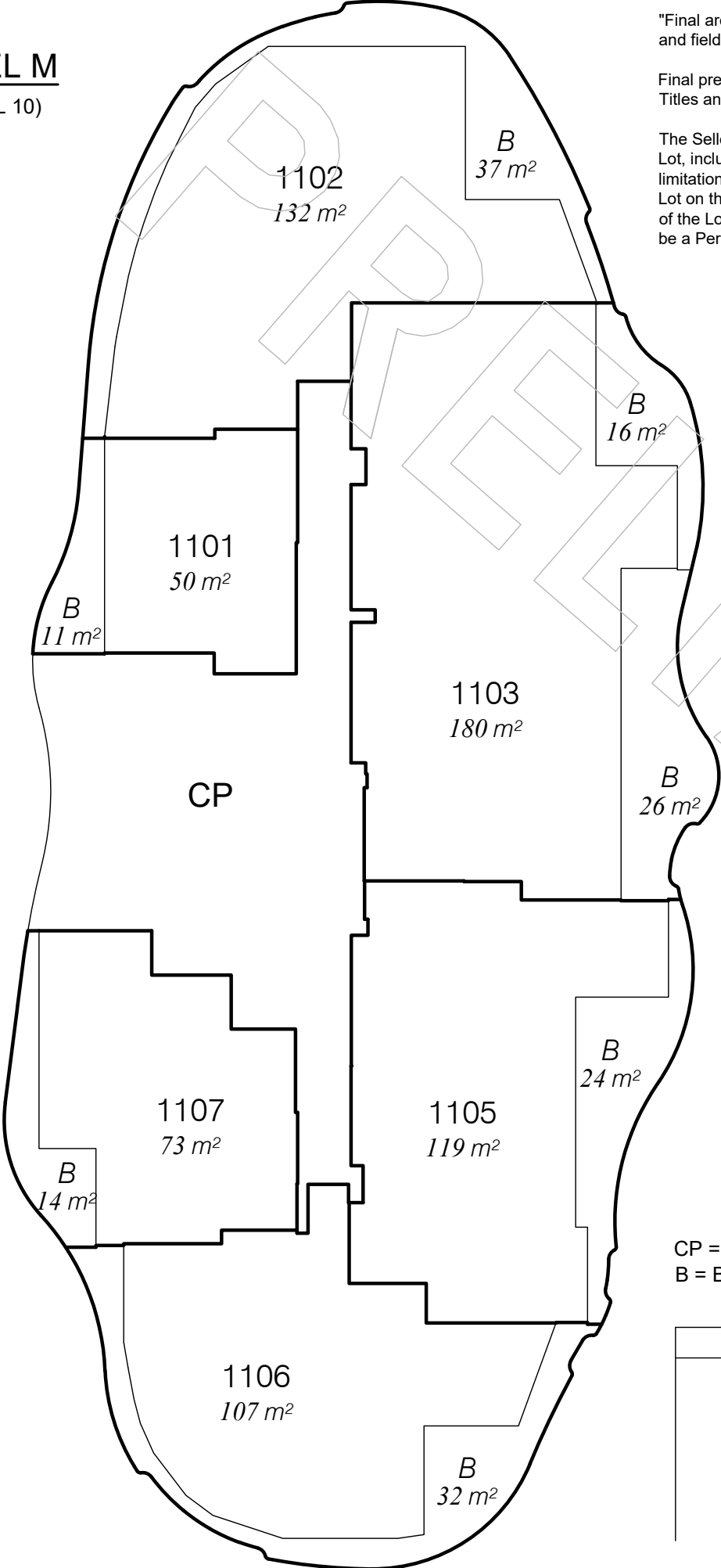

COMMON PROPERTY

CP = Common Property  
B = Balcony

AREA TABLE

LOT	TOTAL AREA
1101	61m <sup>2</sup>
1102	169m <sup>2</sup>
1103	222m <sup>2</sup>
1105	143m <sup>2</sup>
1106	139m <sup>2</sup>
1107	87m <sup>2</sup>

0m  
10m  
20m  
30m  
50m  
100m  
150m

SCALE 1:200

Insert  
Plan  
Number  
**SP322426**

State copyright reserved

**LEVEL P**  
(LEVEL 13)

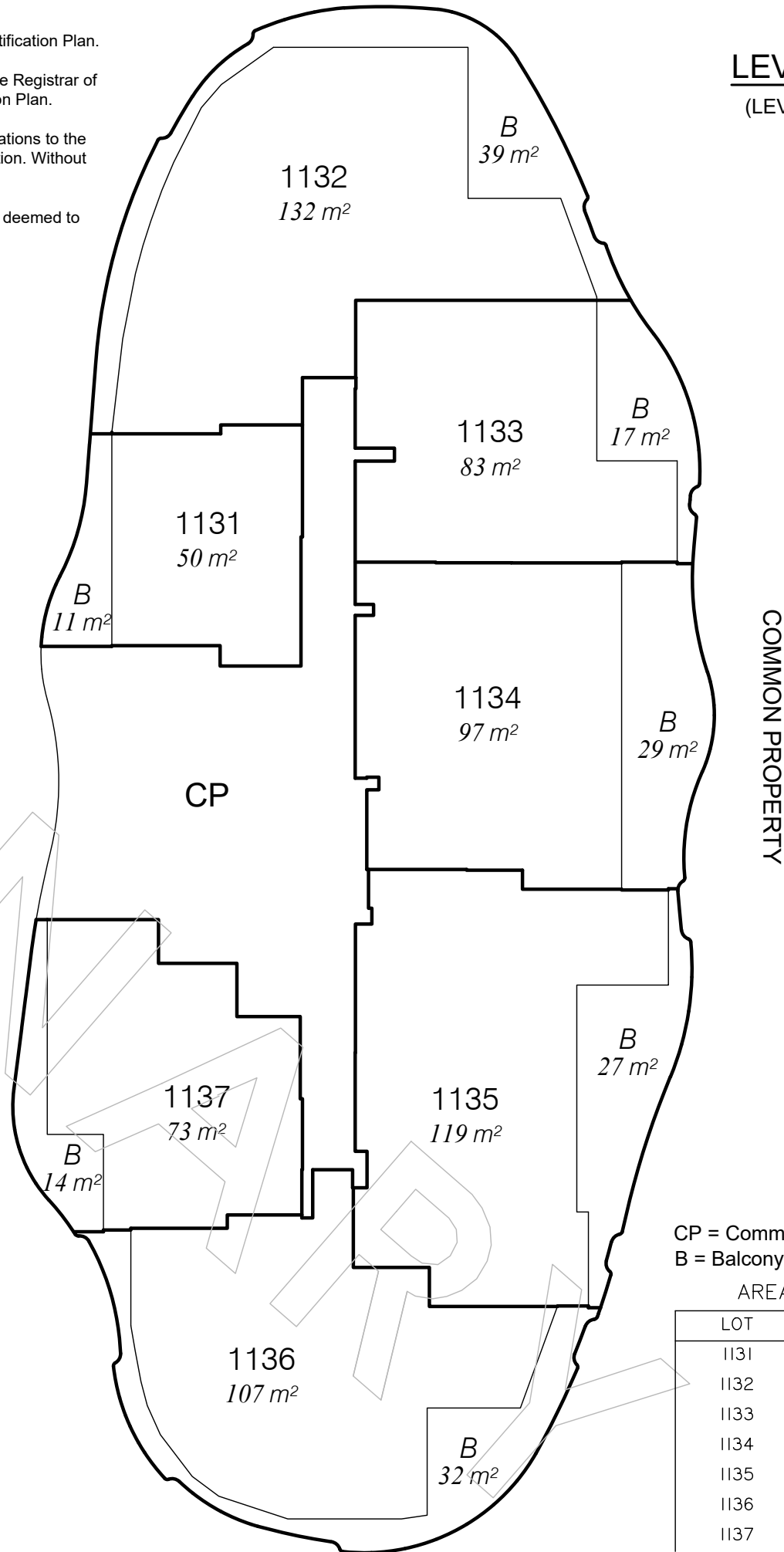

CP = Common Property  
B = Balcony

AREA TABLE

LOT	TOTAL AREA
1131	61m <sup>2</sup>
1132	171m <sup>2</sup>
1133	100m <sup>2</sup>
1134	126m <sup>2</sup>
1135	146m <sup>2</sup>
1136	139m <sup>2</sup>
1137	87m <sup>2</sup>

"Final areas are subject to design changes, Council approval and field survey and may differ from those shown on this Identification Plan.

Final presentation of areas will comply with requirements of the Registrar of Titles and may vary from the format shown on this Identification Plan.

The Seller, under the Contract Terms, is entitled to make Variations to the Lot, including to its location, area, size, dimensions and elevation. Without limitation, if the area of the Lot on the Plan is not more than 5% different to the total area of the Lot as shown on this Identification Plan, the Variation is deemed to be a Permitted Variation and the Buyer cannot Object."

COMMON PROPERTY

**LEVEL O**  
(LEVEL 12)

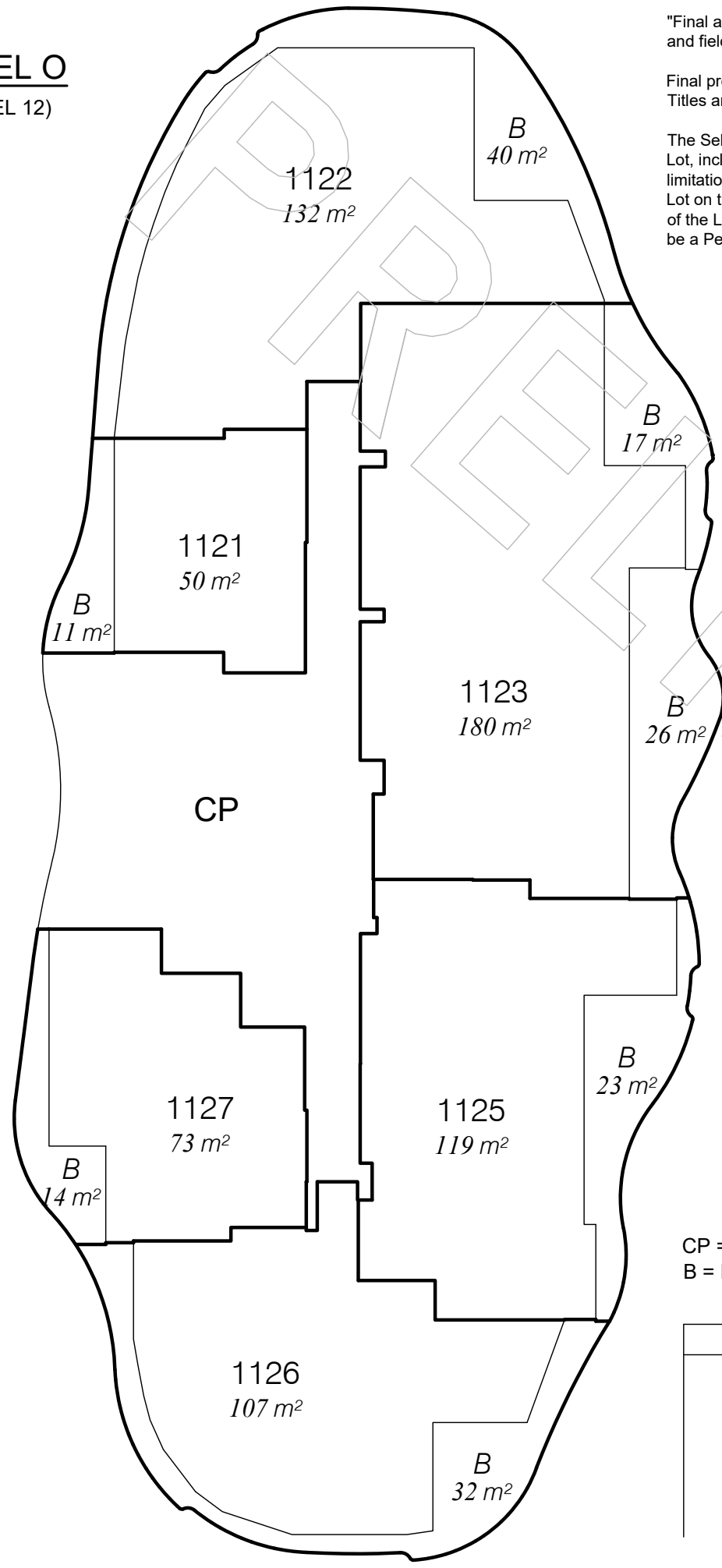

CP = Common Property  
B = Balcony

AREA TABLE

LOT	TOTAL AREA
1121	61m <sup>2</sup>
1122	172m <sup>2</sup>
1123	223m <sup>2</sup>
1125	142m <sup>2</sup>
1126	139m <sup>2</sup>
1127	87m <sup>2</sup>

0m  
10m  
20m  
30m  
50m  
100m  
150m

SCALE 1:200

Insert  
Plan  
Number  
**SP322426**

State copyright reserved

**LEVEL R**  
(LEVEL 15)

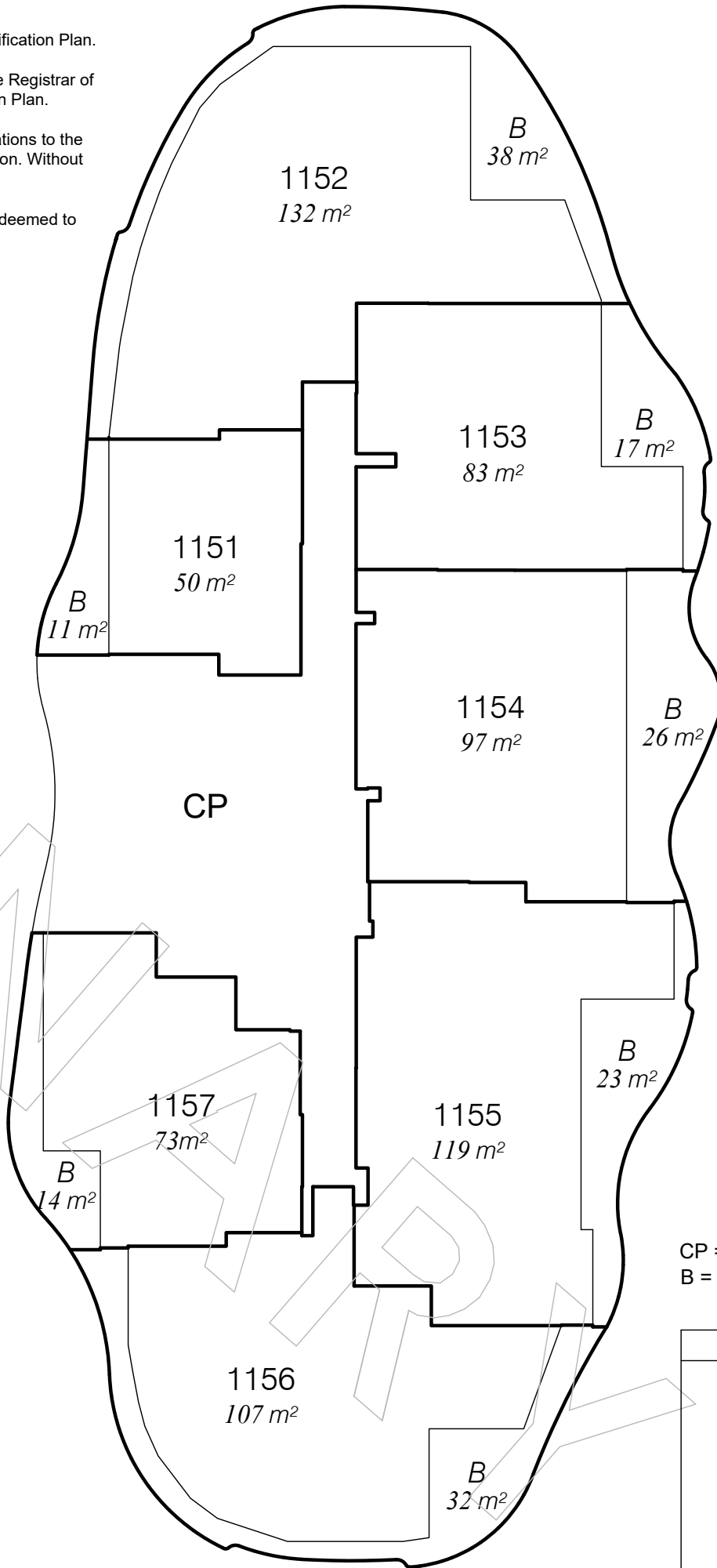

CP = Common Property  
B = Balcony

AREA TABLE

LOT	TOTAL AREA
1151	61m <sup>2</sup>
1152	170m <sup>2</sup>
1153	100m <sup>2</sup>
1154	123m <sup>2</sup>
1155	142m <sup>2</sup>
1156	139m <sup>2</sup>
1157	87m <sup>2</sup>

"Final areas are subject to design changes, Council approval and field survey and may differ from those shown on this Identification Plan.

Final presentation of areas will comply with requirements of the Registrar of Titles and may vary from the format shown on this Identification Plan.

The Seller, under the Contract Terms, is entitled to make Variations to the Lot, including to its location, area, size, dimensions and elevation. Without limitation, if the area of the Lot on the Plan is not more than 5% different to the total area of the Lot as shown on this Identification Plan, the Variation is deemed to be a Permitted Variation and the Buyer cannot Object."

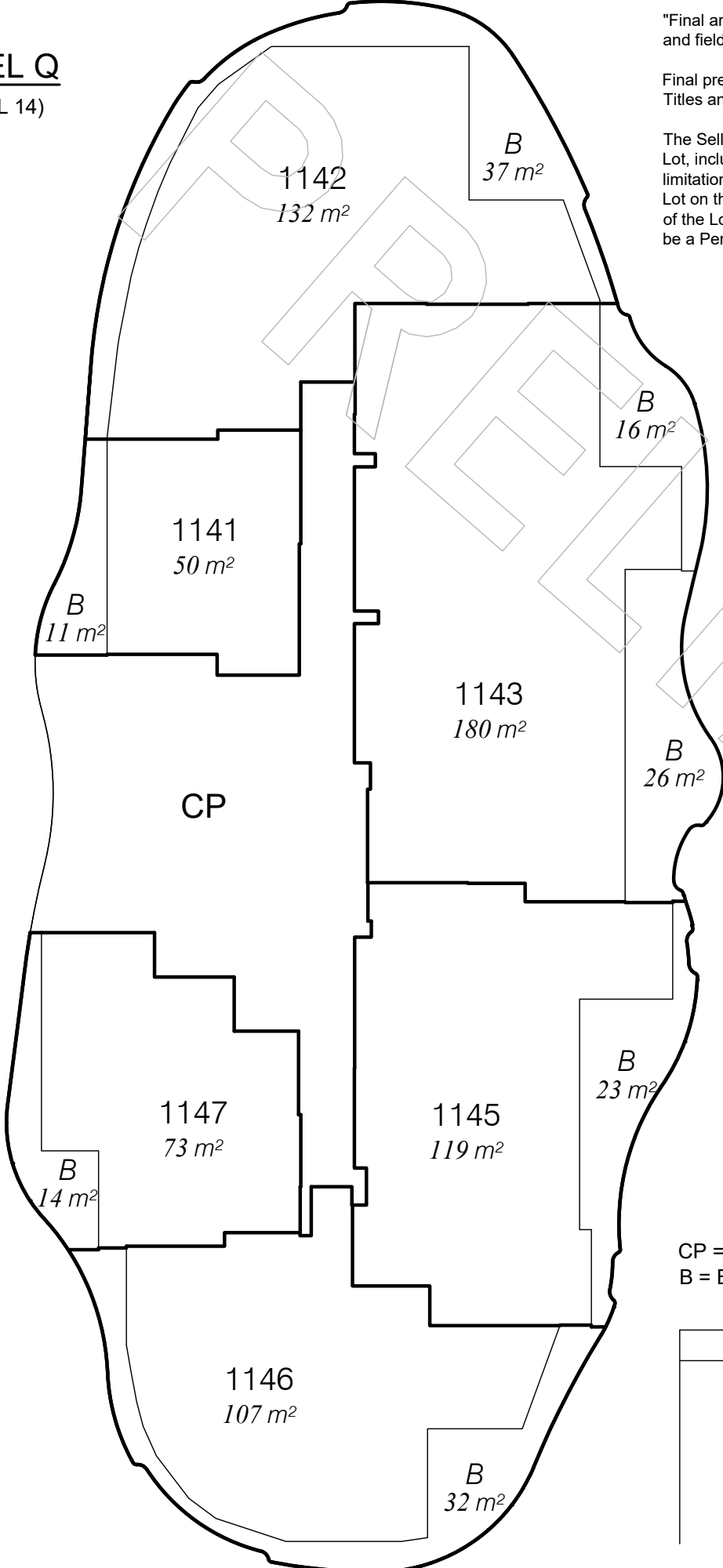

CP = Common Property  
B = Balcony

AREA TABLE

LOT	TOTAL AREA
1141	61m <sup>2</sup>
1142	169m <sup>2</sup>
1143	222m <sup>2</sup>
1145	142m <sup>2</sup>
1146	139m <sup>2</sup>
1147	87m <sup>2</sup>

**LEVEL Q**  
(LEVEL 14)

0m  
10m  
20m  
30m  
50m  
100m  
150m

SCALE 1:200

Insert  
Plan  
Number  
**SP322426**

State copyright reserved

**LEVEL T**  
(LEVEL 17)

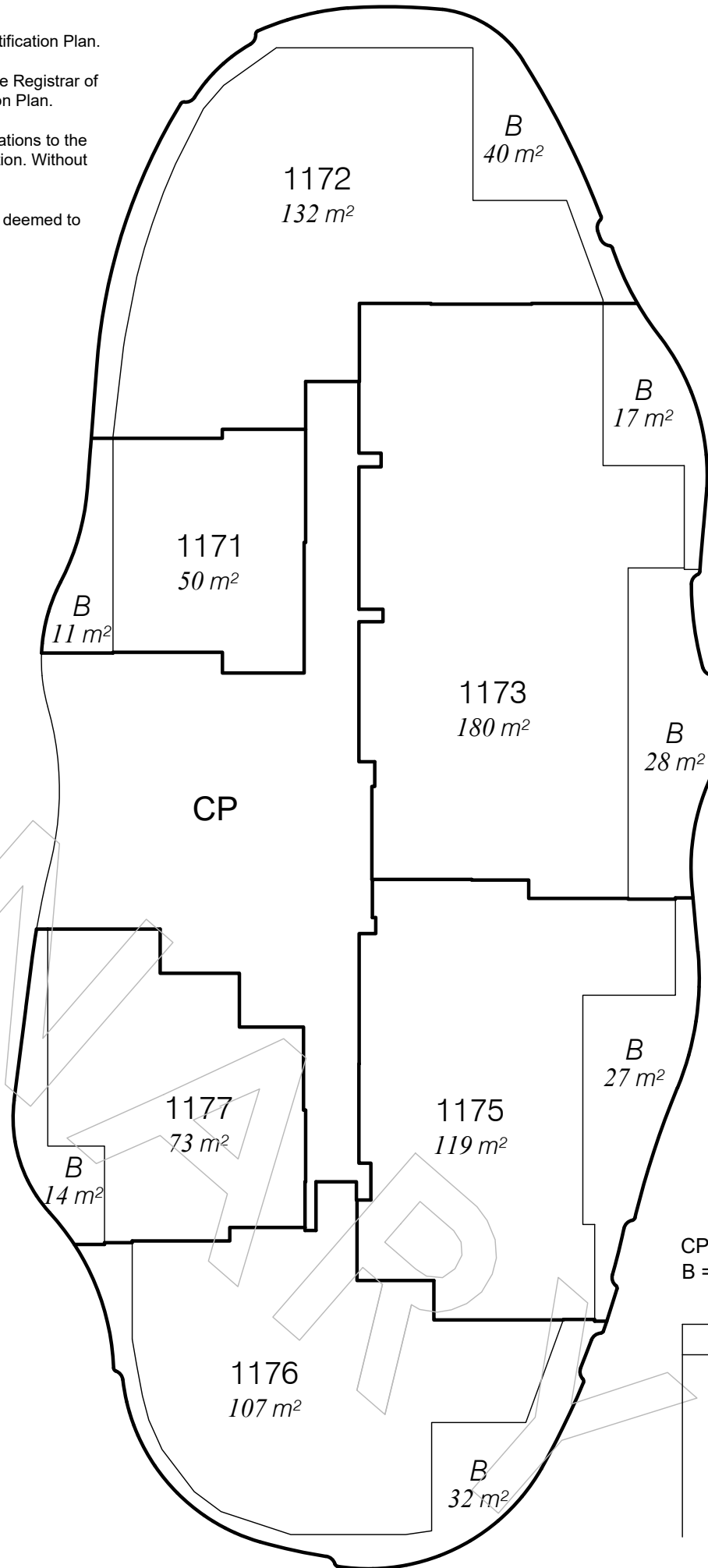

CP = Common Property  
B = Balcony

AREA TABLE

LOT	TOTAL AREA
1171	61m <sup>2</sup>
1172	172m <sup>2</sup>
1173	225m <sup>2</sup>
1175	146m <sup>2</sup>
1176	139m <sup>2</sup>
1177	87m <sup>2</sup>

"Final areas are subject to design changes, Council approval and field survey and may differ from those shown on this Identification Plan.

Final presentation of areas will comply with requirements of the Registrar of Titles and may vary from the format shown on this Identification Plan.

The Seller, under the Contract Terms, is entitled to make Variations to the Lot, including to its location, area, size, dimensions and elevation. Without limitation, if the area of the Lot on the Plan is not more than 5% different to the total area of the Lot as shown on this Identification Plan, the Variation is deemed to be a Permitted Variation and the Buyer cannot Object."

COMMON PROPERTY

CP = Common Property  
B = Balcony

**LEVEL S**  
(LEVEL 16)

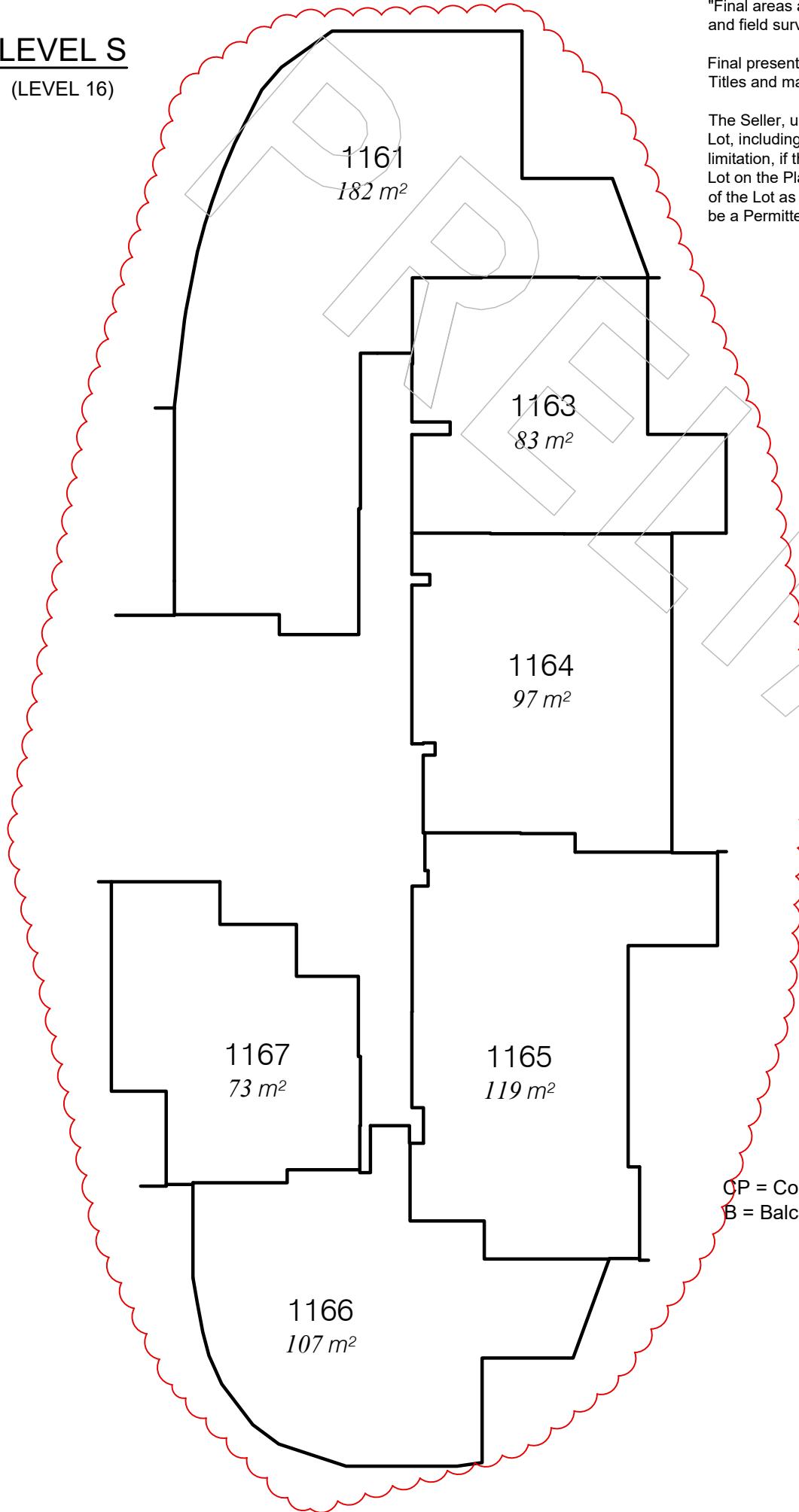

0m  
10m  
20m  
30m  
50m  
100m  
150m

SCALE 1:200

Insert  
Plan  
Number  
**SP322426**

State copyright reserved

**LEVEL V**  
(LEVEL 19)

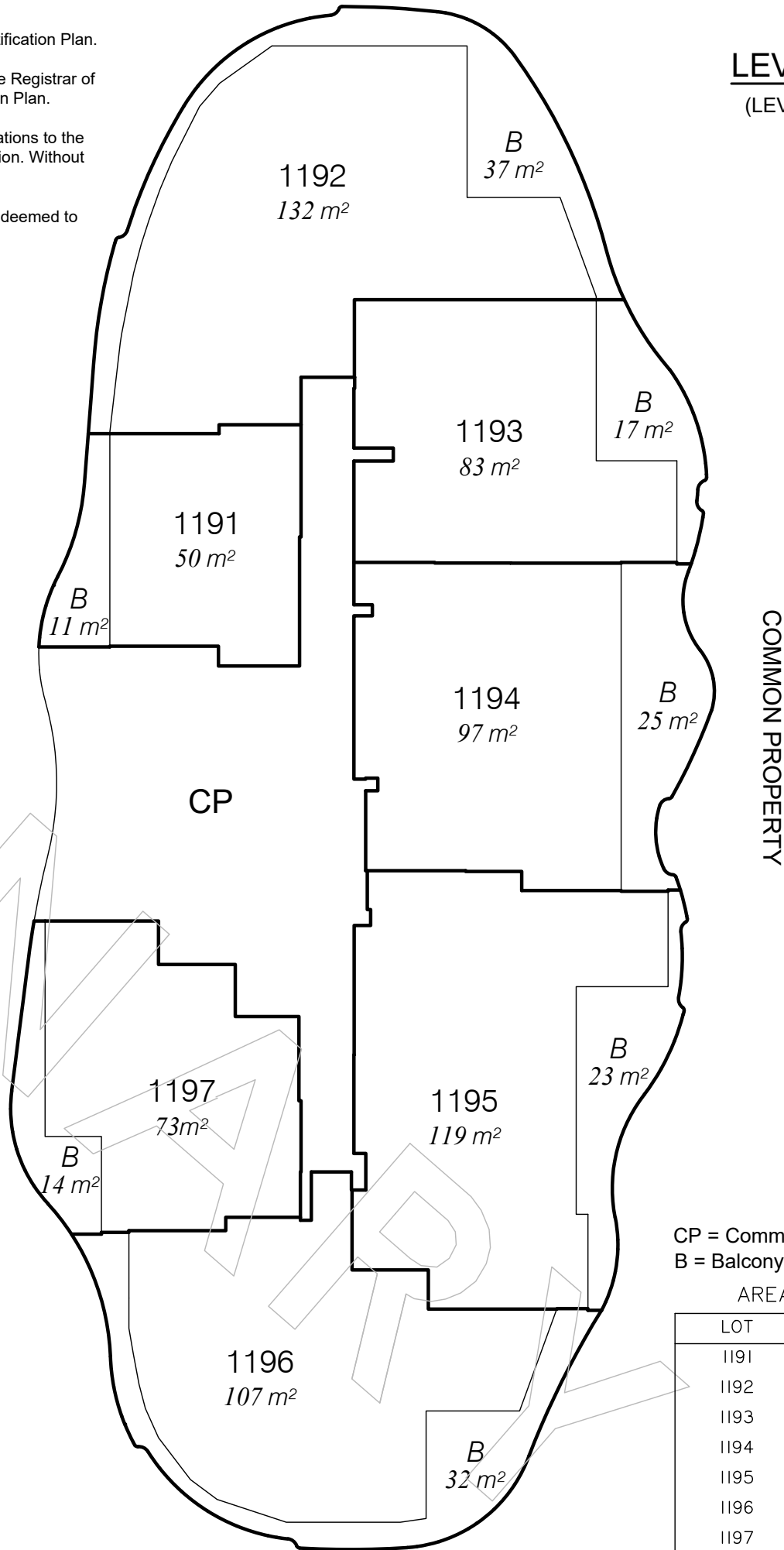

"Final areas are subject to design changes, Council approval and field survey and may differ from those shown on this Identification Plan.

Final presentation of areas will comply with requirements of the Registrar of Titles and may vary from the format shown on this Identification Plan.

The Seller, under the Contract Terms, is entitled to make Variations to the Lot, including to its location, area, size, dimensions and elevation. Without limitation, if the area of the Lot on the Plan is not more than 5% different to the total area of the Lot as shown on this Identification Plan, the Variation is deemed to be a Permitted Variation and the Buyer cannot Object."

**LEVEL U**  
(LEVEL 18)

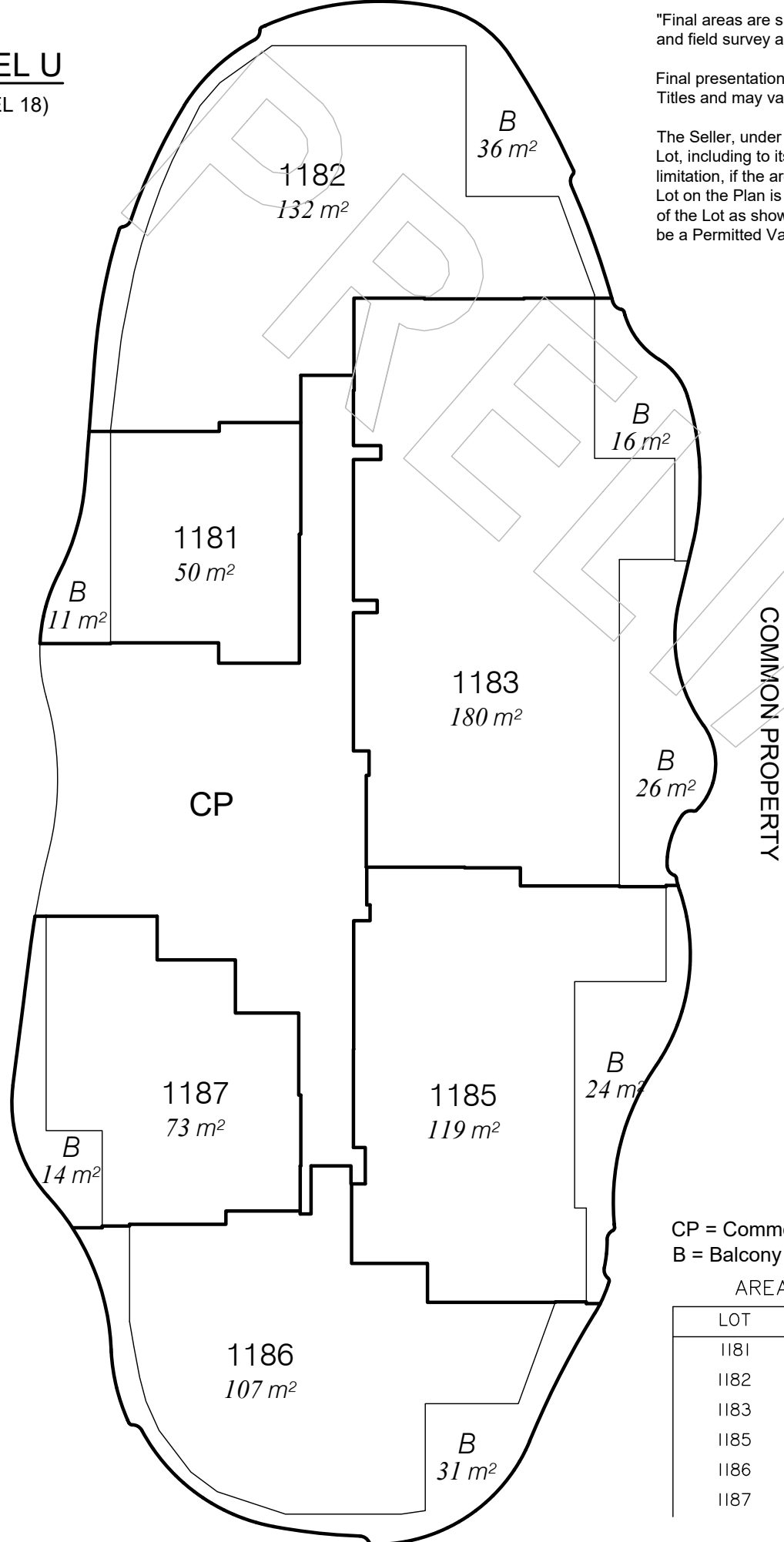

**LEVEL X**  
(LEVEL 21)

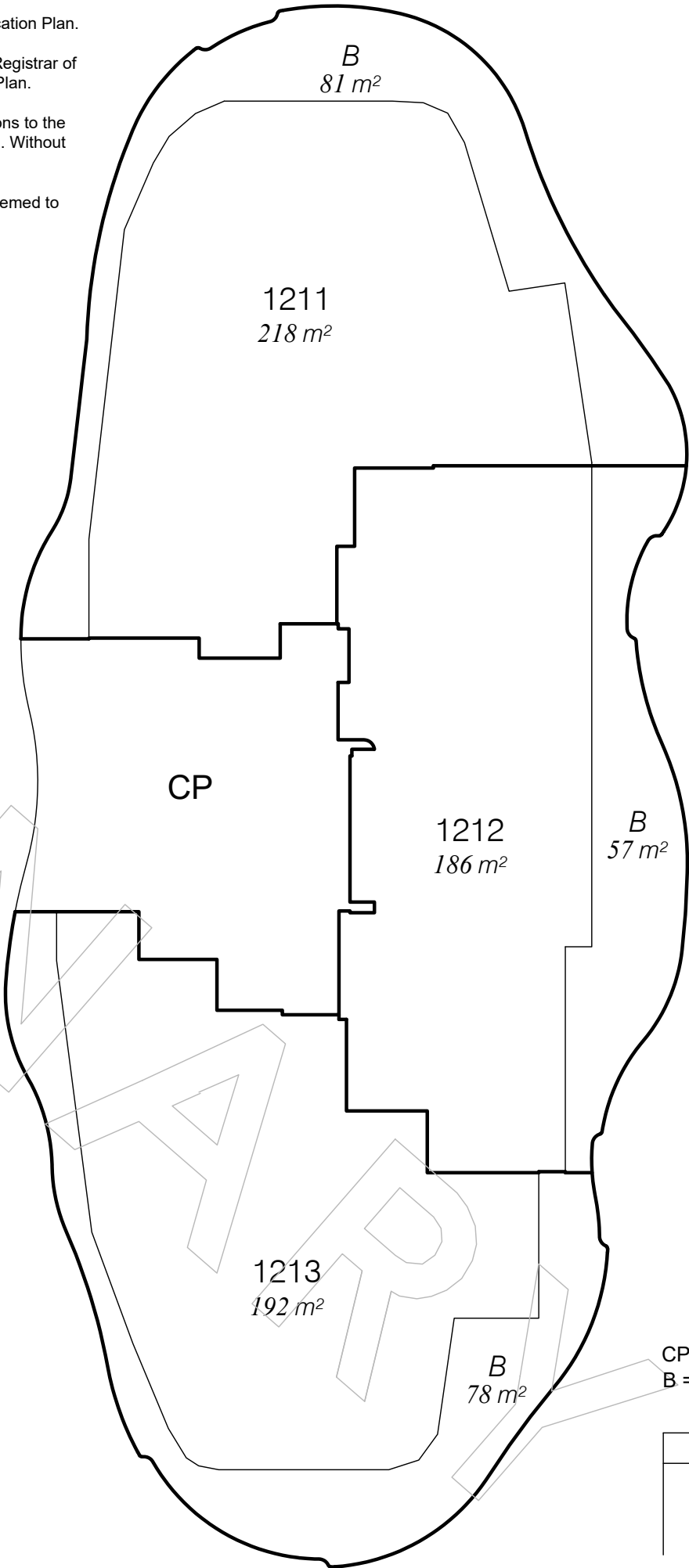

CP = Common Property  
B = Balcony

AREA TABLE

LOT	TOTAL AREA
1211	299m <sup>2</sup>
1212	243m <sup>2</sup>
1213	270m <sup>2</sup>

"Final areas are subject to design changes, Council approval and field survey and may differ from those shown on this Identification Plan.  
Final presentation of areas will comply with requirements of the Registrar of Titles and may vary from the format shown on this Identification Plan.

The Seller, under the Contract Terms, is entitled to make Variations to the Lot, including to its location, area, size, dimensions and elevation. Without limitation, if the area of the Lot on the Plan is not more than 5% different to the total area of the Lot as shown on this Identification Plan, the Variation is deemed to be a Permitted Variation and the Buyer cannot Object."

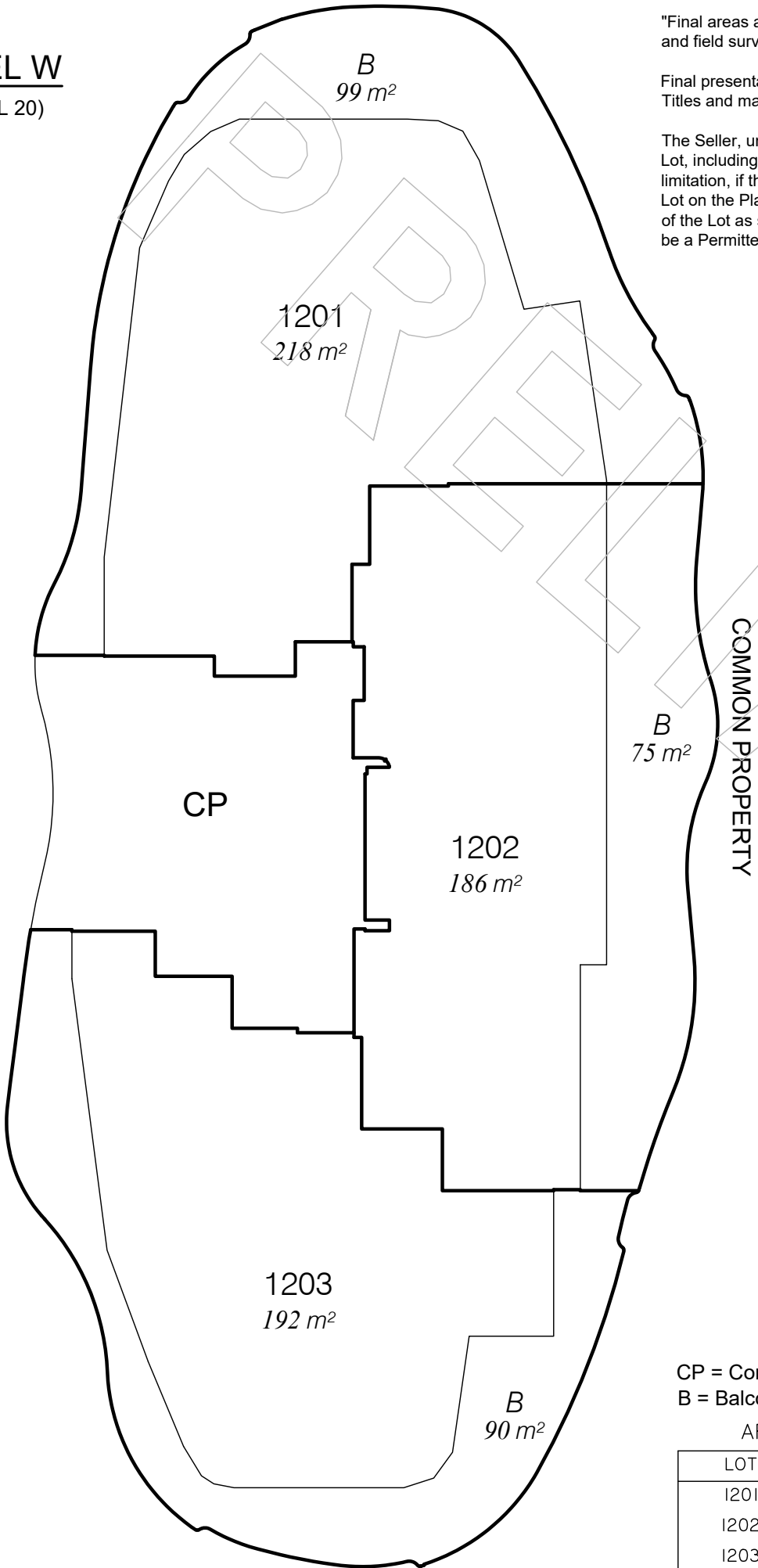

CP = Common Property  
B = Balcony

AREA TABLE

LOT	TOTAL AREA
1201	317m <sup>2</sup>
1202	261m <sup>2</sup>
1203	282m <sup>2</sup>

**LEVEL W**  
(LEVEL 20)

0m  
10m  
20m  
30m  
50m  
100m  
150m

SCALE 1:200

Insert  
Plan  
Number  
**SP322426**

State copyright reserved

**LEVEL Z**  
(LEVEL 23)

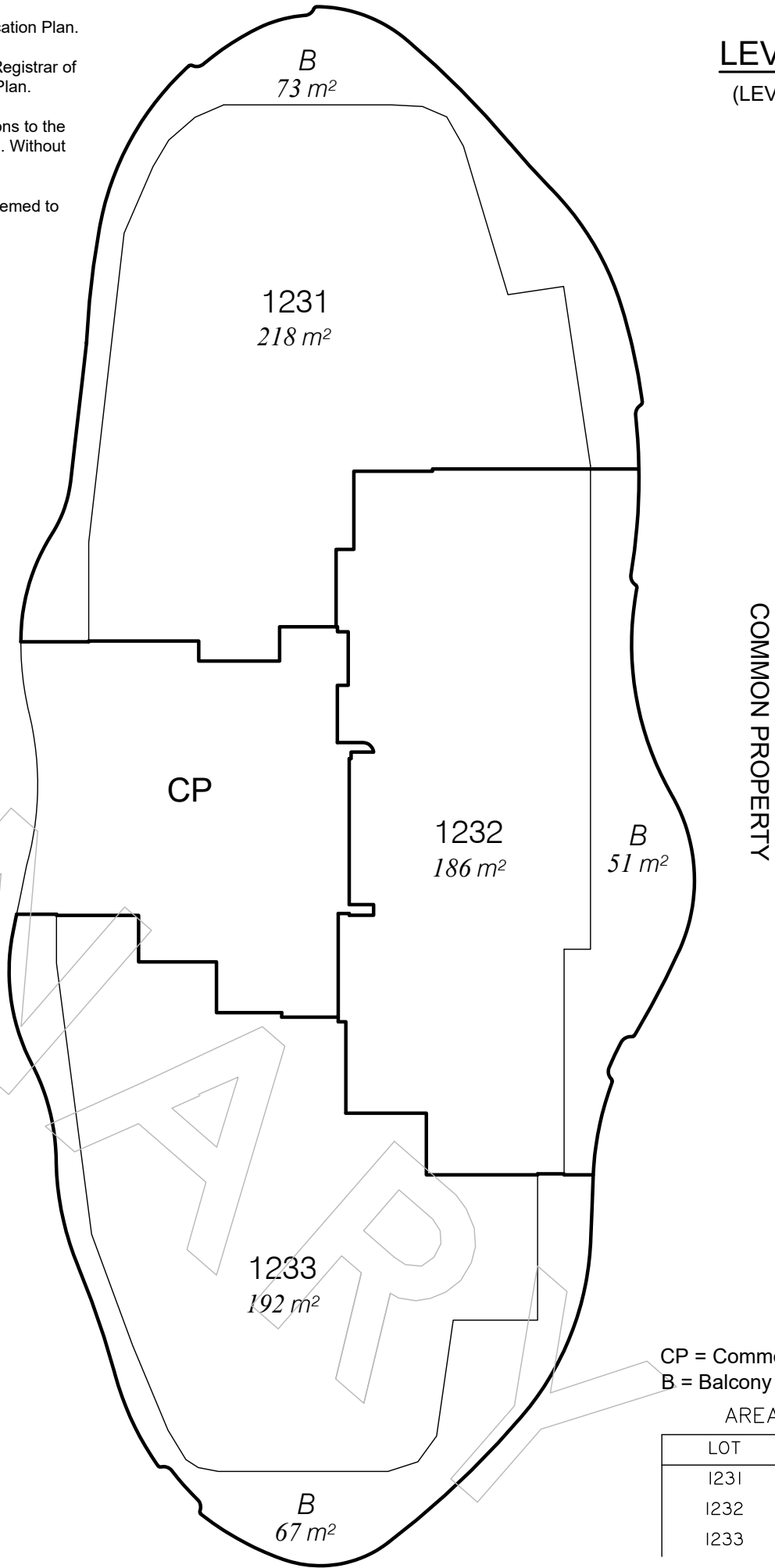

CP = Common Property  
B = Balcony

AREA TABLE

LOT	TOTAL AREA
1231	291m <sup>2</sup>
1232	237m <sup>2</sup>
1233	259m <sup>2</sup>

"Final areas are subject to design changes, Council approval and field survey and may differ from those shown on this Identification Plan.  
Final presentation of areas will comply with requirements of the Registrar of Titles and may vary from the format shown on this Identification Plan.

The Seller, under the Contract Terms, is entitled to make Variations to the Lot, including to its location, area, size, dimensions and elevation. Without limitation, if the area of the Lot on the Plan is not more than 5% different to the total area of the Lot as shown on this Identification Plan, the Variation is deemed to be a Permitted Variation and the Buyer cannot Object."

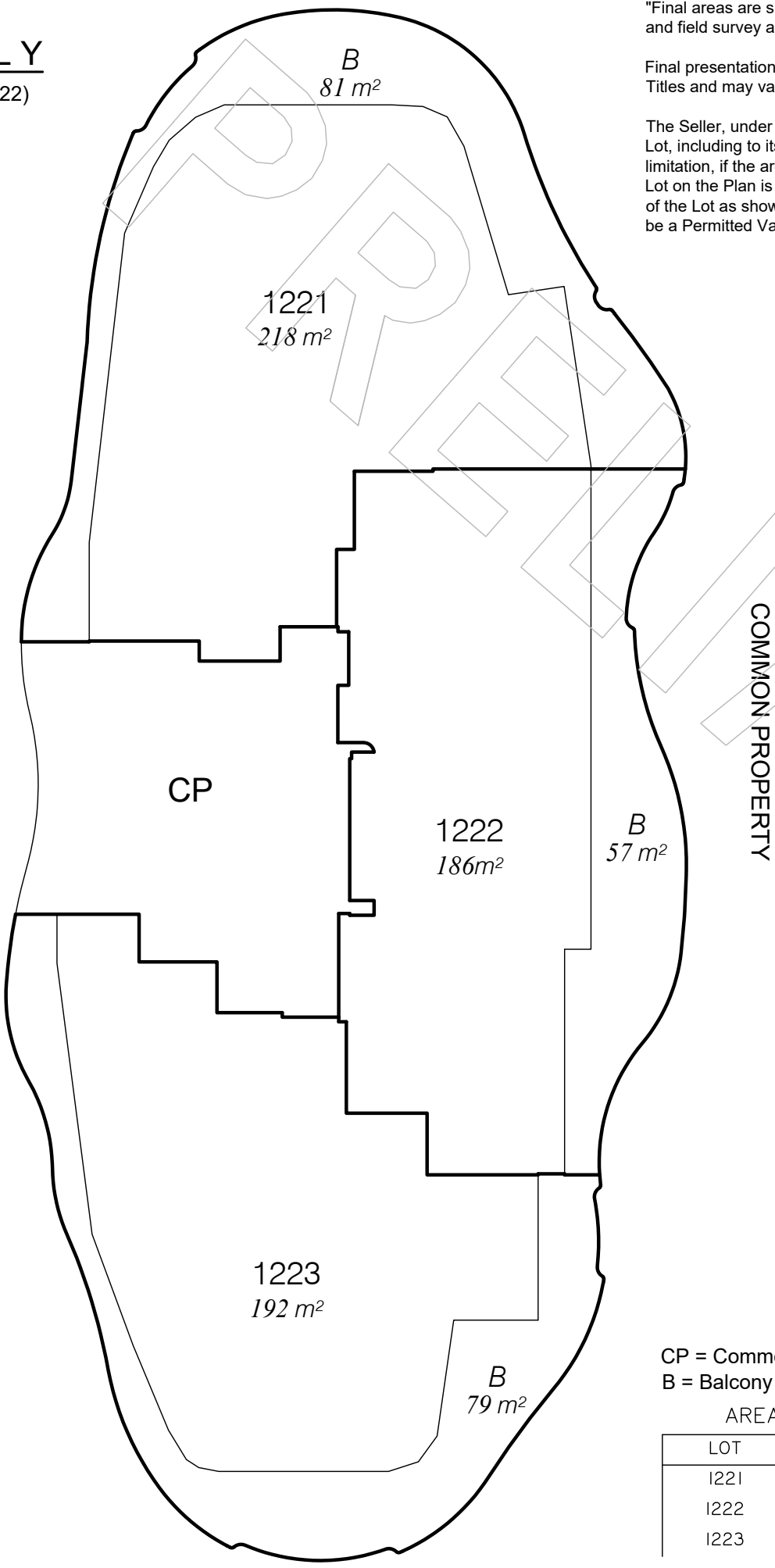

CP = Common Property  
B = Balcony

AREA TABLE

LOT	TOTAL AREA
1221	299m <sup>2</sup>
1222	243m <sup>2</sup>
1223	271m <sup>2</sup>

**LEVEL Y**  
(LEVEL 22)

0m  
10m  
20m  
30m  
50m  
100m  
150m

SCALE 1:200

Insert  
Plan  
Number

SP322426

State copyright reserved



**LEVEL AB**  
(LEVEL 25)

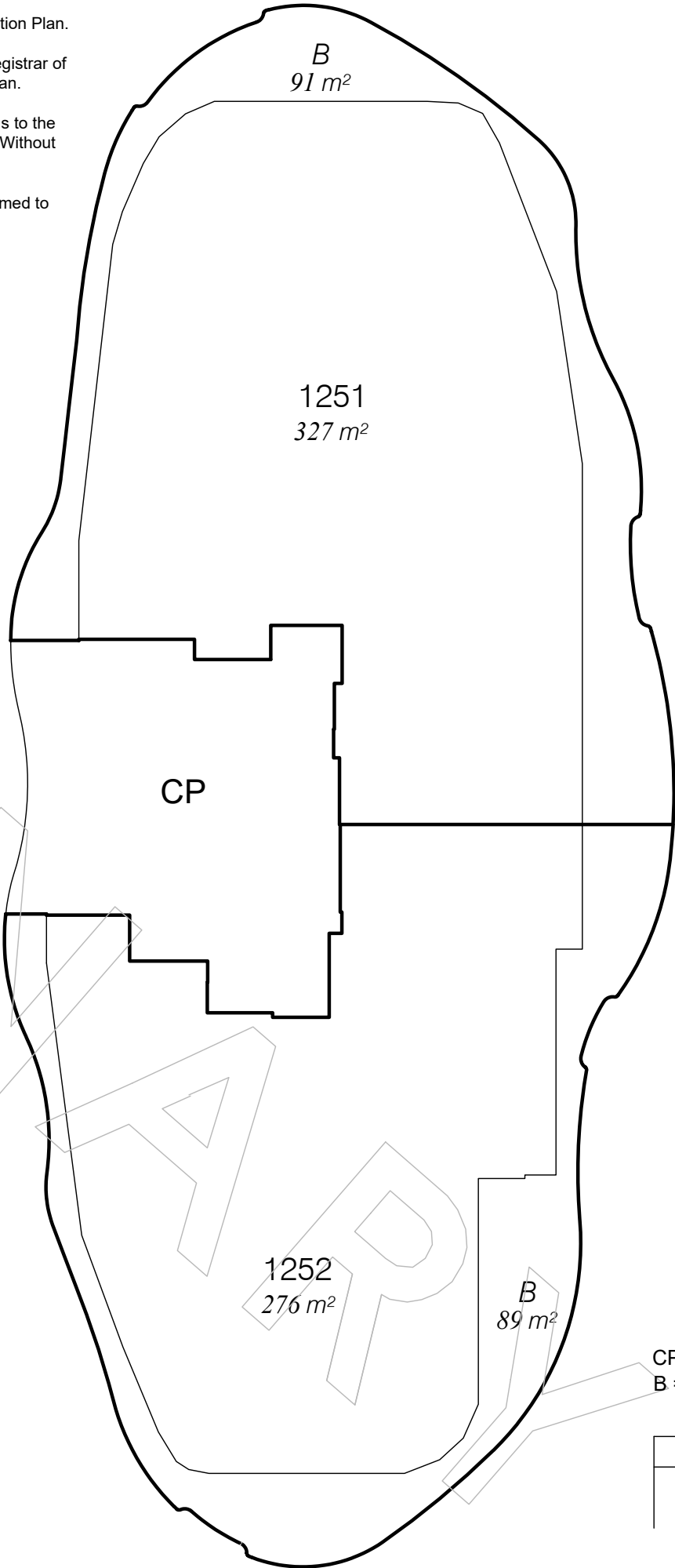

CP = Common Property  
B = Balcony

AREA TABLE

LOT	TOTAL AREA
1251	418m <sup>2</sup>
1252	365m <sup>2</sup>

"Final areas are subject to design changes, Council approval and field survey and may differ from those shown on this Identification Plan.  
Final presentation of areas will comply with requirements of the Registrar of Titles and may vary from the format shown on this Identification Plan.

The Seller, under the Contract Terms, is entitled to make Variations to the Lot, including to its location, area, size, dimensions and elevation. Without limitation, if the area of the Lot on the Plan is not more than 5% different to the total area of the Lot as shown on this Identification Plan, the Variation is deemed to be a Permitted Variation and the Buyer cannot Object."

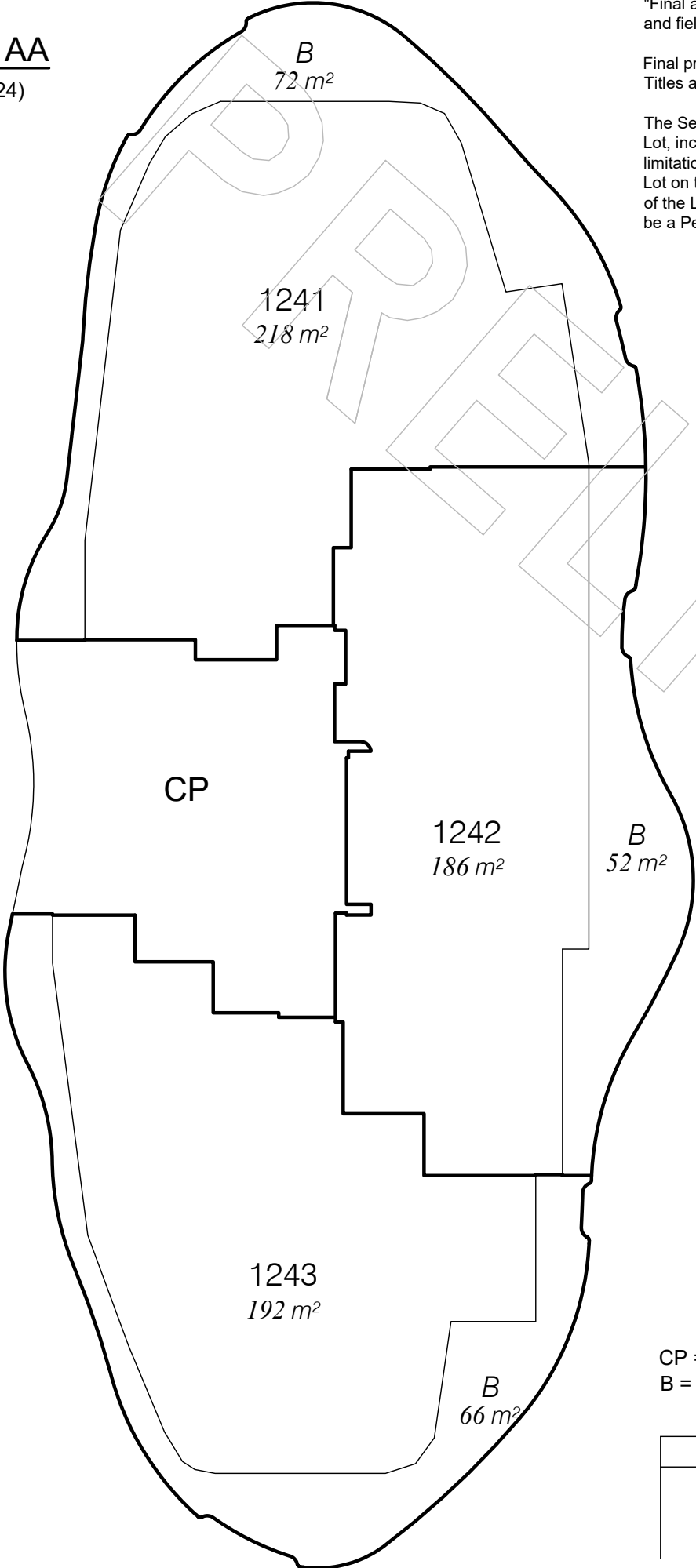

CP = Common Property  
B = Balcony

AREA TABLE

LOT	TOTAL AREA
1241	290m <sup>2</sup>
1242	238m <sup>2</sup>
1243	258m <sup>2</sup>

**LEVEL AA**  
(LEVEL 24)

0m  
10m  
20m  
30m  
50m  
100m  
150m

SCALE 1:200

Insert  
Plan  
Number  
**SP322426**

State copyright reserved

**LEVEL AD**  
(ROOF)

COMMON PROPERTY

COMMON PROPERTY

"Final areas are subject to design changes, Council approval and field survey and may differ from those shown on this Identification Plan.

Final presentation of areas will comply with requirements of the Registrar of Titles and may vary from the format shown on this Identification Plan.

The Seller, under the Contract Terms, is entitled to make Variations to the Lot, including to its location, area, size, dimensions and elevation. Without limitation, if the area of the Lot on the Plan is not more than 5% different to the total area of the Lot as shown on this Identification Plan, the Variation is deemed to be a Permitted Variation and the Buyer cannot Object."

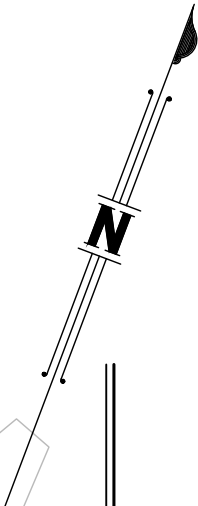

**LEVEL AC**  
(LOWER ROOF)

COMMON PROPERTY

COMMON PROPERTY

0m 10m 20m 30m 50m 100m 150m

SCALE 1:200

State copyright reserved

Insert  
Plan  
Number  
**SP322426**

"Final areas are subject to design changes, Council approval and field survey and may differ from those shown on this Identification Plan.

Final presentation of areas will comply with requirements of the Registrar of Titles and may vary from the format shown on this Identification Plan.

The Seller, under the Contract Terms, is entitled to make Variations to the Lot, including to its location, area, size, dimensions and elevation. Without limitation, if the area of the Lot on the Plan is not more than 5% different to the total area of the Lot as shown on this Identification Plan, the Variation is deemed to be a Permitted Variation and the Buyer cannot Object."

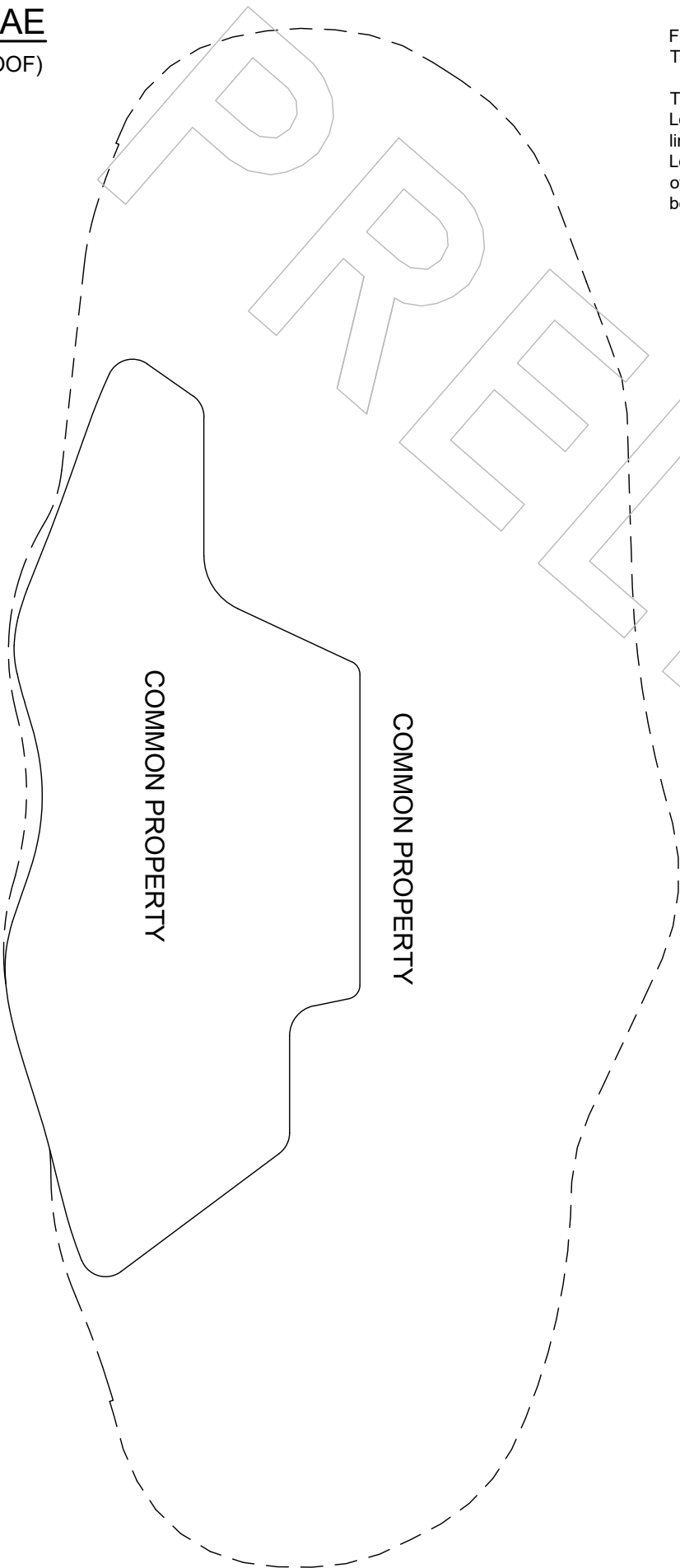
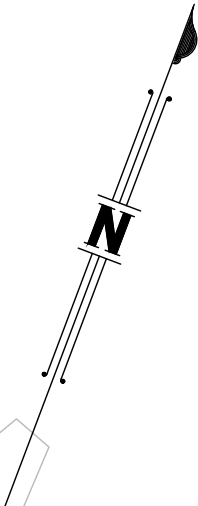

**LEVEL AE**  
(UPPER ROOF)

☐ ☐ = Level Above/Below

SCALE 1:200

0m 10m 20m 30m 50m 100m 150m

State copyright reserved

Insert  
Plan  
Number  
**SP322426**

"Final areas are subject to design changes, Council approval and field survey and may differ from those shown on this Identification Plan.

Final presentation of areas will comply with requirements of the Registrar of Titles and may vary from the format shown on this Identification Plan.

The Seller, under the Contract Terms, is entitled to make Variations to the Lot, including to its location, area, size, dimensions and elevation. Without limitation, if the area of the Lot on the Plan is not more than 5% different to the total area of the Lot as shown on this Identification Plan, the Variation is deemed to be a Permitted Variation and the Buyer cannot Object."

LATERAL ASPECT VIEW

Not to Scale  
(As viewed from the east)

